



LG
Life's Good

WASHING MACHINE

SERVICE MANUAL

▲ CAUTION

READ THIS MANUAL CAREFULLY TO DIAGNOSE
PROBLEMS CORRECTLY BEFORE SERVICING THE UNIT.

MODEL : WD205C*

Any reproduction, duplication, distribution (including by way of email, facsimile or other electronic means), publication, modification, copying or transmission of this Service Manual is **STRICTLY PROHIBITED** unless you have obtained the prior written consent of the LG Electronics entity from which you received this Service Manual. The material covered by this prohibition includes, without limitation, any text, graphics or logos in this Service Manual.

SAFETY PRECAUTION!

IMPORTANT SAFETY NOTICE!

This service information is intended for individuals possessing adequate backgrounds of electrical, electronic, and mechanical experience. Any attempt to repair this appliance may result in personal injury or property damage. The manufacturer or seller can not be responsible for the interpretation of this information, nor can it assume any liability in connection with its use.

⚠ WARNING: To reduce the risk of fire, electric shock, or personal injury when using this appliance, follow basic precautions, including the following:

- **Wear gloves when working.**
Failure to do this can result in serious injury.
- **The appliance is heavy. Two or more people is required when moving the appliance.**
There is a risk of serious back injury or other injuries.
- **Certain internal parts are intentionally not grounded and may present a risk of electric shock only during servicing. Service personnel - Do not contact the following parts while the appliance is energized: Pump bracket, rotor, and heater.**
- **Disconnect this appliance from the power supply before servicing. Turning the controls to the off position does not disconnect this appliance from the power supply.**
Failure to do this can result in shock.
- **Reconnect all grounded devices after servicing.**
Failure to do this can result in shock.

To reduce the risk of fire, electric shock, or personal injury when using this appliance, follow basic precautions, including the following.

CONTENTS

1. SPECIFICATIONS.....	3
2. FEATURES AND BENEFITS.....	4
3. HOW TO USE	5
4. WIRING DIAGRAM	6
5. MAIN PCB PICTURE	8
5-1. DISASSEMBLY INSTRUCTION	8
6. HOW TO USE SVC TEST MODE	19
7. ERROR CODES.....	20
8. EXPLODED VIEW.....	22
8-1. Exploded View Of Outer Case Assembly	22
8-2. Exploded View Of Outer Tub Assembly	24

1. SPECIFICATIONS

Model	WD205C*	
Electrical	120VAC@60Hz.	
Inner Tub	Stainless	
Finish	W : Blue White	V : Stainless Silver(VCM)
Door lid	Glass Lid.	
Inlet Water Pressure	20~120 PSI (138~827 kPa)	
Rating of Fuse	120V/60Hz	
Spin Speed	700RPM (Max)	
Weight	100lb (47.4kg)	
Cycles	Normal, Intimates, Hand Wash, Active Wear, Rinse + Spin, Tub Clean	
Time Delay	No	
Lid Interlock Switch	Magnet Sensor	
Control Lock	Yes	
Softener Dispenser	No	
Detergent Dispenser	No	
Bleach Inlet	No	
Auto Power Off	Yes	
Smart Rinse™ with Jet Spray	No	
Heater	No	

2. FEATURES AND BENEFITS

KEY PARTS AND COMPONENTS

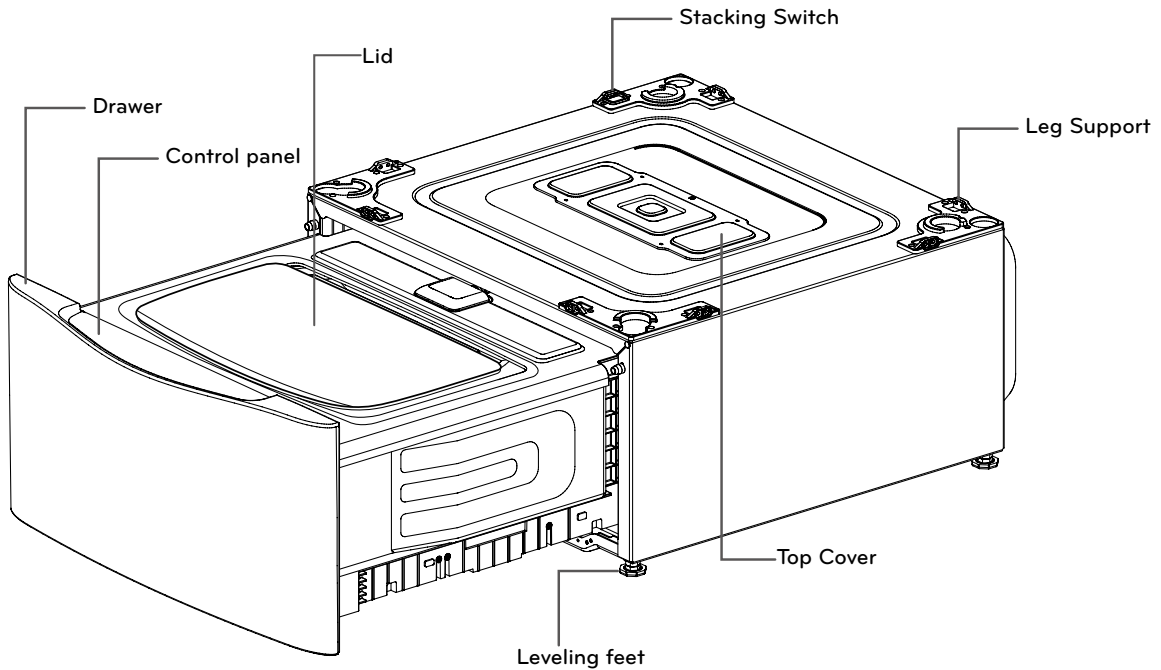

A INVERTER DIRECT DRIVE MOTOR

The inverter motor, which is directly connected to the tub, produces less noise and vibration while offering outstanding durability and a long lifespan.

B COMPACT CAPACITY & NEVERUST™ STAINLESS STEEL TUB

The efficient design provides capacity in a compact space.

C FRONT TOUCH PANEL

The simple LED display shows cycle options, setting, cycle status and estimated time remaining. The touch buttons offer more convenience and a premium design aesthetic.

D SMART DIAGNOSIS™

If you ever experience an issue with your LG washer, you don't have to worry.

The SmartDiagnosis™ feature helps the service center diagnose problems over the phone, or with a simple app on your smart phone, helping you minimize costly, inconvenient service calls.

E REMOTE CONTROL RCW1

Don't want to bend down to reach the controls? Set cycles with the touch of a button on the optional remote control (available online or through an LG retailer).

INCLUDED ACCESSORY					REQUIRED ACCESSORY
2 Inlet Hoses-Short	2 Inlet Hose Y-Connectors	Drain Hose Y-Connector	Drain Hose	Non-Skid Pads	INCLUDED ACCESSORY
Wrench	2 Tie Straps	2 Wire clamps and 1 Band clamp	Screws	Detergent Dispenser	Remote Control

NOTE: Contact LG Customer Service at 1-800-243-0000 (1-888-542-2623 in Canada) if any accessories are missing or to purchase accessories.

3. HOW TO USE

CONTROL PANEL FEATURES

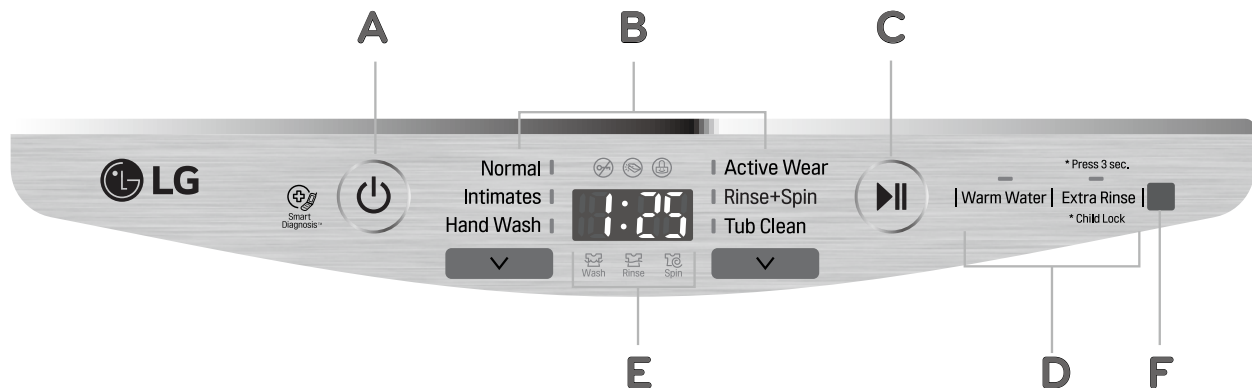

A POWER (ON/OFF) BUTTON

Press to turn the washer ON. Press again to turn the washer OFF. Pressing the POWER button during a cycle will cancel that cycle and any load settings will be lost. The drawer will unlock after a brief pause.

NOTE:

- If there is any water remaining in the tub after the washer shuts off, it will drain following 4-minutes delay. The washer can be restarted any time before the drain begins. However, once the water begins to drain, all functions will be suspended until the water has been completely drained and the washer shuts off.
- When the Power button is pressed, the Normal cycle is selected by default. To modify the default options or choose another cycle, press the cycle selector (v) button to illuminate the display.

B CYCLE SELECTOR BUTTON

Press this button to select the desired cycle. Once the desired cycle has been selected, the standard presets will appear in the display. These settings can be adjusted using the cycle setting buttons any time before starting the cycle.

NOTE: To protect your clothing, not all settings are available on all cycle selections.

C START/PAUSE BUTTON

Press this button to start the selected cycle. If the washer is running, use this button to pause the cycle without losing the current settings.

NOTE: If you do not press the START/PAUSE button within 4 minutes of selecting a cycle, the washer automatically turns OFF and all cycle settings are lost. Any water remaining in the tub will be drained.

D OPTION BUTTONS

Use these buttons to adjust the settings for the selected cycle. The setting lights above the buttons illuminate to show the current selection.

E TIME AND STATUS DISPLAY

The display shows the cycle status and estimated time remaining.

F REMOTE CONTROL SENSOR

Use the remote to set the controls without bending down to reach the control panel.

4. WIRING DIAGRAM

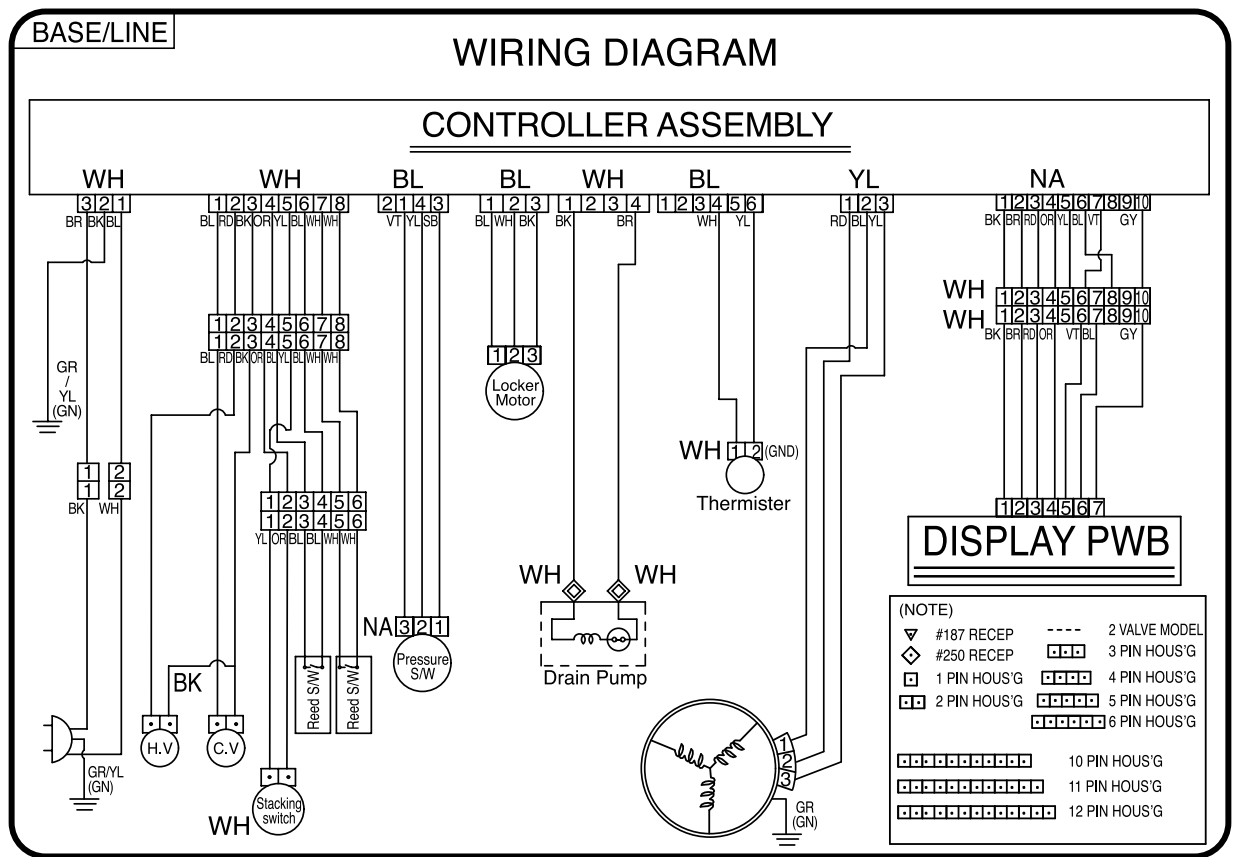

5. MAIN PCB PICTURE

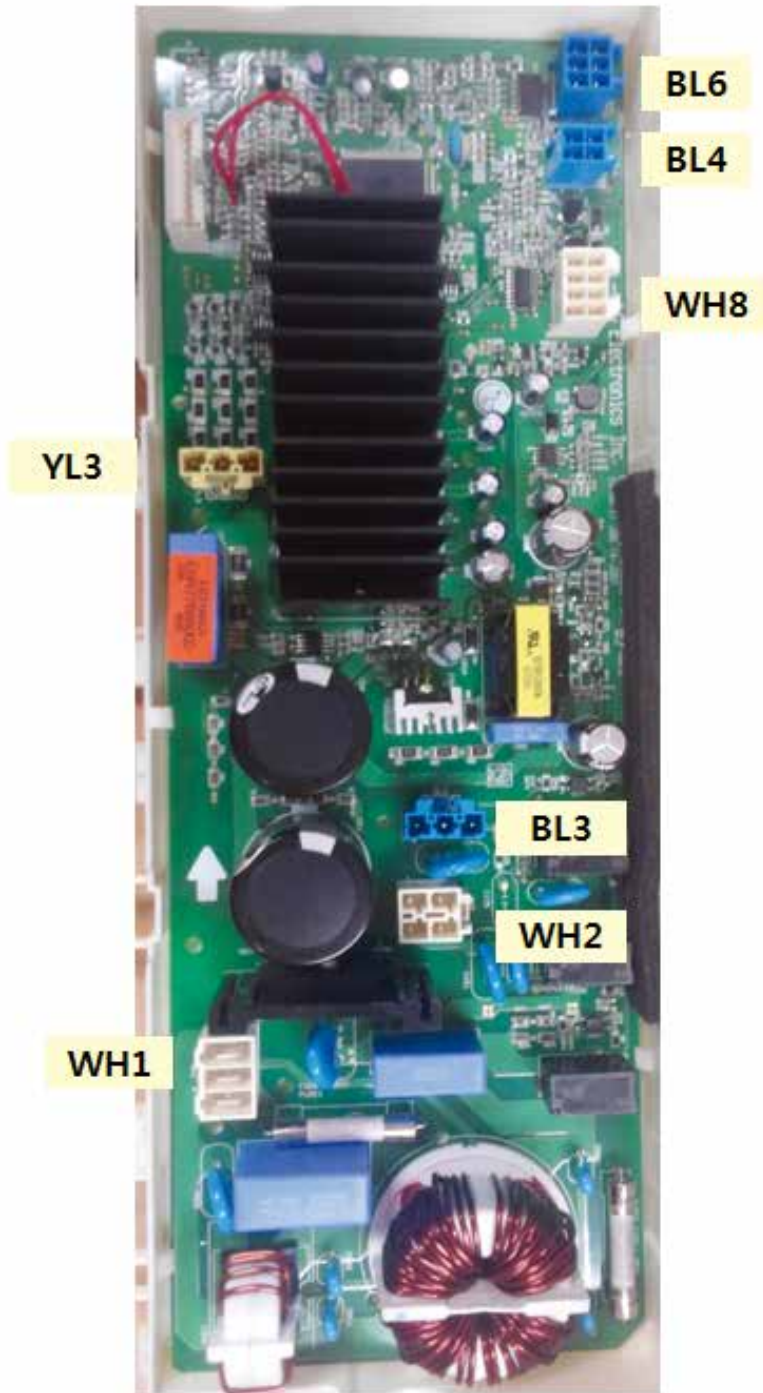

5. SERVICE INFORMATION

5-1. DISASSEMBLY INSTRUCTION

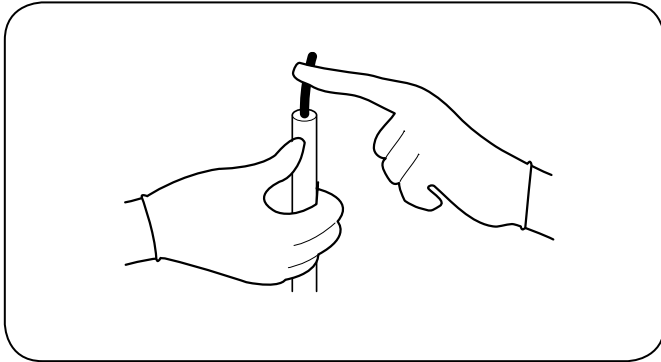

- ▶ Be sure to unplug the power to repair and replace electric parts.

ESD (ElectroStatic Discharge) WARNING

Be sure to follow proper ESD and grounding precautions for diagnosis and repair. If this is not possible, touch the ground wire on a regular basis to remove any static charge built up on your person.



- ① Release all screw in the red circle

- ② Pull out display pcb connector and release the hook.

- ③ Release all screw in the red circle (approx. 13 screws)

1) How to change the smart hinge

- ① Remove the left and right Hinge cover to put a flat-blade screwdriver into the gap



- ② Remove the screw in the red circle

2) How to change the Latch

- ① Remove the screw cap to put a flat-blade screwdriver into the gap



- ② Remove the screw in the red circle.

3) How to change the rear cover, the power cord, and/or the main controller

① Release all screws on the rear cover (approx. 14 screws)

② Pull out 2 connectors and release the power cord

③ Pull out inlet valve connectors and release inlet valves

④ Release 3 screws on the cover of main controller and pull out the cover

⑤ Release all connectors on the main controller

⑥ Release the wire connected on the BP sensor

⑦ Release 4 screws on the main controller and pull out the main controller



4) How to release the drawer assembly

① Release the rear cover totally from the cabinet



② Release 1 screw and 1 connector on the rear cover



③ Open the drawer and release 4 screws securing the sliders and the drawer on the both sides

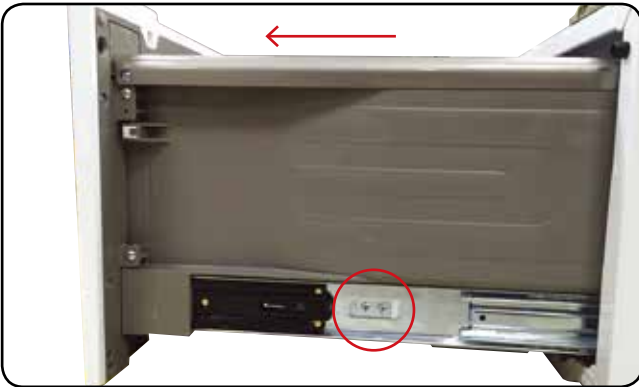

④ Pull out the drawer entirely from the cabinet



5) How to change the damper assembly

- ① Release the small cover on the drawer after pulling out the drawer



- ② Release 7 screws and 1 clamp, and pull out the cover of drawer



- ③ Release each damper being kept the tub assembly up slightly

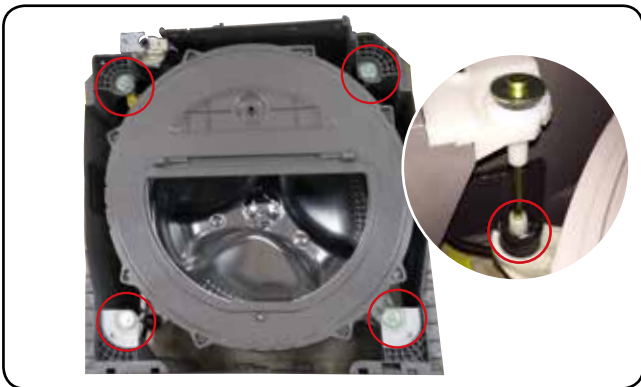

- ④ Do not break the damper assembly down more.
Change the damper assembly as a whole.

Location	P/No.	PIVOT(Color)
Ⓐ, Ⓑ, Ⓒ, Ⓓ	K100	NATURAL

6) How to change the motor assembly

① Pull out the drawer entirely.



② In order to check the motor assembly, turn the drawer to be the side up. Be sure the drawer keeping on the securing carpet to be protected from the damage.



③ Release the rotor bolt using the dedicated tool.
▶ Use the socket wrench or the open wrench (M18).
* Bolt torque when reassemble: 450~600kgf-cm²

- Warning
When reassemble, you have to push the rotor grasping only outside the rotor. Do not grasp both inside and outside of the rotor together.



④ Pull out 3 pin connector and release the motor stator.



-
- ⑤ In order to pull out the motor, turn the drawer to be the side up. And release stator and 6 Bolts.

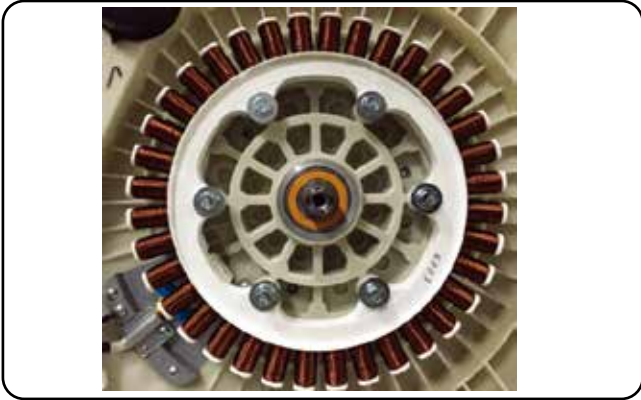

- ⑥ Release 5 Screw and Pull out Harness

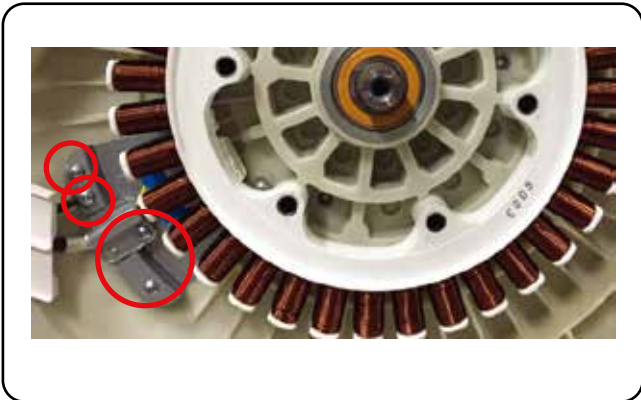

7) How to pull out the drain pump

① Drain the whole remaining water out using extra drain hose on the left-side of drawer.

② Pull out the drawer entirely.

③ Turn the drawer to be the side up. Be sure the drawer keeping on the securing carpet to be protected from the damage.

④ Release the bellows connected on the outer tub.

⑤ Turn the drawer to be normal position and release 2 connectors on the pump case.

⑥ Release 2 bolts from pump housing securing on the drawer.

⑦ Release 3 hoses from pump housing.

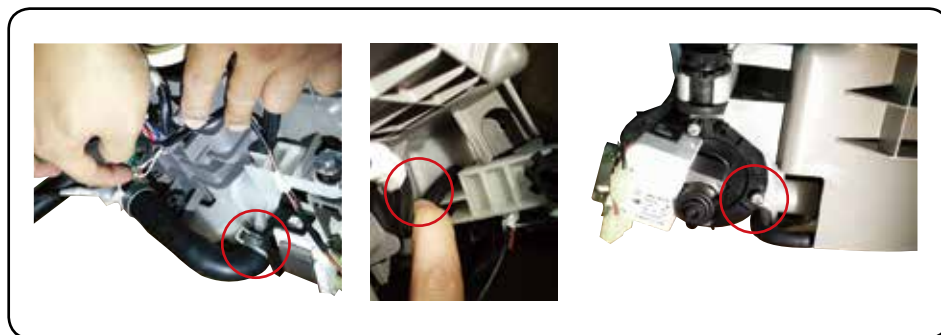
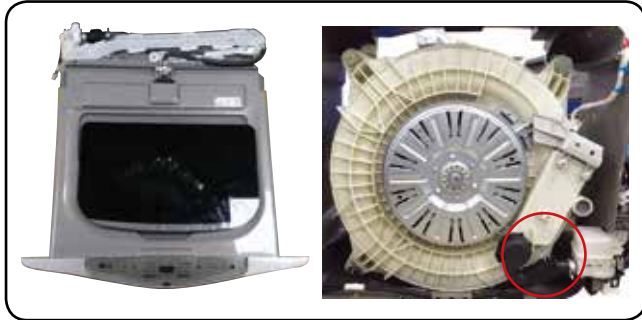

8) How to pull out thermistor

- ① Drain the whole remaining water out using extra drain hose on the left-side of drawer.
- ② Pull out the drawer entirely.
- ③ In order to check the motor assembly, turn the drawer to be the side up. Be sure the drawer keeping on the securing carpet to be protected from the damage.
- ④ Lying Washing machine, and release 3 screws
- ⑤ Release 2 screw from the thermistor.
- ⑥ Pull out the thermistor entirely



9) How to pull out the pipe assembly

① Drain the whole remaining water out using extra drain hose on the left-side of drawer.

② Pull out the drawer entirely.

③ Release the small cover on the drawer, 3 screws and the clamp.

④ Release 4 clamps connected on the pipe assembly and 2 pins.

⑤ Release the check valve from the end of pipe assembly.

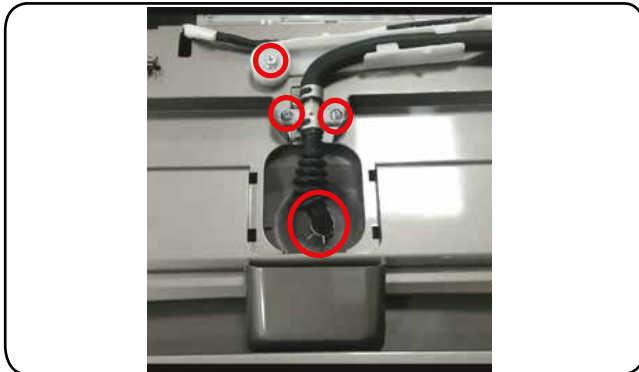

6. HOW TO USE SVC TEST MODE

1. Warnings



- Be sure that the AC power cord is pulled out from wall outlet.
- Put on gloves to protect from electric shock when disassemble the product.
- Deliver and keep the controller within the ESD protection bag.

2. SVC test mode

- Starting SVC test mode: After power on, press Left Course key and Extra Rinse key at the same time within 1 second.
- Press Start/Pause key to go next step.
- You can check the contents of below table at each step.

Step	Mode	Motion	Display	Remark
t1	Main Version check	All LEDs are turned on	Main program version Model option character	Able to check tE error. When Lid is open, Lid open Picto is blinking.
t2	Display Version check and Button check	-	Display program version	
t3	Water Valve Check	-	-	Valve is being on till 23.3 kHz. Valve is automatically turned off by 23.3 kHz to prevent overflow.
		A	Cold valve is on	
		B	Hot valve is on	
t4	Heater Check	Heater On		-
t5	Pressure Switch Check Alpha Check	If water frequency is less than 25.0 kHz, Alpha motion is started automatically. Drain pump is also being on. If water frequency is greater than or equal to 25.0 kHz, 888 error is displayed and the alarm tone sounds. Alpha motion is started when press Start/Pause key.	RPM of Alpha motion Error code(888) when the water frequency is greater than or equal to 25.0 kHz	RPM: 220 On time: 16 seconds Pump on
t6	Drain Check	On the water frequency being reached at 25.0 kHz, the drain pump is being on for 50 seconds. After then, go to step t7 automatically.		Pump on
t7	Load sensing Check	Locking the drawer Load sensing Unlocking the drawer	The value of load being sensed Err is displayed when the load sensing is not completed.	Pump on
t8	Agitate Check	Unlocking the drawer Change pulsator motion Agitating the pulsator	The value of load being sensed Err is displayed when the load sensing is not completed.	
t9	Spin Check And dE error check	Locking the drawer Spin clockwise	Spin RPM Less than 500: current RPM Greater than 500: UB value/ Max UB value before 500 RPM / UB value on RS1 / current RPM (at each 2 seconds)	Spin for 180 seconds after reaching max 600 RPM. Quick stop the spin when Stack switch is on. Pump on
t10	OFF	Power OFF	-	-

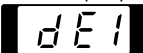
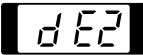
7. ERROR CODES

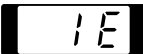
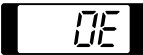
Problem	Possible Cause	Solutions
The display shows:  	Drawer is not closed properly	Close the drawer and press START/PAUSE button to start the cycle. If the drawer is closed and the drawer lock error message is displayed, call for service
The display shows: 	Lid is not closed properly	Open the drawer and make sure the latch area is free of clothing or other obstructions. Close the lid, shut the drawer, and press START/PAUSE to start the cycle. If the lid is closed and the lid error picto is blinked, call for service
Washer fills with water slowly or not at all, or the display shows: 	Water supply faucets are not fully open. Water line hoses are kinked, pinched, or crushed. Water inlet filters are clogged. Water supply pressure to faucet or house is too low. Water supply connected with leak-limiting hoses.	Make sure that the water faucets are fully open. Make sure that the hoses are not kinked or pinched. Be careful when moving the washer during cleaning and maintenance. Clean the inlet filters. See Maintenance in the Care and Cleaning section. Check another faucet in the house to make sure that household water pressure is adequate and flow is not restricted. Disconnect the inlet hose from the washer and run a few gallons of water through the hose to flush the water supply lines. If flow is too low, contact a plumber to have the water lines repaired. Hoses designed to limit leaks can trip falsely and prevent the washer from filling. The use of leak limiting hoses is not recommended.
Washer will not turn on	Power cord is not properly plugged in. House fuse is blown, circuit breaker has tripped, or power outage has occurred.	Make sure that the plug is plugged seruely into a grounded, 3-prong, 120-VAC, 60-Hz. outlet. Reset circuit breaker or replace fuse. Do not increase fuse capacity. If the problem is a circuit overload, have it corrected by a qualified electrician.
Water in the washer drains slowly or not at all, or the display shows: 	Drain hose is kinked, pinched, or clogged Drain discharge is more than 96 " (243.84 cm) above bottom of washer.	Make sure the drain hose is free of clogs, kinks, etc., and is not pinched behind or under the washer. Adjust or repair drain. Maximum drain height is 96 " (243.84 cm).
Washer chimes repeatedly before final rinse	This is not an error. This is an alert to allow the addition of liquid fabric softener before the final rinse..	See Using Fabric Softener, page 16, for instructions on adding liquid fabric softener to the load. To disable or enable the fabric softener alert, press and hold Warm Water and Extra Rinse at the same time for three seconds.

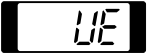
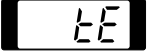
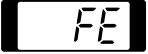
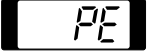
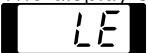
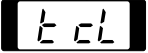
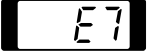
Problem	Possible Cause	Solutions
The display shows: 	If the rebalancing operation (see above) is not successful, this error will be displayed. The load is too small. Heavy articles are mixed with lighter items. The load is out of balance.	The automatic attempt to rebalance the load was not successful. The cycle has been paused to allow the load to be manually adjusted. Small loads may need additional items to be added to allow the washer to balance the loads. The load may have heavy items loaded with lighter items. Always try to wash articles of somewhat similar weight to allow the washer to evenly distribute the weight of the load for spinning. Manually redistribute the load if articles have become tangled preventing the automatic distribution from working properly.
The display shows: 	Control error.	Unplug the power cord and contact your nearest LG service center.
The display shows : 	Water level is too high due to a faulty water valve.	Close the water faucets, unplug the washer, and call for service.
The display shows: 	The water level sensor is not working correctly.	Close the water faucets, unplug the washer, and call for service.
The display shows: 	A motor error has occurred.	Allow the washer to stand for 30 minutes and then restart the cycle. If the LE error code persists, call for service.
The display shows: 	It is time to run the Tub Clean cycle.	Empty the tub, add a diluted solution of 1/4 cup bleach to 1 qt. water to the tub, and select the Tub Clean cycle. To skip the Tub Clean cycle when alerted, press the cycle selector buttons. The message continues to appear for a few more wash cycles and then disappears until the next scheduled tub clean.
The display shows: 	Pedestal washer is being operated without a full-size washer. Stacking switch is not working properly.	The pedestal washer will not operate as a standalone unit. It must be stacked under a full-size LG appliance. The stacking switch will not operate properly if the unit is stacked under a non-LG appliance, or an LG appliance manufactured before 2009.

8. EXPLODED VIEW

8-1. EXPLODED VIEW OF OUTER CASE ASSEMBLY

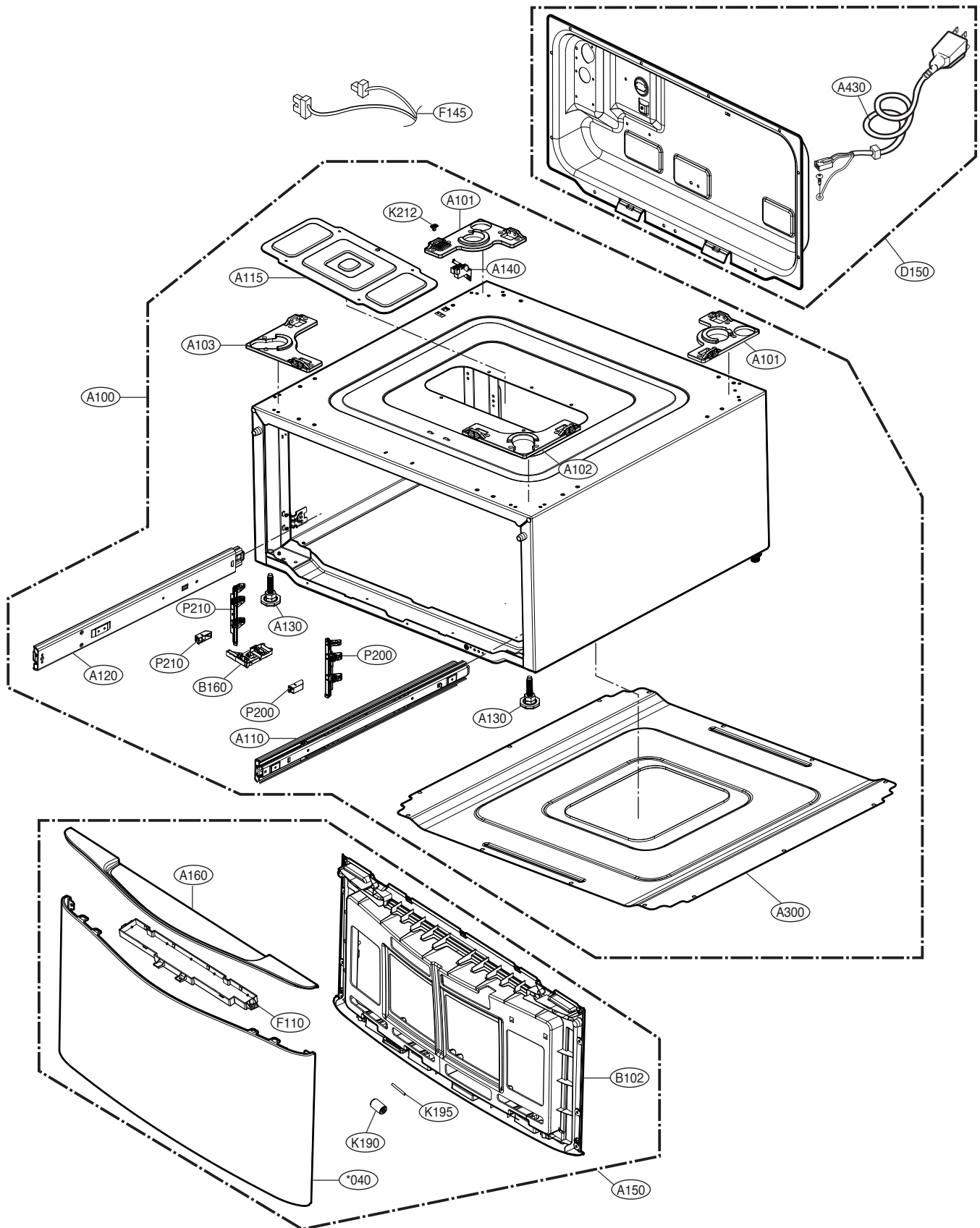

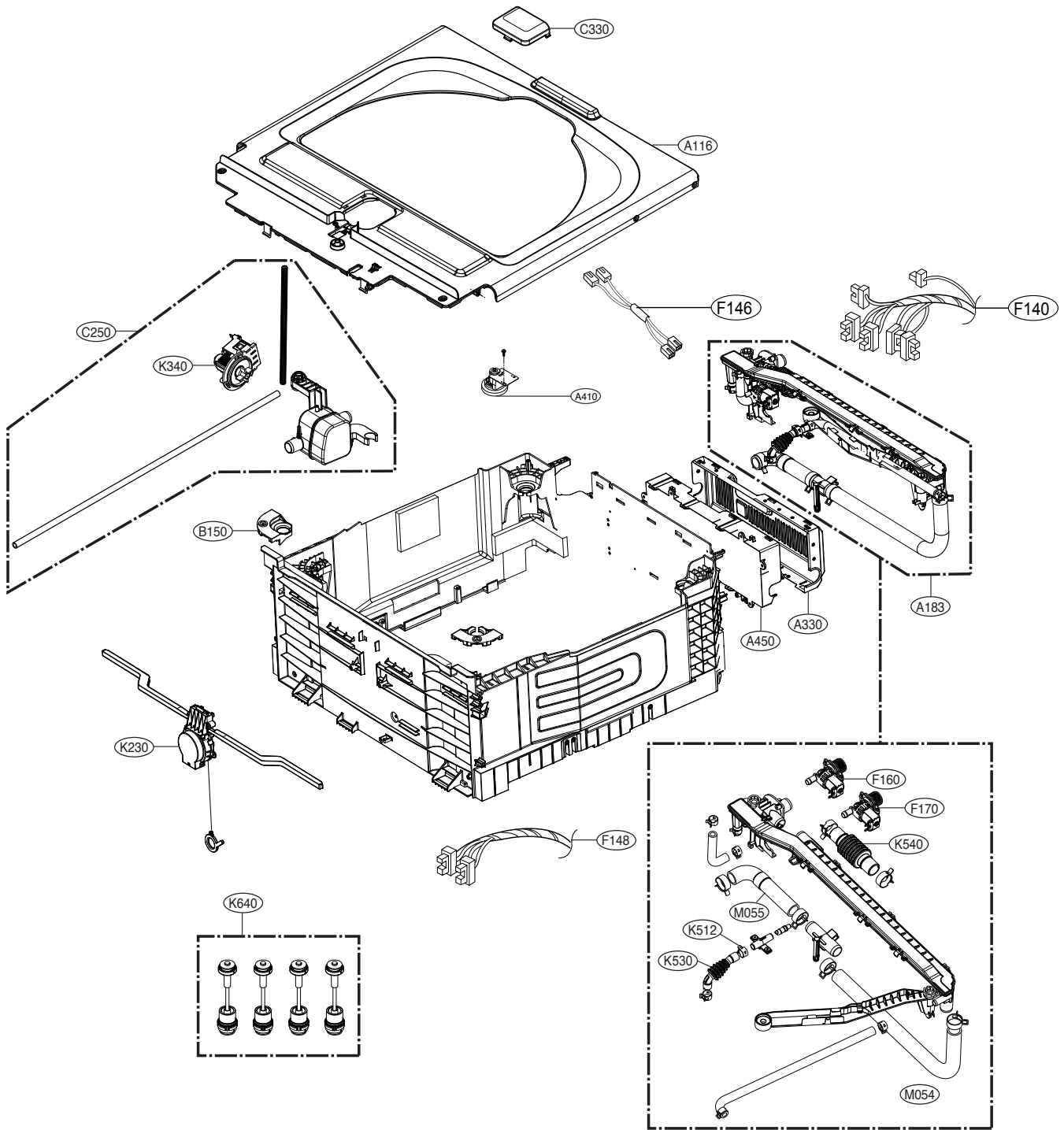

8-2. EXPLODED VIEW OF OF TUB ASSEMBLY

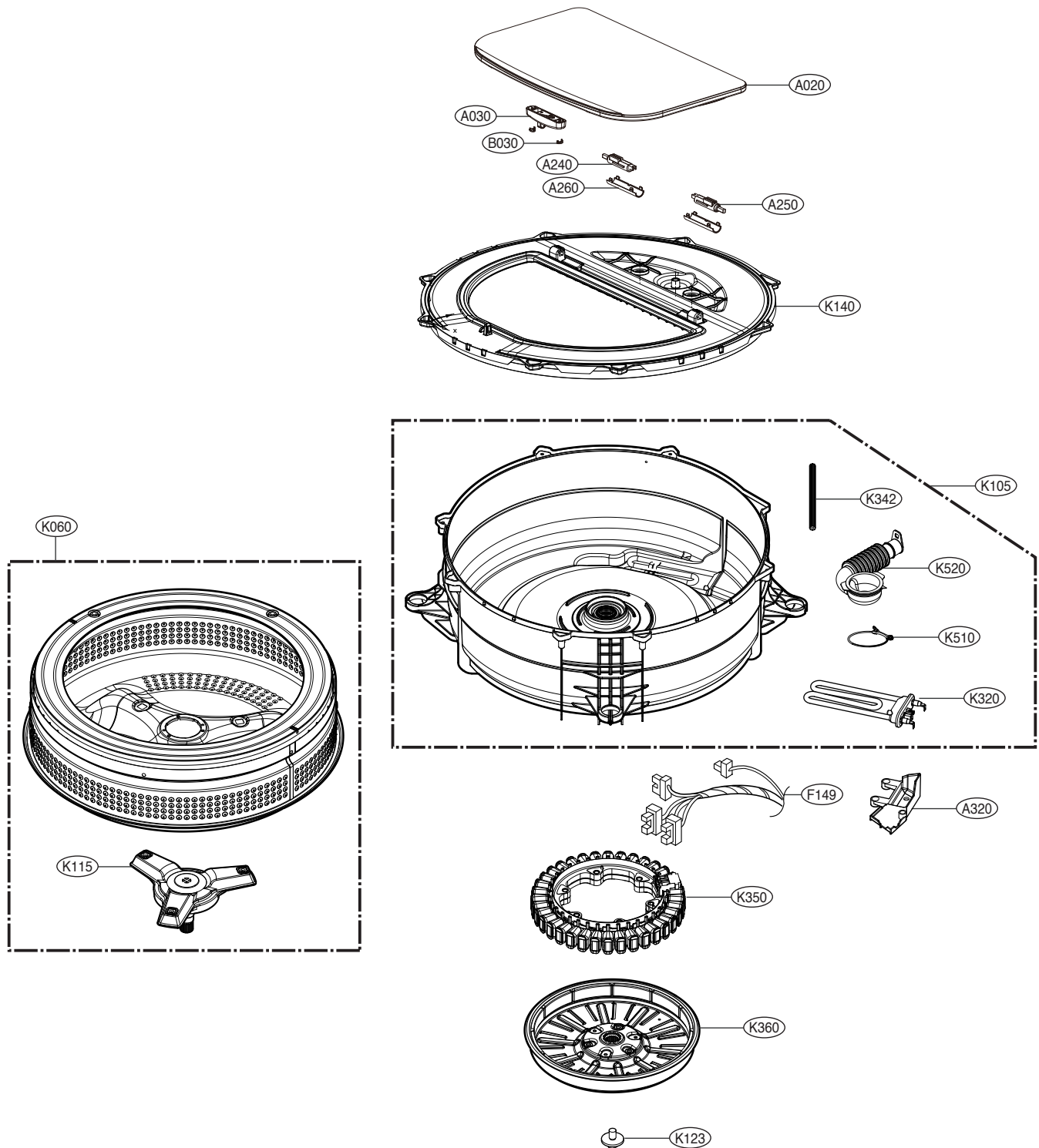

8-3. EXPLODED VIEW OF ACC.

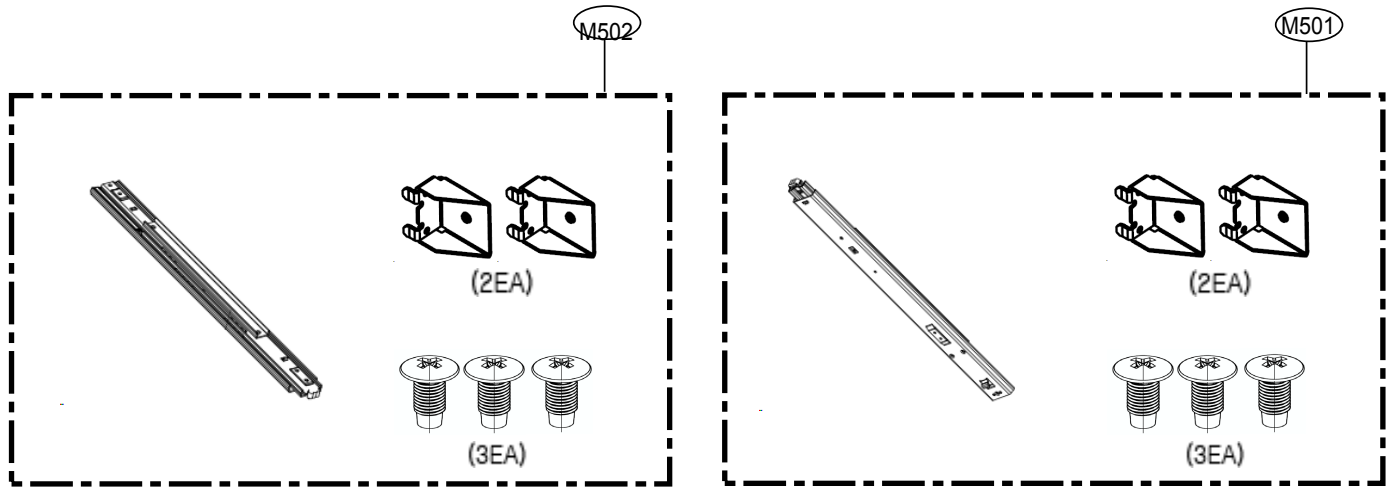



2015.06

MFL68840006