

# SONY®

## Solid-State Memory Camcorder

# PXW-FS5 PXW-FS5K PXW-FS5M2 PXW-FS5M2K

**DISCLAIMER: USE AT OWN RISK.** SONY AND ITS AFFILIATES ARE NOT LIABLE FOR ANY DAMAGE OR INJURY CAUSED TO ANY DIGITAL ELECTRONIC EQUIPMENT, PERSON, OR PROPERTY, WHICH OCCURS DUE TO USE OF THE TOOLS, PARTS, DOCUMENTATION, OR OTHER MATERIALS HEREIN PROVIDED, WHETHER FOR REPAIR, DIAGNOSIS, MAINTENANCE, MODIFICATION, OR OTHERWISE, INCLUDING BUT NOT LIMITED TO: ANY INDIRECT, INCIDENTAL, SPECIAL, OR CONSEQUENTIAL DAMAGES; ANY LOSS OF DATA, PRIVACY OR PROFITS; OR ANY INABILITY TO USE, OR REDUCED FUNCTIONALITY OF, THE DIGITAL ELECTRONIC EQUIPMENT. PLEASE READ ALL INSTRUCTIONS IN THIS MANUAL BEFORE PROCEEDING. PLEASE FOLLOW ALL STEPS IN THE ORDER IN WHICH THEY ARE DESCRIBED. IF YOU DO NOT HAVE ALL TOOLS AND PARTS AVAILABLE TO YOU, OR ARE NOT COMFORTABLE PERFORMING THE REPAIRS DESCRIBED HEREIN, DO NOT PROCEED. FAILURE TO FOLLOW THESE INSTRUCTIONS, OR USE THE PROPER TOOLS AND PARTS, MAY DAMAGE YOUR PRODUCT, LEAD TO PERSONAL INJURY OR CAUSE PROPERTY DAMAGE.

**XDCAM**

**XAVC**

**AVCHD**  
Progressive

**Exmor**  
CMOS Sensor

  
MEMORY STICK



  
HDMI



## SERVICE MANUAL

### 1st Edition

## **⚠ 警告**

このマニュアルは、サービス専用です。

お客様が、このマニュアルに記載された設置や保守、点検、修理などを行うと感電や火災、人身事故につながる可能性があります。

危険をさけるため、サービストレーニングを受けた技術者のみご使用ください。

## **⚠ WARNING**

This manual is intended for qualified service personnel only.

To reduce the risk of electric shock, fire or injury, do not perform any servicing other than that contained in the operating instructions unless you are qualified to do so. Refer all servicing to qualified service personnel.

## **⚠ WARNUNG**

Die Anleitung ist nur für qualifiziertes Fachpersonal bestimmt.

Alle Wartungsarbeiten dürfen nur von qualifiziertem Fachpersonal ausgeführt werden. Um die Gefahr eines elektrischen Schlages, Feuergefahr und Verletzungen zu vermeiden, sind bei Wartungsarbeiten strikt die Angaben in der Anleitung zu befolgen. Andere als die angegeben Wartungsarbeiten dürfen nur von Personen ausgeführt werden, die eine spezielle Befähigung dazu besitzen.

## **⚠ AVERTISSEMENT**

Ce manuel est destiné uniquement aux personnes compétentes en charge de l'entretien. Afin de réduire les risques de décharge électrique, d'incendie ou de blessure n'effectuer que les réparations indiquées dans le mode d'emploi à moins d'être qualifié pour en effectuer d'autres. Pour toute réparation faire appel à une personne compétente uniquement.

**注意**

指定以外の電池に交換すると、破裂する危険があります。  
必ず指定の電池に交換してください。  
使用済みの電池は、国または地域の法令に従って  
処理してください。

**CAUTION**

Danger of explosion if battery is incorrectly replaced.  
Replace only with the same or equivalent type recommended by the manufacturer.  
When you dispose of the battery, you must obey the law in the relative area or country.

**ATTENTION**

Il y a danger d'explosion s'il y a remplacement incorrect de la batterie. Remplacer uniquement avec une batterie du même type ou d'un type équivalent recommandé par le constructeur.  
Lorsque vous mettez la batterie au rebut, vous devez respecter la législation en vigueur dans le pays ou la région où vous vous trouvez.

**VORSICHT**

Explosionsgefahr bei Verwendung falscher Batterien. Batterien nur durch den vom Hersteller empfohlenen oder einen gleichwertigen Typ ersetzen.  
Wenn Sie die Batterie entsorgen, müssen Sie die Gesetze der jeweiligen Region und des jeweiligen Landes befolgen.

**Note:**

Be sure to keep your PC used for service and checking of this unit always updated with the latest version of your anti-virus software. In case a virus affected unit was found during service, contact your Service Headquarters.

**FÖRSIKTIGHET!**

Fara för explosion vid felaktigt placerat batteri.  
Byt endast mot samma eller likvärdig typ av batteri, enligt tillverkarens rekommendationer.  
När du kasserar batteriet ska du följa rådande lagar för regionen eller landet.

**PAS PÅ**

Fare for eksplosion, hvis batteriet ikke udskiftes korrekt.  
Udskift kun med et batteri af samme eller tilsvarende type, som er anbefalet af fabrikanten.  
Når du bortskaffer batteriet, skal du følge lovgivningen i det pågældende område eller land.

**HUOMIO**

Räjähdyksvaara, jos akku vaihdetaan virheellisesti. Vaihda vain samanlaiseen tai vastaavantyyppiseen, valmistajan suosittelemaan akkuun.  
Noudata akun hävittämisesssä oman maasi tai alueesi lakeja.

**FORSIKTIG**

Ekspløsjonsfare hvis feil type batteri settes i.  
Bytt ut kun med samme type eller tilsvarende anbefalt av produsenten.  
Kasser batteriet i henhold til gjeldende avfallsregler.

**注意**

如果更换的电池不正确，就会有爆炸的危险。  
只更换同一类型或制造商推荐的电池型号。  
处理电池时，必须遵守相关地区或国家的法律。

**注意：**

修理時に使用するパソコンは、ウイルス検出ソフトが常にアップデートを行っているパソコンを使用してください。もし、修理を行うセット、もしくはパソコンがウイルスに感染している事が判明した場合は、ソニーグループ内は社内技術相談窓口、特約店様は特約店様専用電話窓口（修理窓口）にご相談ください。

## SAFETY CHECK-OUT

After correcting the original service problem, perform the following safety checks before releasing the set to the customer.

1. Check the area of your repair for unsoldered or poorly-soldered connections. Check the entire board surface for solder splashes and bridges.
2. Check the interboard wiring to ensure that no wires are "pinched" or contact high-wattage resistors.
3. Look for unauthorized replacement parts, particularly transistors, that were installed during a previous repair. Point them out to the customer and recommend their replacement.
4. Look for parts which, through functioning, show obvious signs of deterioration. Point them out to the customer and recommend their replacement.
5. Check the B+ voltage to see it is at the values specified.
6. Flexible Circuit Board Repairing
  - Set the soldering iron tip temperature to 350 °C approximately.
  - Do not touch the soldering iron on the same conductor of the circuit board (within 3 times).
  - Be careful not to apply force on the conductor when soldering or unsoldering.

### UNLEADED SOLDER

This unit uses unleaded solder.

Boards requiring use of unleaded solder are printed with the lead free mark (LF) indicating the solder contains no lead.

**(Caution:** Some printed circuit boards may not come printed with the lead free mark due to their particular size.)





### LEAD FREE MARK

Be careful to the following points to solder or unsolder.

- Set the soldering iron tip temperature to 350 °C approximately. If cannot control temperature, solder/unsolder at high temperature for a short time.
 

**Caution:** The printed pattern (copper foil) may peel away if the heated tip is applied for too long, so be careful!  
Unleaded solder is more viscous (sticky, less prone to flow) than ordinary solder so use caution not to let solder bridges occur such as on IC pins, etc.
- Be sure to control soldering iron tips used for unleaded solder and those for leaded solder so they are managed separately. Mixing unleaded solder and leaded solder will cause detachment phenomenon.

### SAFETY-RELATED COMPONENT WARNING!!

COMPONENTS IDENTIFIED BY MARK  OR DOTTED LINE WITH MARK  ON THE SCHEMATIC DIAGRAMS AND IN THE PARTS LIST ARE CRITICAL TO SAFE OPERATION. REPLACE THESE COMPONENTS WITH SONY PARTS WHOSE PART NUMBERS APPEAR AS SHOWN IN THIS MANUAL OR IN SUPPLEMENTS PUBLISHED BY SONY.

### ATTENTION AU COMPOSANT AYANT RAPPORT À LA SÉCURITÉ!

LES COMPOSANTS IDENTIFIÉS PAR UNE MARQUE  SUR LES DIAGRAMMES SCHÉMATIQUES ET LA LISTE DES PIÈCES SONT CRITIQUES POUR LA SÉCURITÉ DE FONCTIONNEMENT. NE REMPLACER CES COMPOSANTS QUE PAR DES PIÈCES SONY DONT LES NUMÉROS SONT DONNÉS DANS CE MANUEL OU DANS LES SUPPLÉMENTS PUBLIÉS PAR SONY.

**[About the service of this model]**

PXW-FS5K and PXW-FS5M2K are commodity that packed the Solid-State Memory Camcorder and Interchangeable Lenses.

When you repair Interchangeable Lens, refer to the following service manual for the lens model.

Model	Lens
PXW-FS5/ FS5M2	No supplied lens
PXW-FS5K/ FS5M2K	SELP18105G (E PZ 18-105mm F4 G OSS)

## Manual Structure

### Purpose of this manual

This manual describes the information items that premise the service based on the components parts assuming use of system and service engineers.

### Related manuals

Besides this manual, the following manuals are available.

- Operating Guide (Supplied with this unit)
- CD-ROM “Manuals for Solid-State Memory Camcorder” (Supplied with this unit)

# Section 1

## Service Note

### 1-1. Operation Notes

#### 1-1-1. Flexible Board

- Make sure that the conductive side of a flexible board does not have any stain or foreign materials.
- Do not touch the conductive side of flexible boards with bare hands.
- Plug in a flexible board straight, fully into the connector until it reaches the end inside.

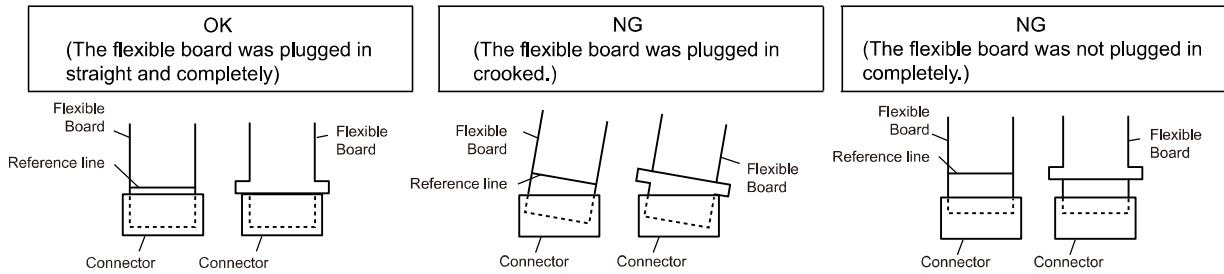

- When opening the connector's holder in direction A, do not open it with excessive force.

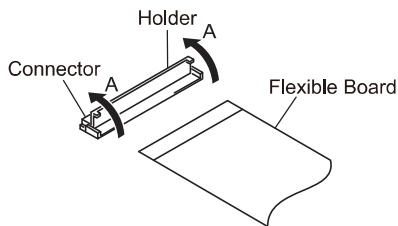

- When closing the connector's holder, press it evenly while pushing a flexible board in direction B.

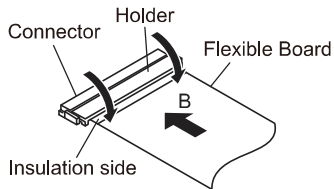

- Make sure that the flat cable and flexible board are not cracked or bent at the contact end.

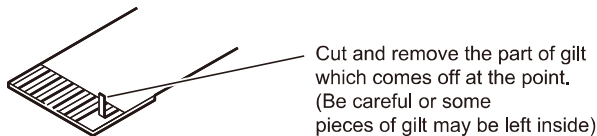

- Do not apply excessive force to the gilded flexible board.

#### 1-1-2. Fine-Wire Coaxial Cable

- The proper way to disconnect a connector is to grab the connector instead of the wires. If you pull on the wires, they might be broken.
- The proper way to connect a connector is to grab the connector instead of the wires. If you push on the wires, they might be broken.

## **1-2. Power Supply during Repairs**

### **1-2-1. AC power adaptor**

Use the AC power adaptor.



## Section 2 Replacement of Main Parts

### 2-1. Identifying Parts

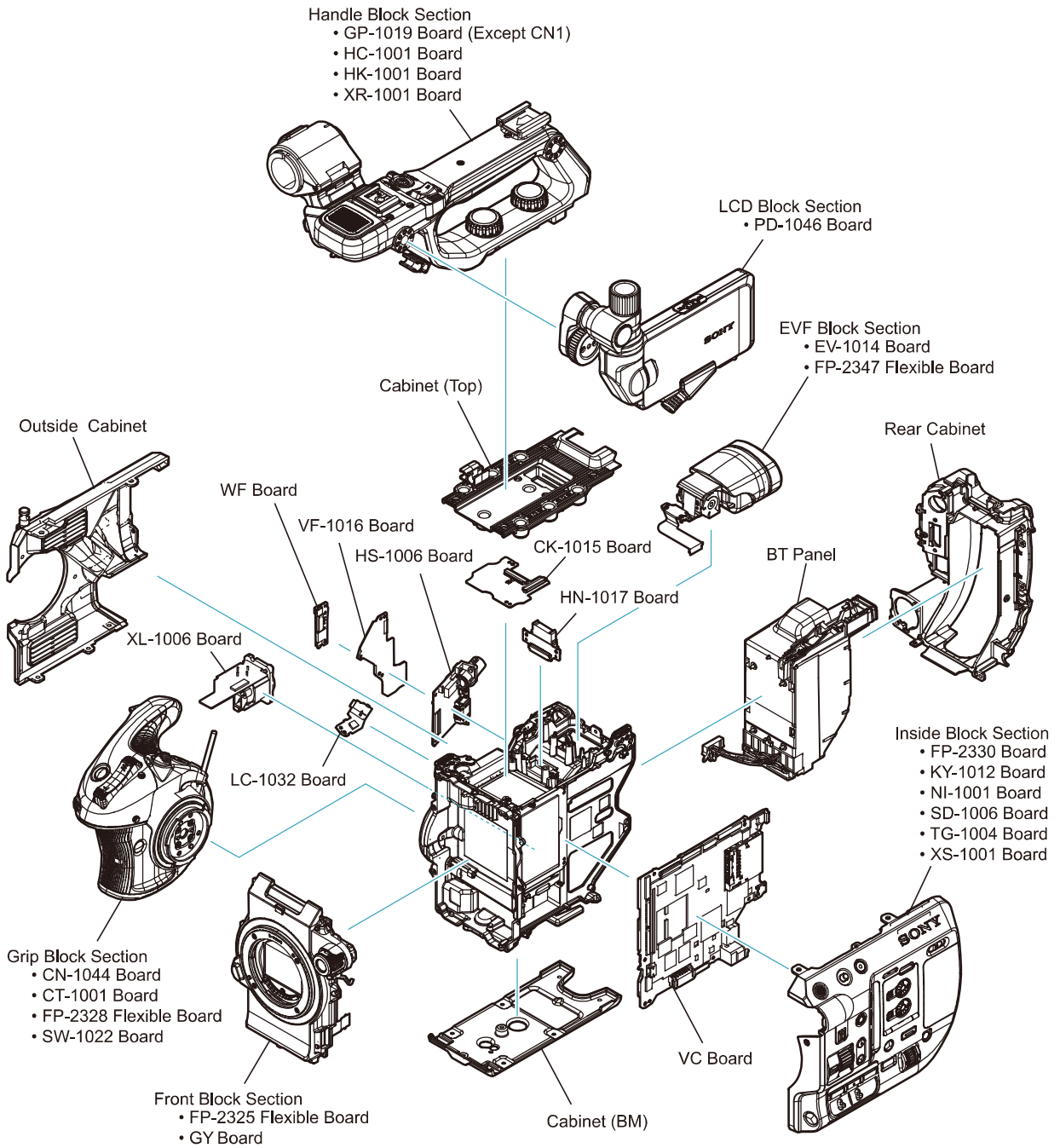

### View Position

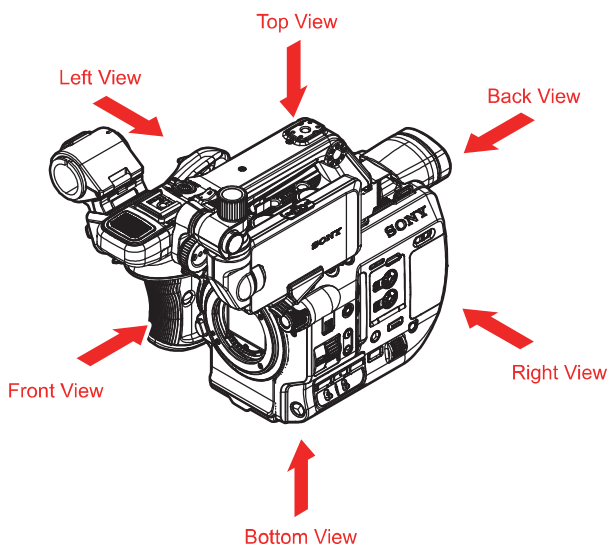

## 2-2. Disassembly

### 2-2-1. Overall Section 1

- Refer to “Overall Section 1” on exploded view for Ref. No.

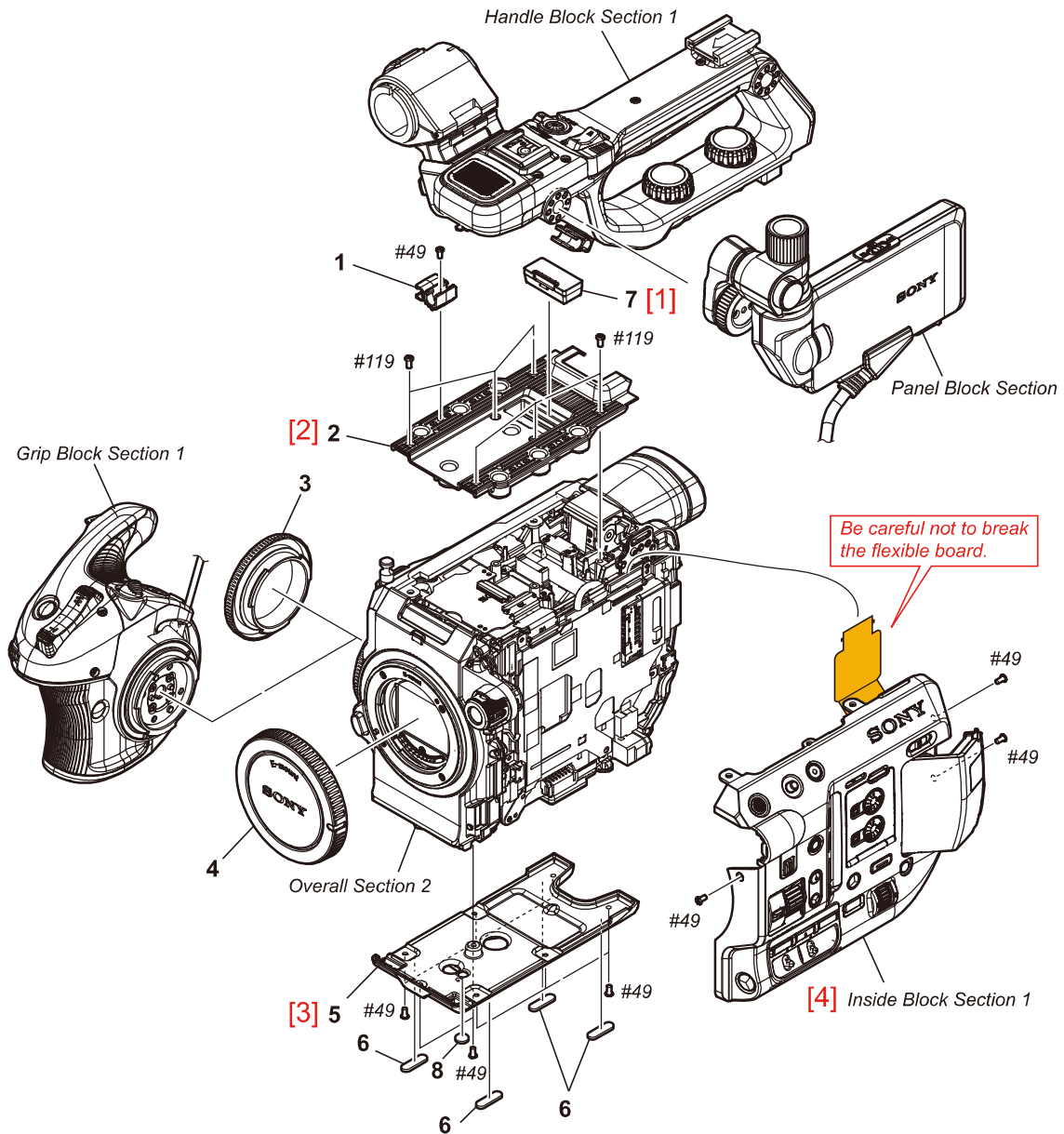

## Disassembly Places

[2] #119 x 6

Top View

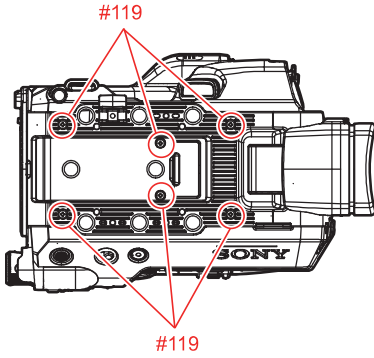

[3] #49 x 8

Bottom View

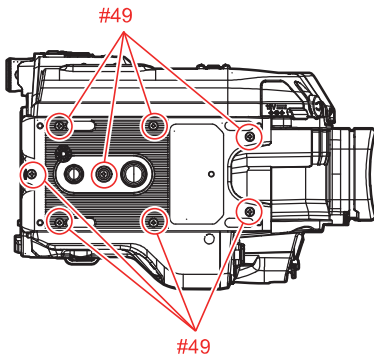

[4] Open the Media Lid → #49 x 2 → #49 x 1

Back View

Front View

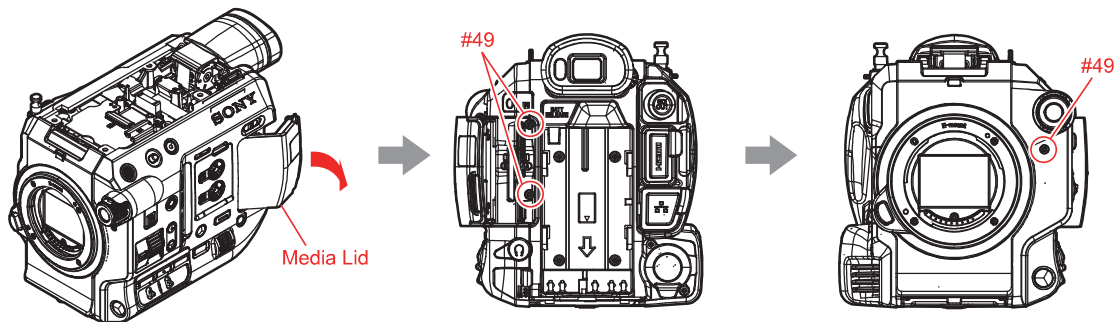

## 2-2-2. Overall Section 2

- Refer to "Overall Section 2" on exploded view for Ref. No.

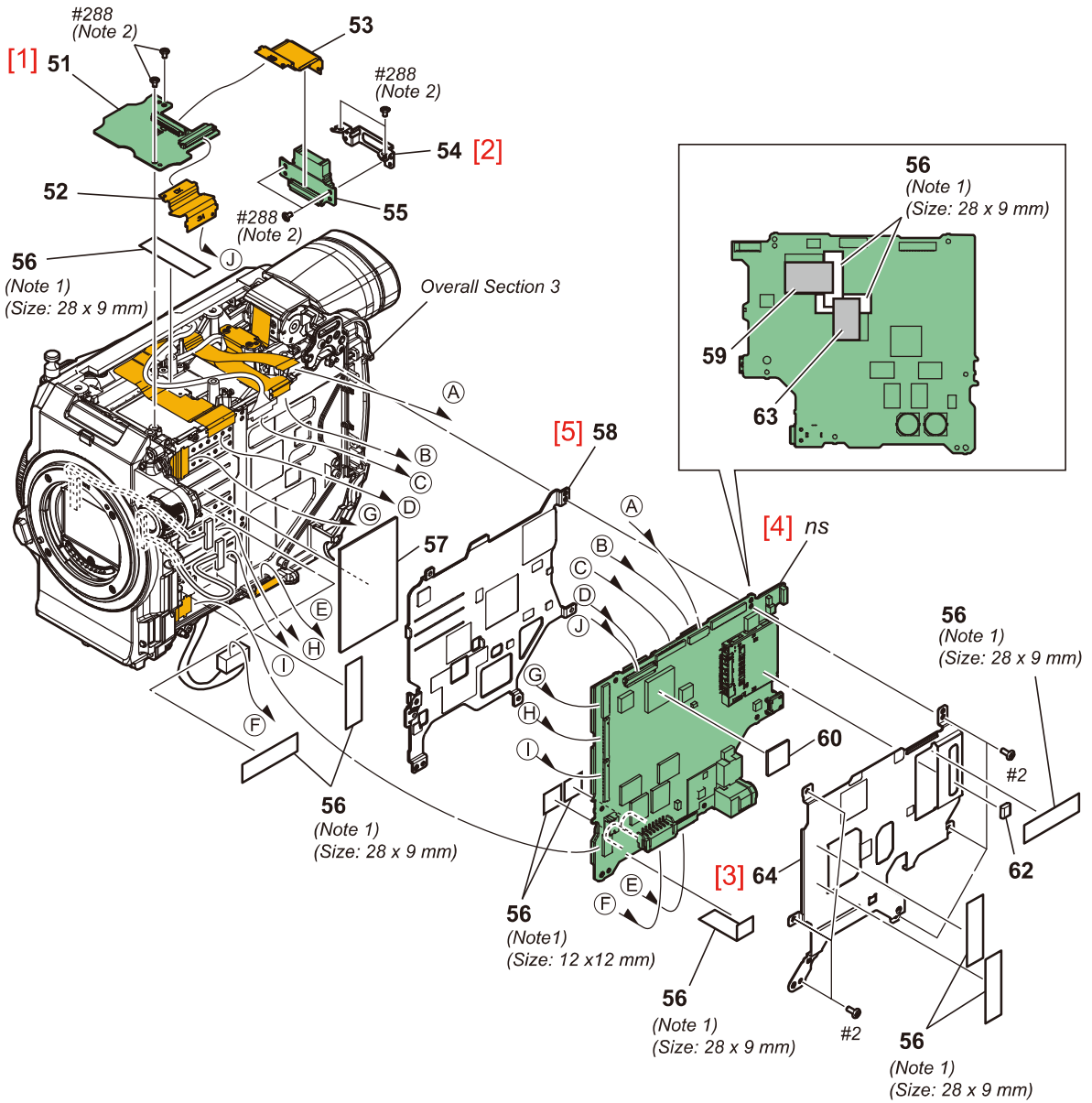

### Note 1

Use this to cut or splice so that it becomes the designated size.

### Note 2

This screw can not be reused. Discard the screw removed once in servicing. Instead, use a new screw.

## Disassembly Places

### [1] #288 x 2

Top View

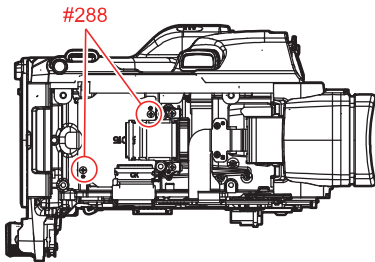

### [2] #288 x 2

Top View

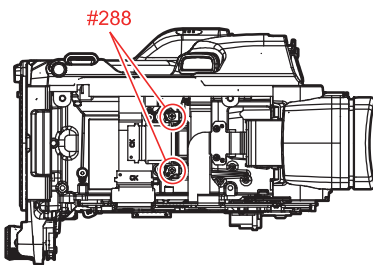

### [3] #2 x 6

Right View

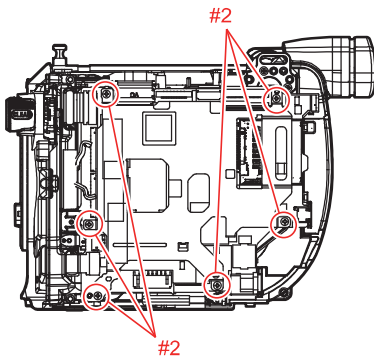

## Notes on Assembling the Overall Section 2

### Arranging the Coaxial Cables and Fan Harness

Install the coaxial cables in the left side of the metal plate and fix it so that there is not a float.

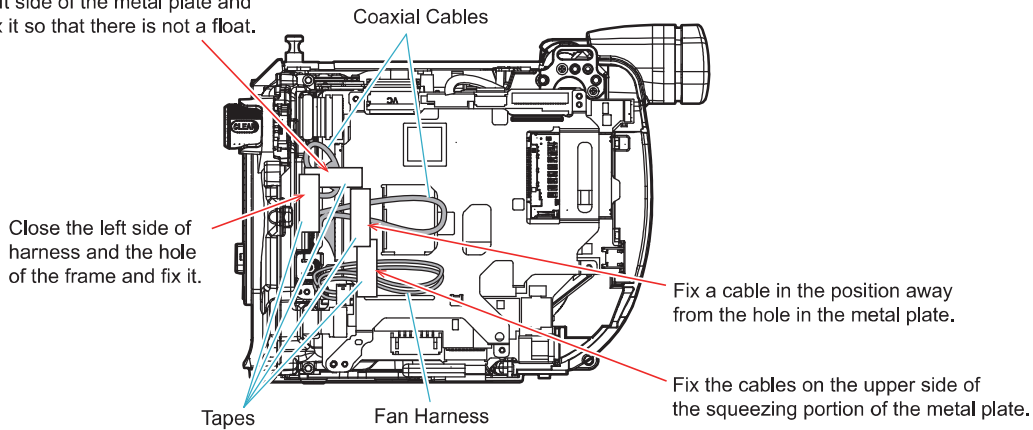

### Routing the Battery harness

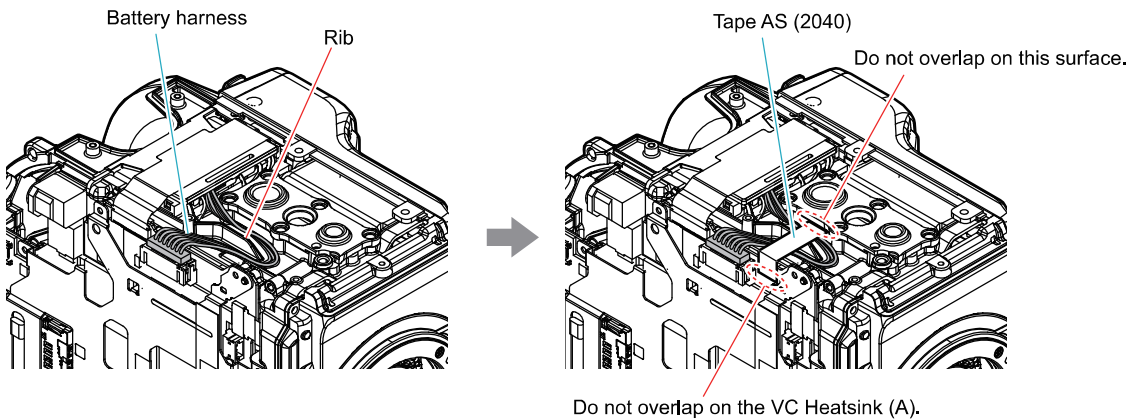

### Routing the Coaxial Cable

Pass through the cable between the VF Flexible Cable and positioning boss.

Process the edge of the tape of thin coaxial cable with the location of the positioning boss.

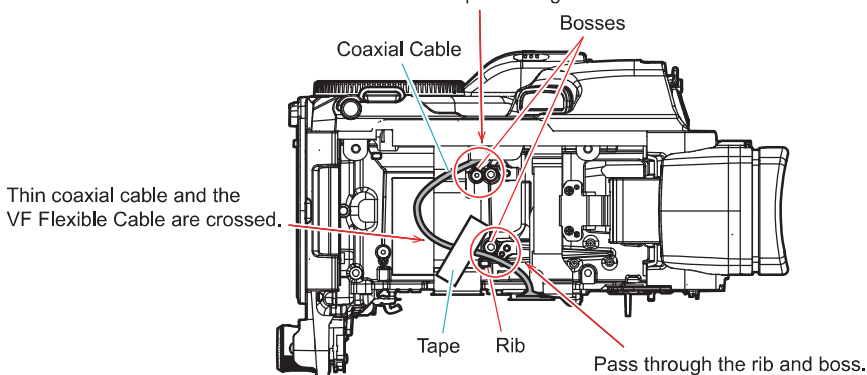

### 2-2-3. Overall Section 3

- Refer to “Overall Section 3” on exploded view for Ref. No.

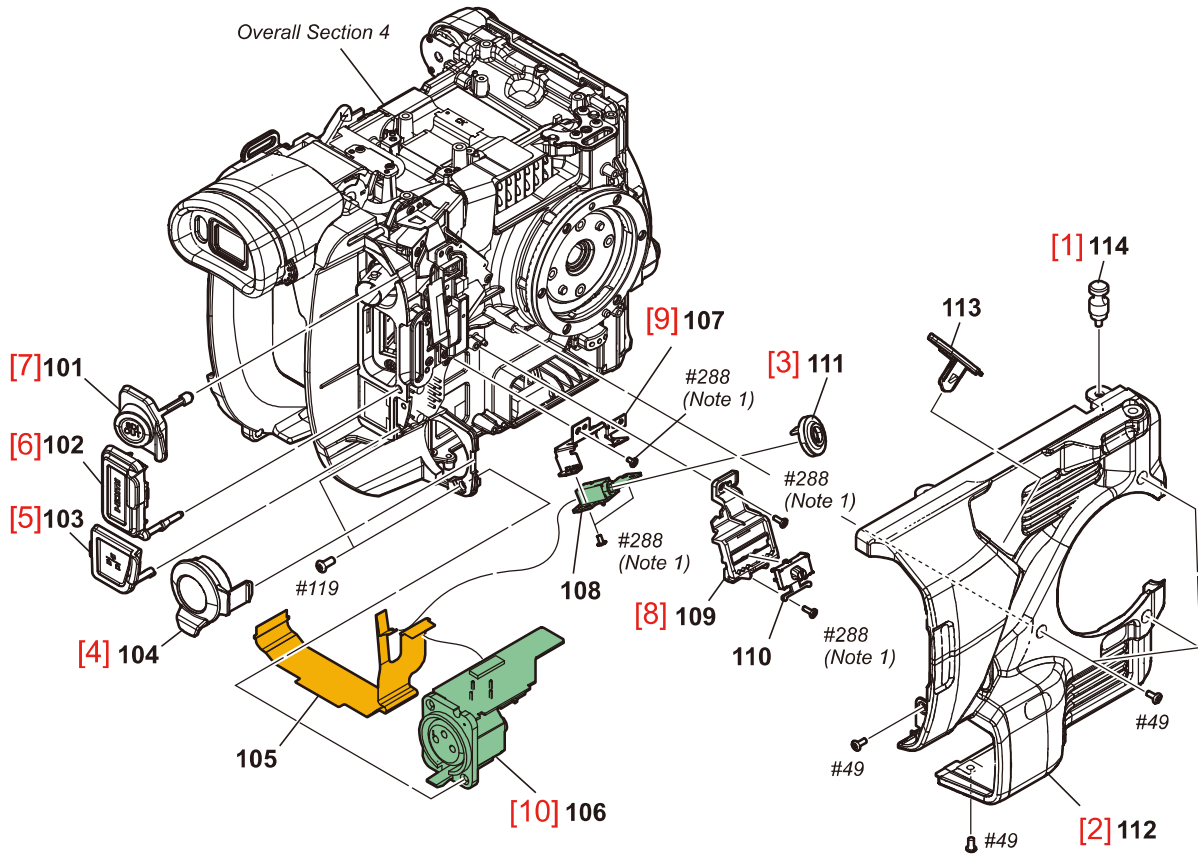

#### Note 1

This screw can not be reused. Discard the screw removed once in servicing. Instead, use a new screw.



## Disassembly Places

[2] #49 x 3 → Open the Connector Covers → #49 x 1 → #49 x 1

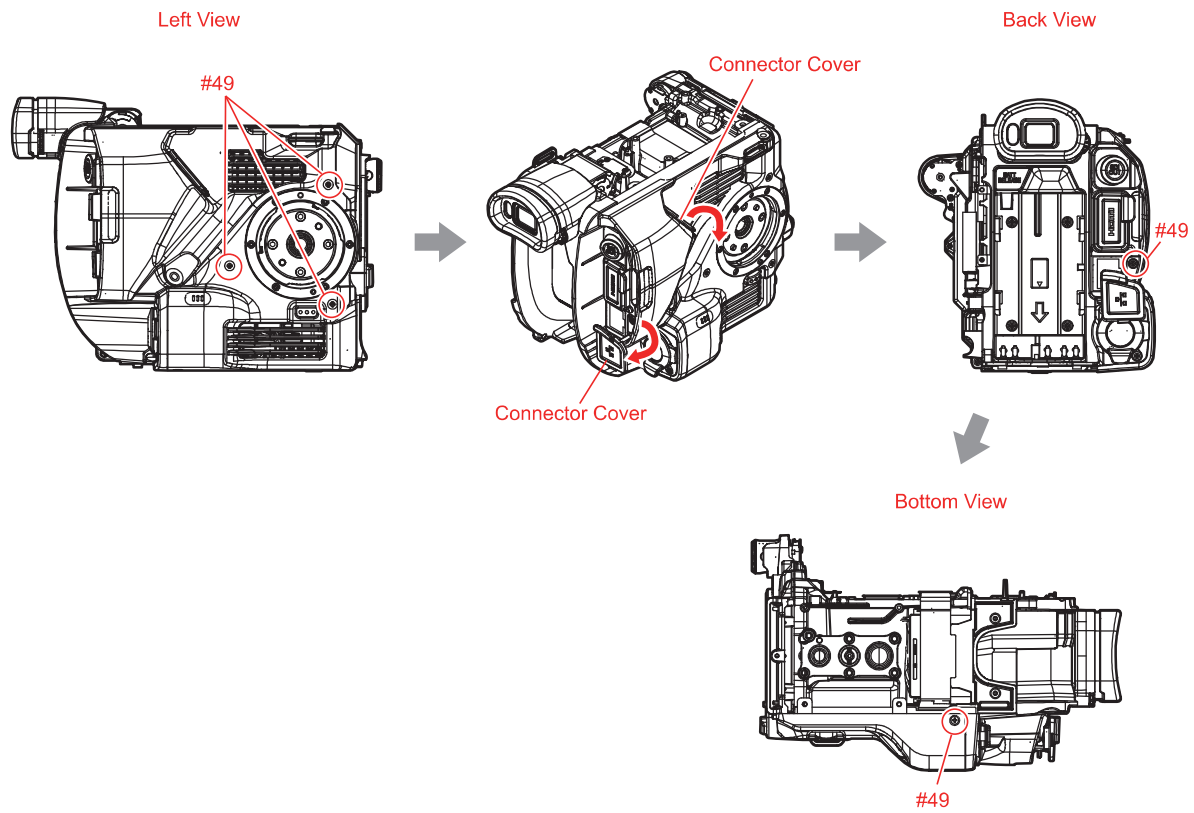

[8] #288 x 2

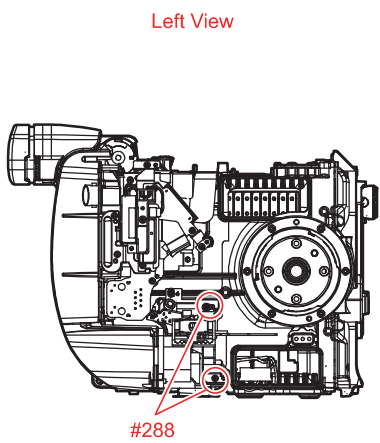

[9] #288 x 1

Left View

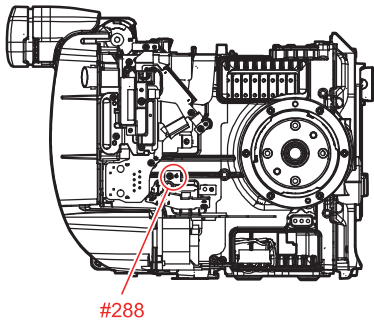

[10] #119 x 2

Back View

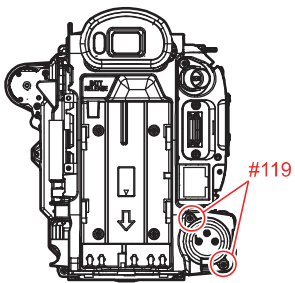



### Note 3

This part can not be reused. Discard the part removed once in servicing. Instead, use a new part.

### Disassembly Places

---

[1] #288 x 2

Left View

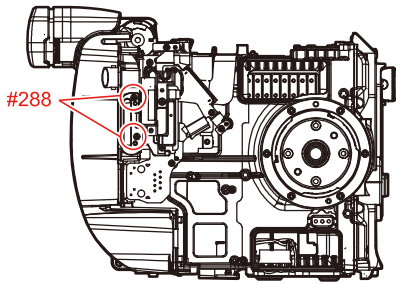

[3] #288 x 3

Left View

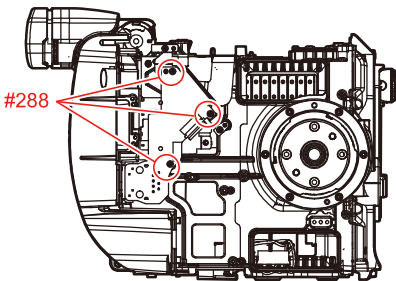

[5] #288 x 2

Left View

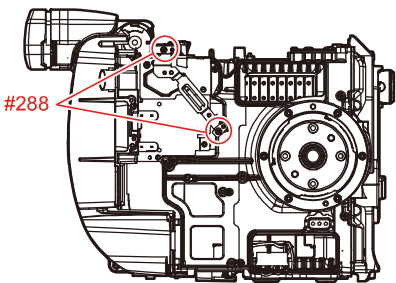

[6] #288 x 2

Left View

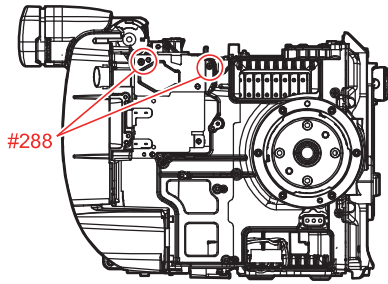

[7] #119 x 1, #288 x 2

Back View

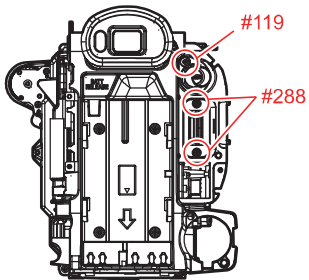

---

### Notes on Assembling the Overall Section 4

#### Routing the Cable

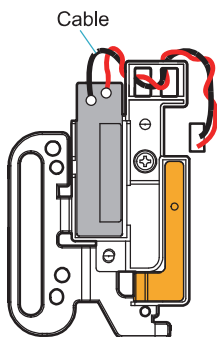

## Installing the VF-1016 Board and WF Board

When installing the VF-1016 Board and WF Board, Pass through the FP-2335 and FP-2334 flexible boards under the VF Plate.

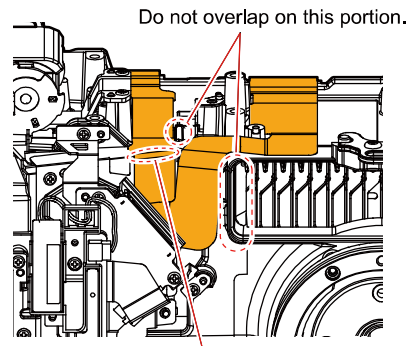
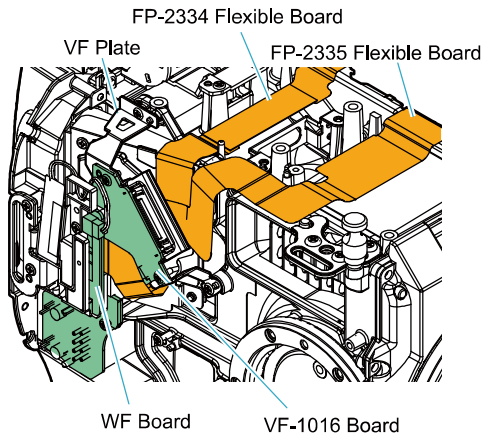

Bending portion of the metal plate is in the reinforcement plates.

Check that the Wi-Fi flexible cable is in the horizontal portion of the main frame.

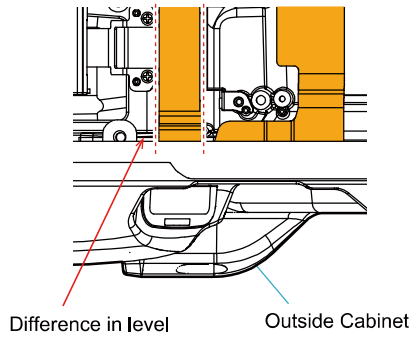

### Attaching the Gasket (L), USB Bottom Gasket and BM Gasket

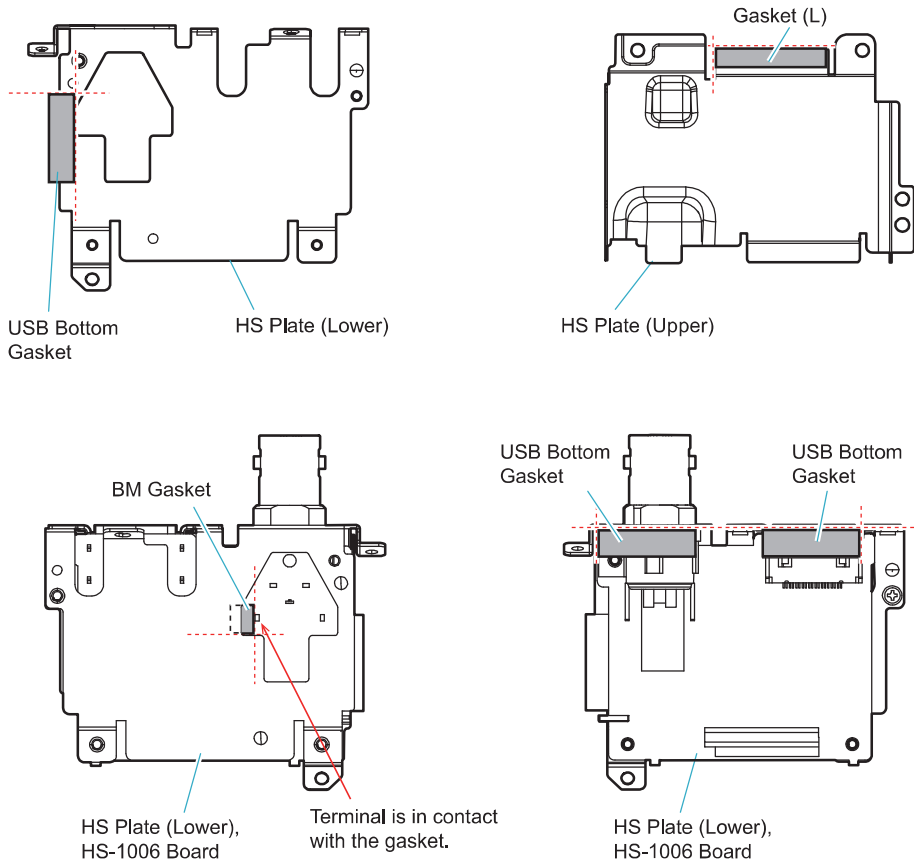

### Attaching the WF Spacer and VF Flexible Spacer

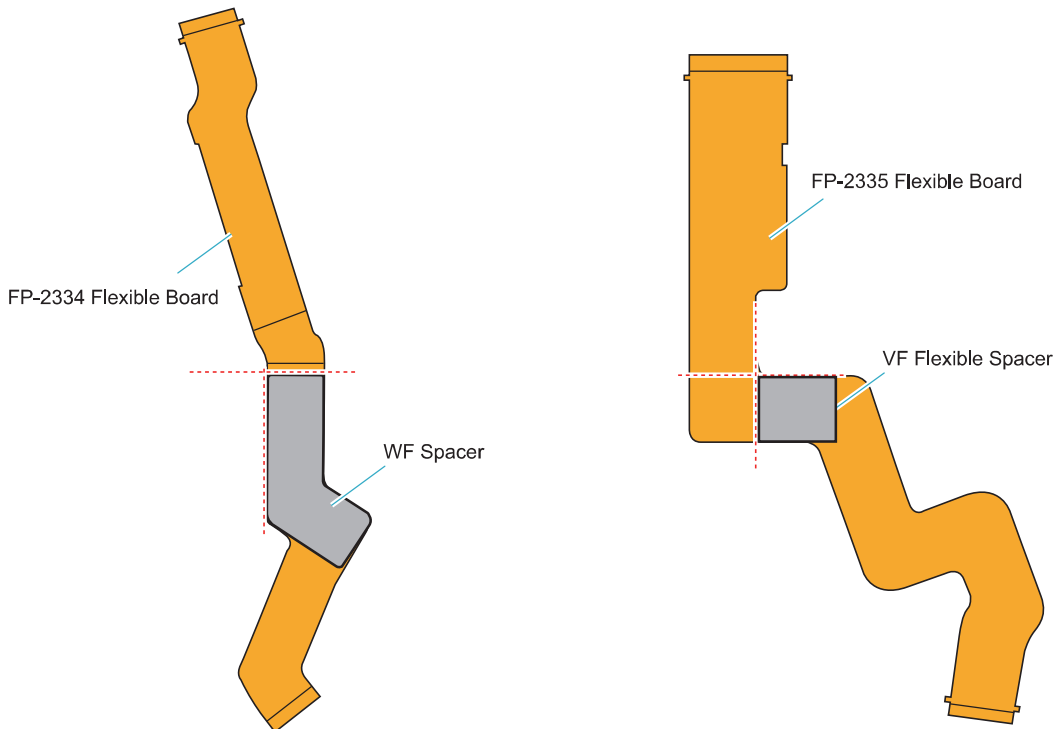

**confirmation item**

Check that there is no deformation.

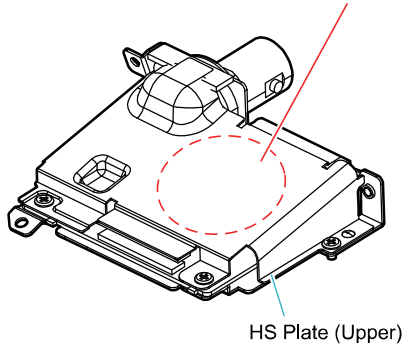

Do not overlap on the boss.

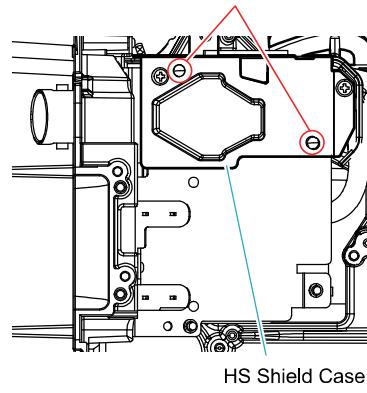



### 2-2-5. Overall Section 5

- Refer to "Overall Section 5" on exploded view for Ref. No.

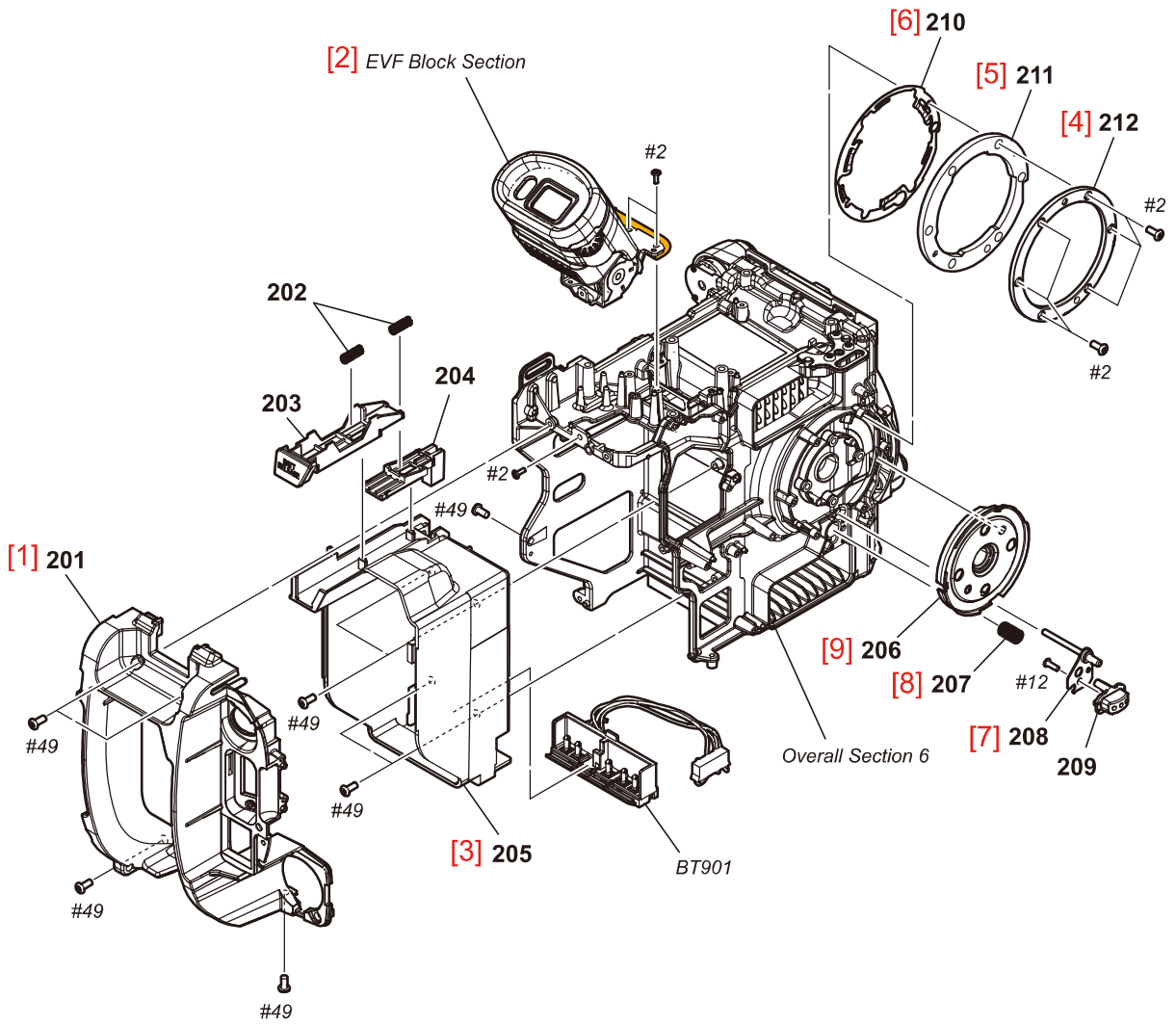

## Disassembly Places

[1] Tilt up the EVF → #49 x 3 → #49 x 1 → #49 x 1

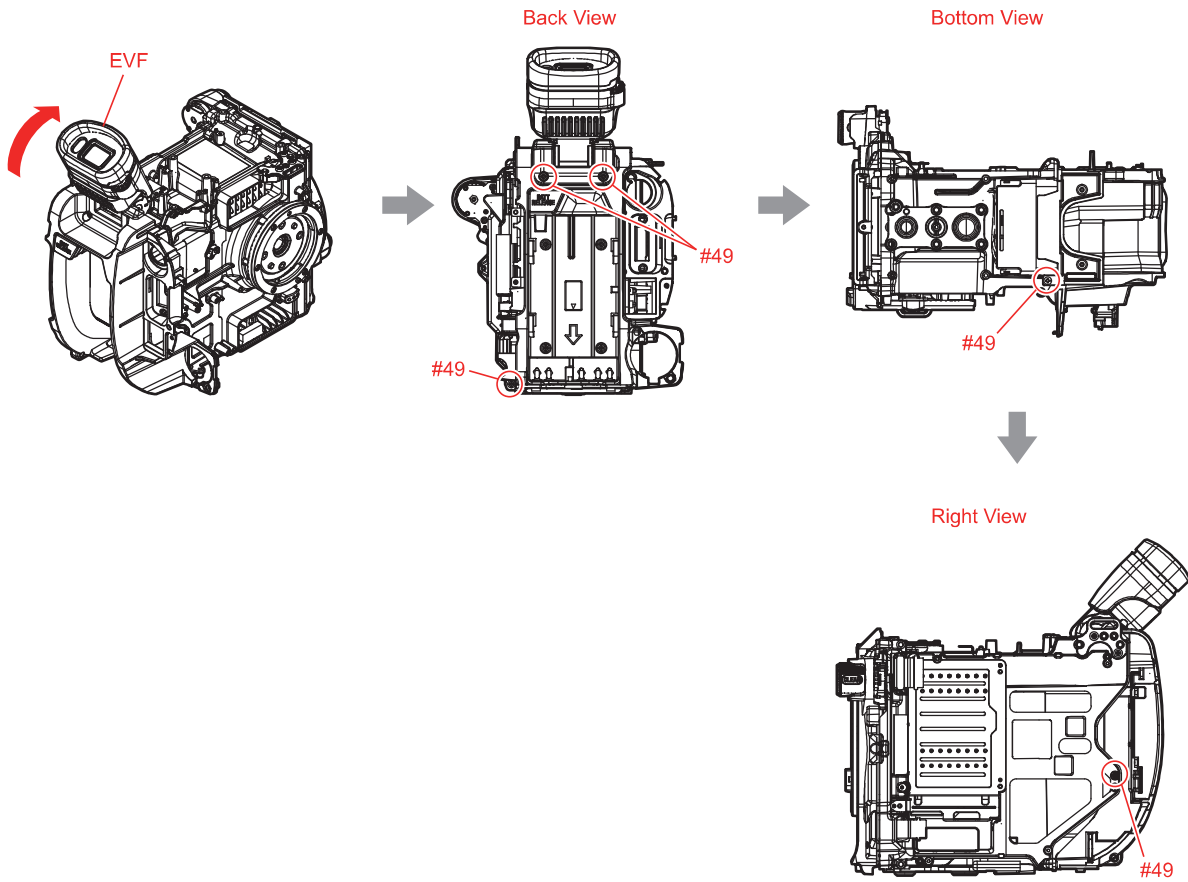

[2] #2 x 1 → #2 x 2

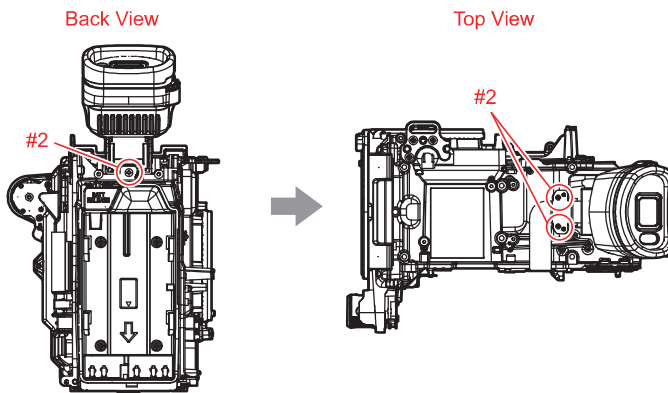

[3] #49 x 4

Back View

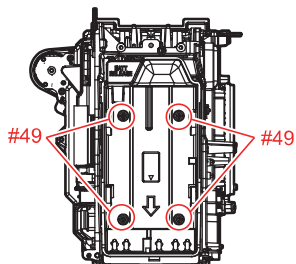

[4] #2 x 6

Left View

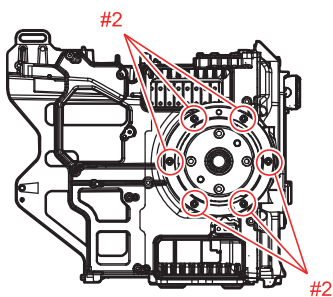

## 2-2-6. Overall Section 6

- Refer to “Overall Section 6” on exploded view for Ref. No.

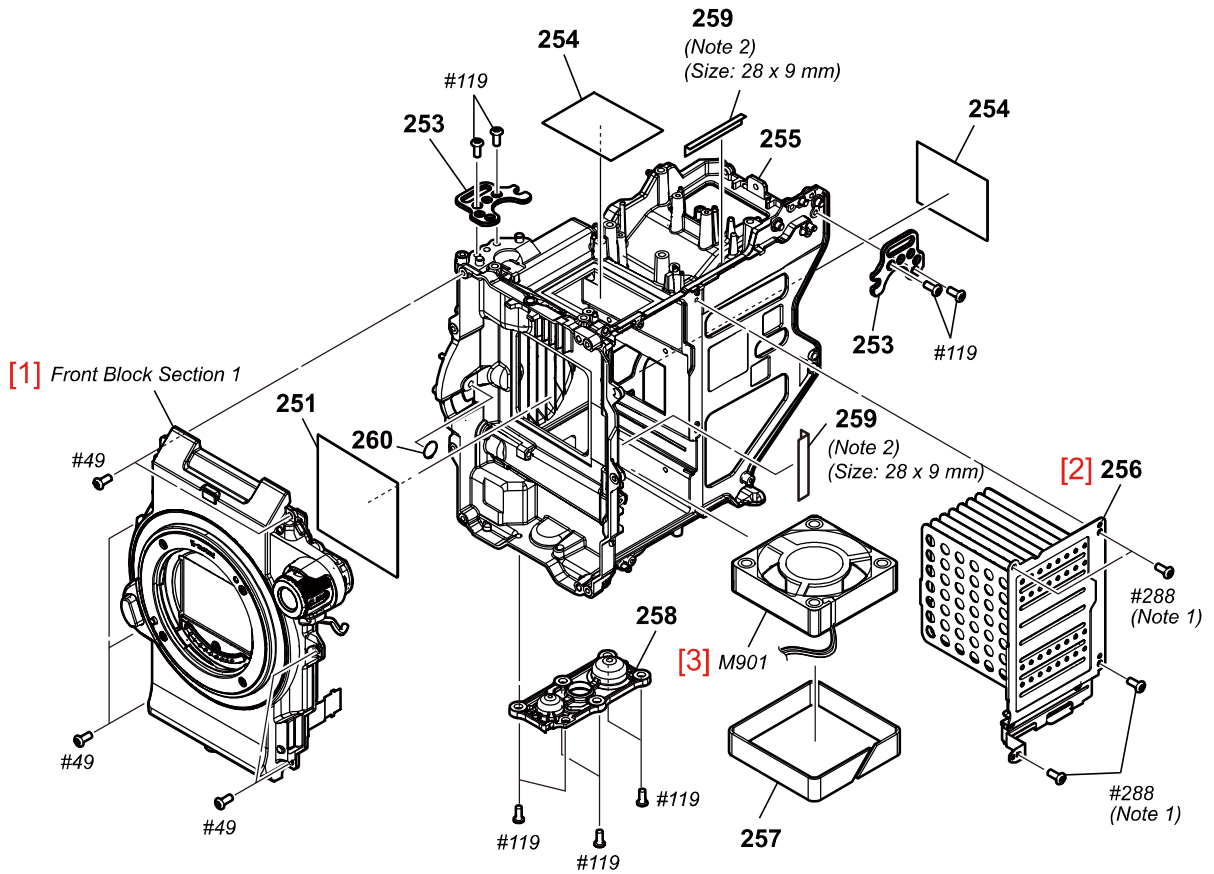

### Note 1

This screw can not be reused. Discard the screw removed once in servicing. Instead, use a new screw.

### Note 2

Use this to cut or splice so that it becomes the designated size.

## Disassembly Places

[1] #49 x 7

Front View

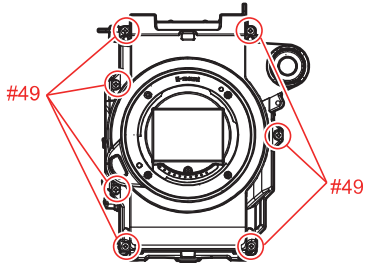

[2] #288 x 4

Right View

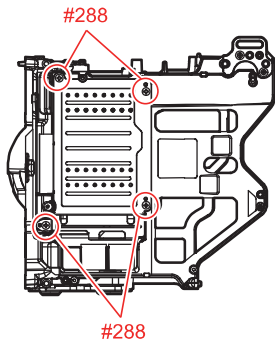

---

## Notes on Assembling the Overall Section 6

### Installing the Front Block

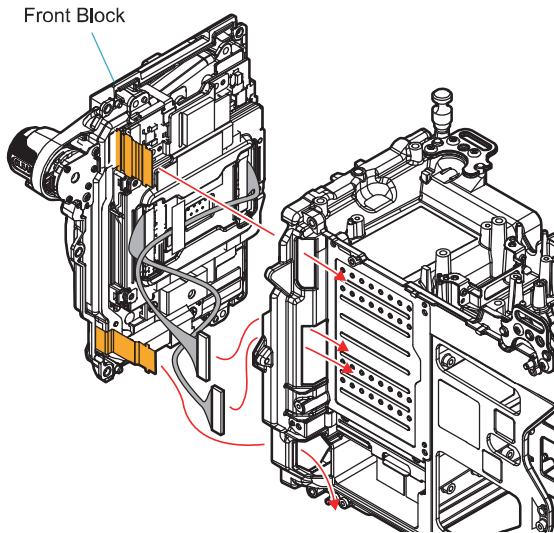

### Installing the DC Fan

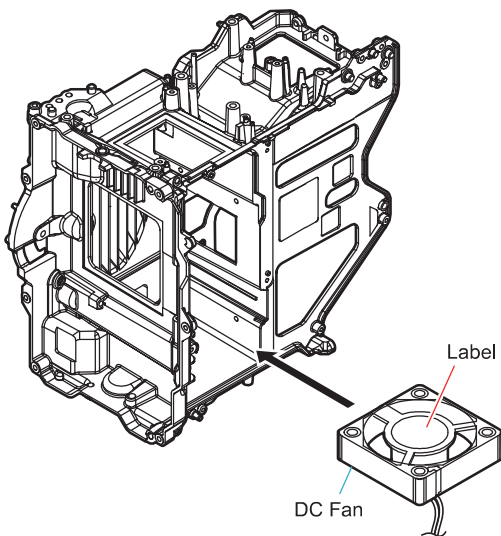

### Arranging the Coaxial Cables

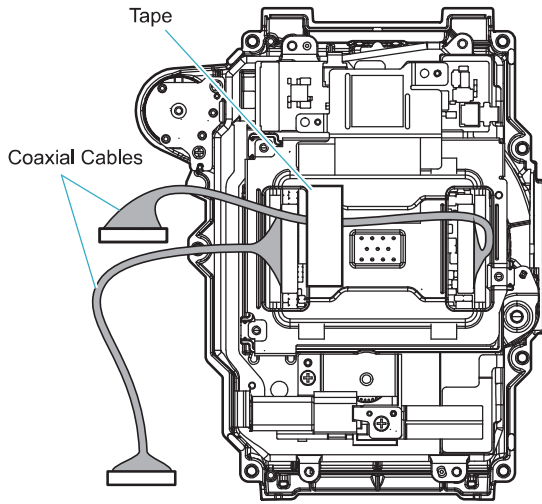

## 2-2-7. Grip Block Section 1

- Refer to "Grip Block Section 1" on exploded view for Ref. No.

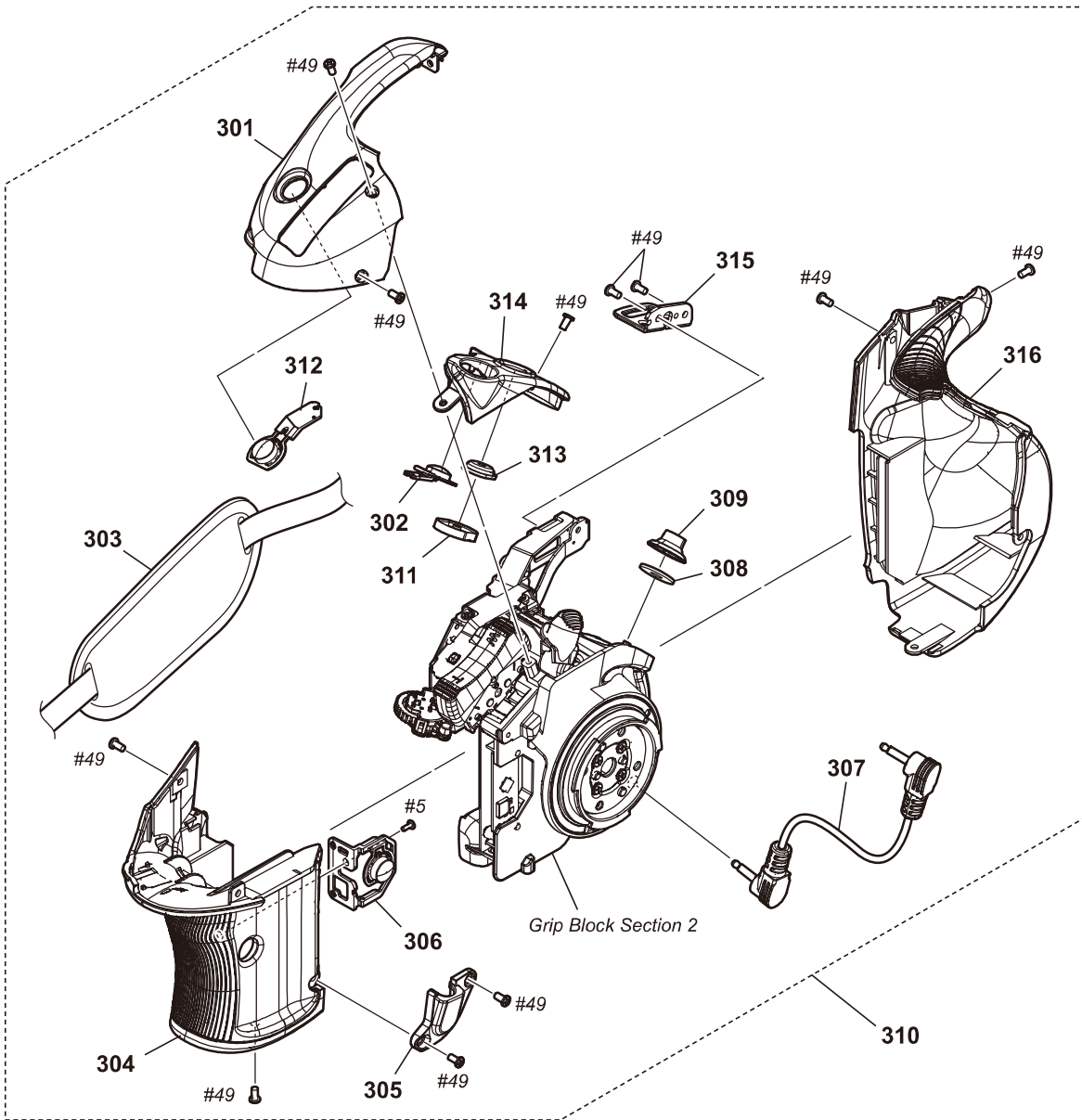



---

## Notes on Assembling the Grip Block Section 1

### Attaching the Muffle Sheet (G)

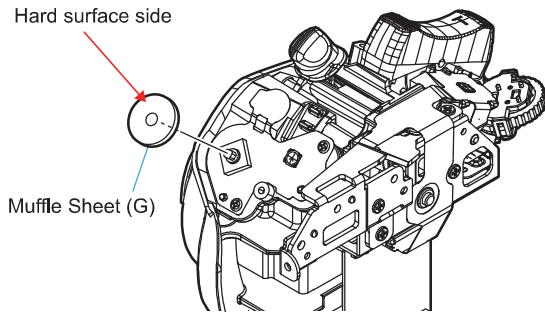

### Attaching the REC Button (Grip)

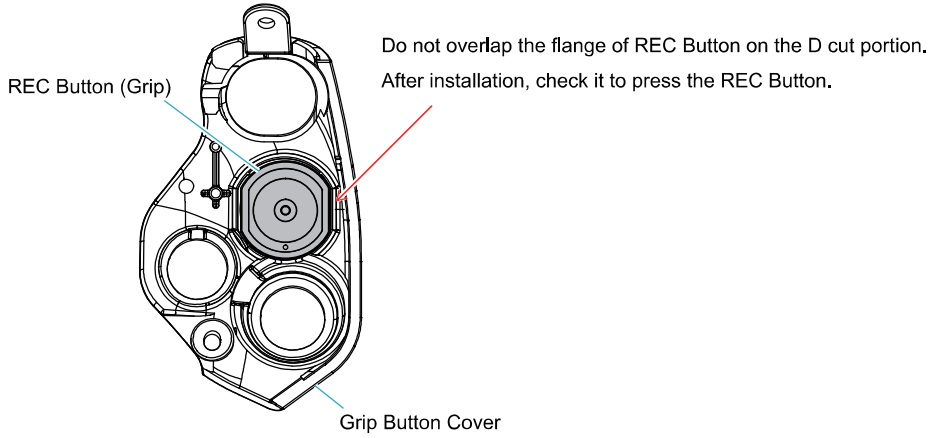

## 2-2-8. Grip Block Section 2

- Refer to "Grip Block Section 2" on exploded view for Ref. No.

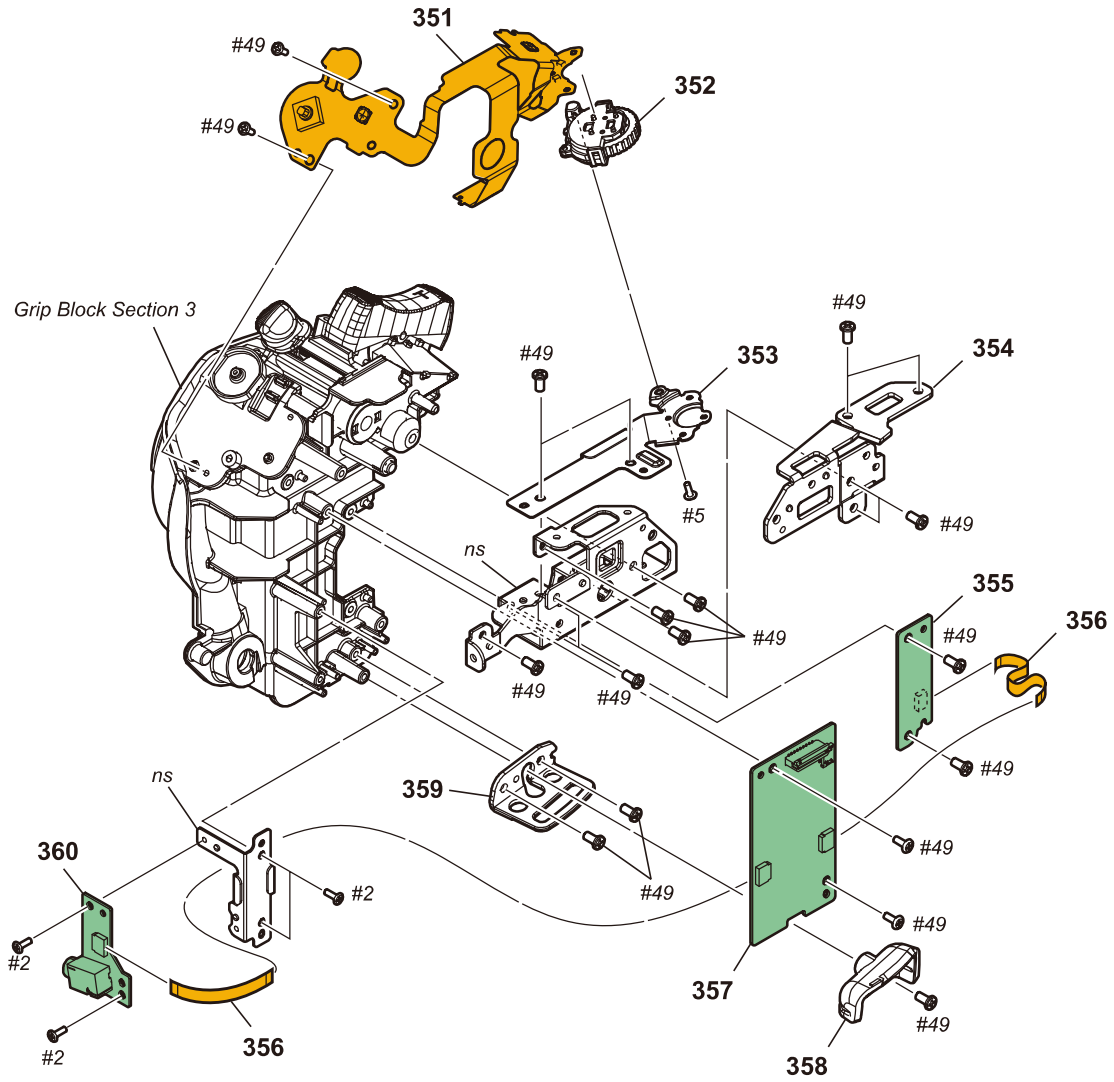

### 2-2-9. Grip Block Section 3

- Refer to “Grip Block Section 3” on exploded view for Ref. No.

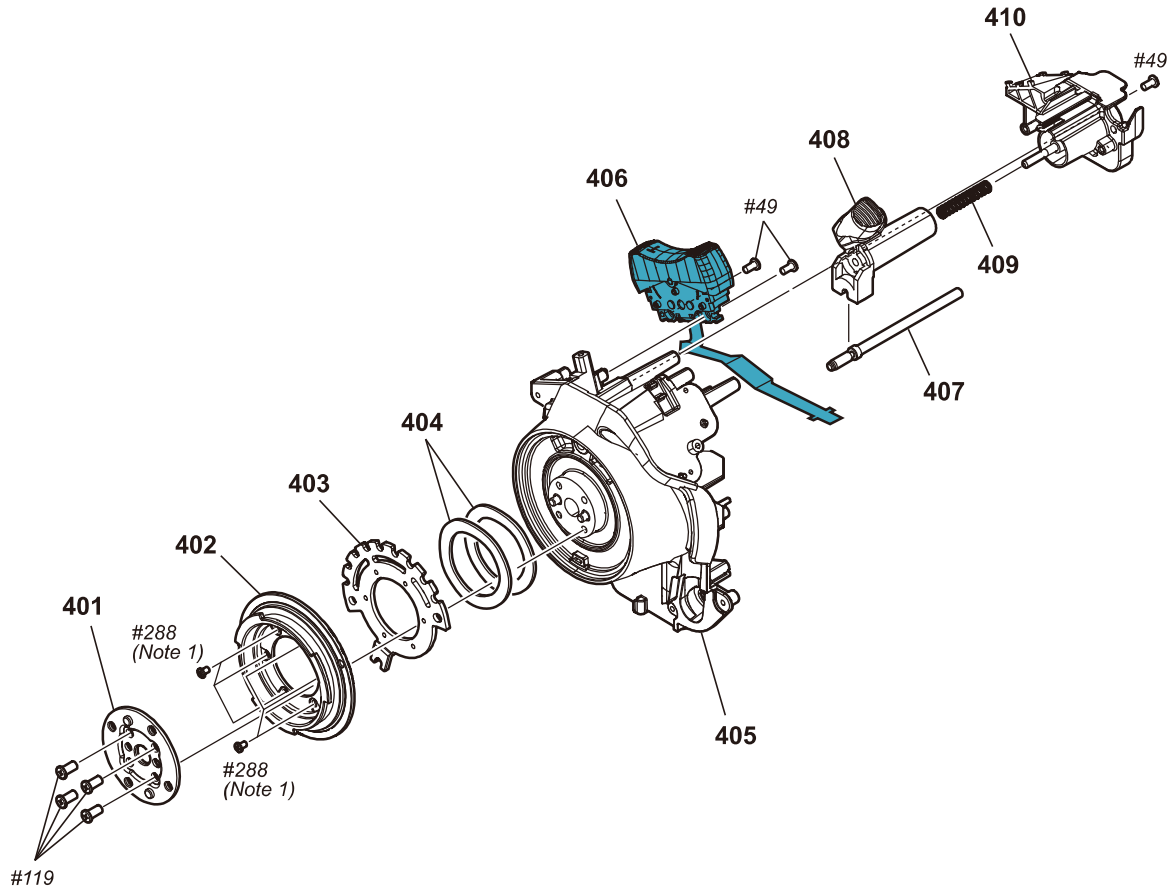

#### Note 1

This screw can not be reused. Discard the screw removed once in servicing. Instead, use a new screw.

## 2-2-10. Inside Block Section 1

- Refer to “[Inside Block Section 1](#)” on exploded view for Ref. No.

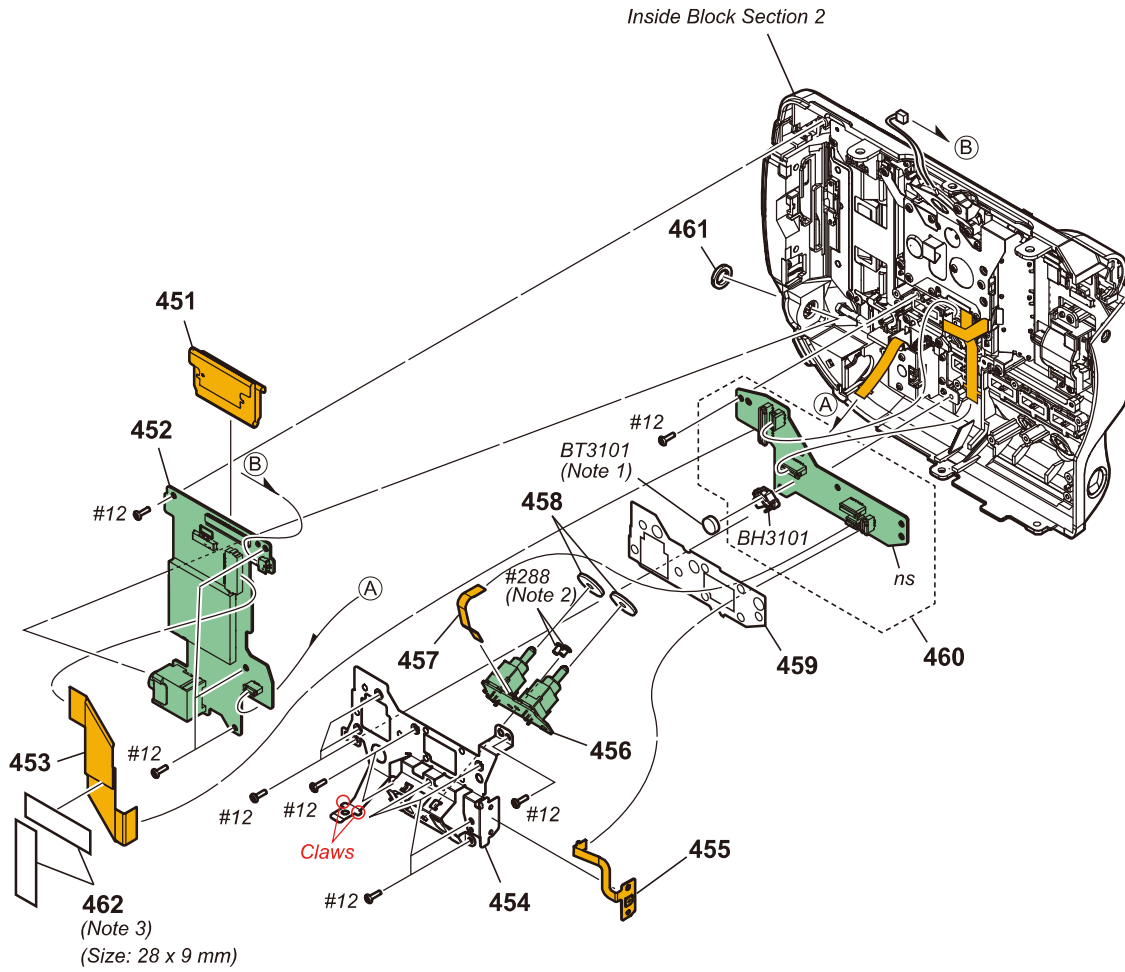

### Note 1

Danger of explosion if battery is incorrectly replaced.  
 Replace only with the same or equivalent type.  
 Dispose of used batteries according to the instructions.

**Note 2**

This screw can not be reused. Discard the screw removed once in servicing. Instead, use a new screw.

**Note 3**

Use this to cut or splice so that it becomes the designated size.

---

**Notes on Assembling the Inside Block Section 1**

**Routing the Speaker Harness**

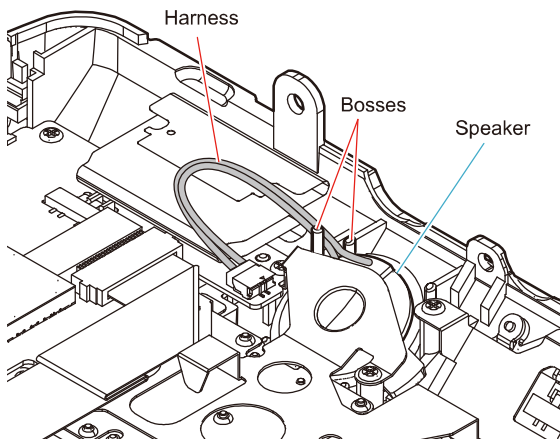

**Attaching the Waterproof Cushion (SW)**

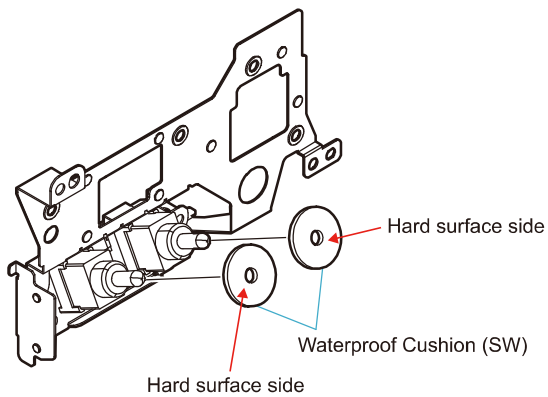

## 2-2-11. Inside Block Section 2

- Refer to “Inside Block Section 2” on exploded view for Ref. No.

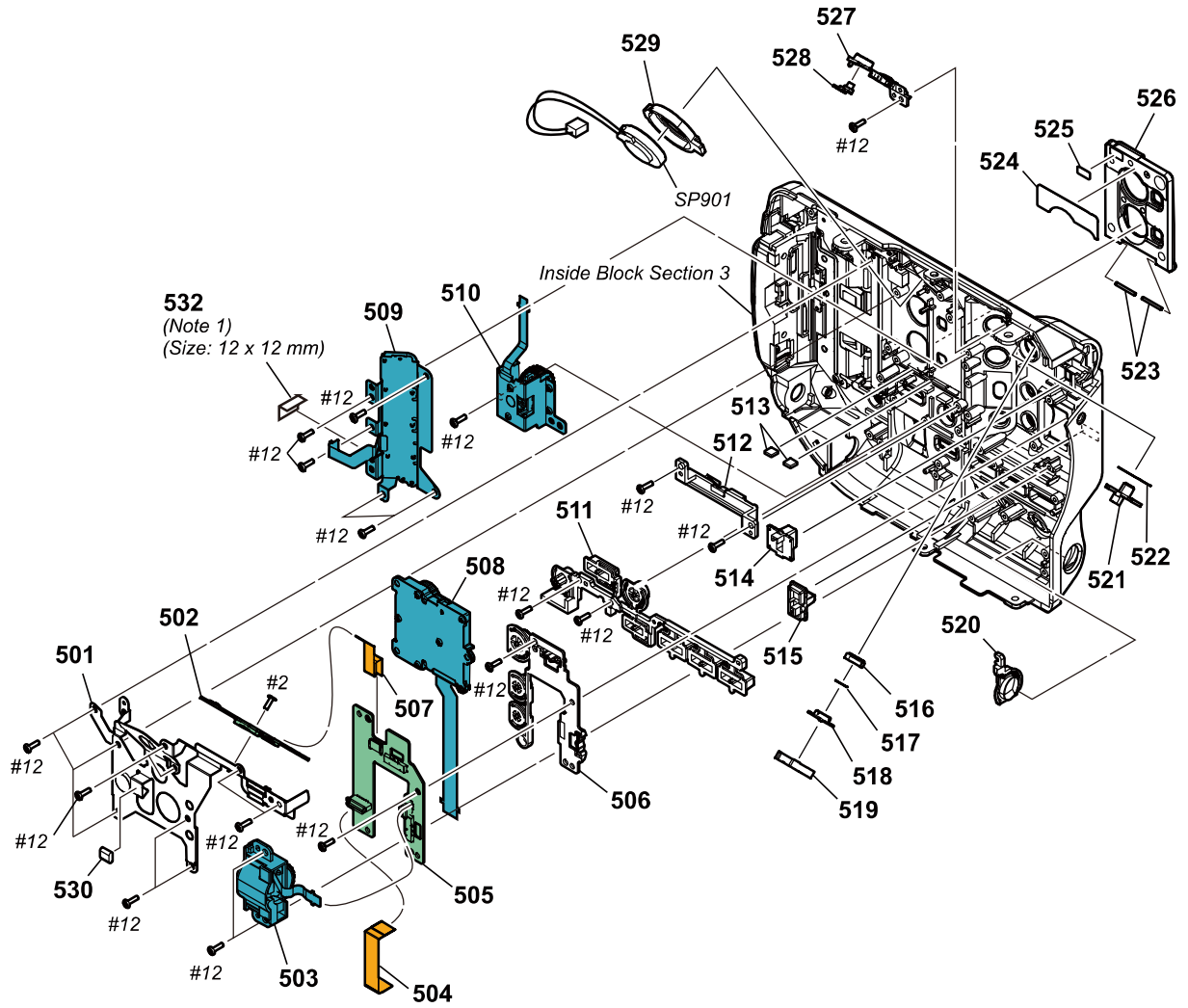

### Note 1

Use this to cut or splice so that it becomes the designated size.

---

## Notes on Assembling the Inside Block Section 2

### Routing the Speaker Harness

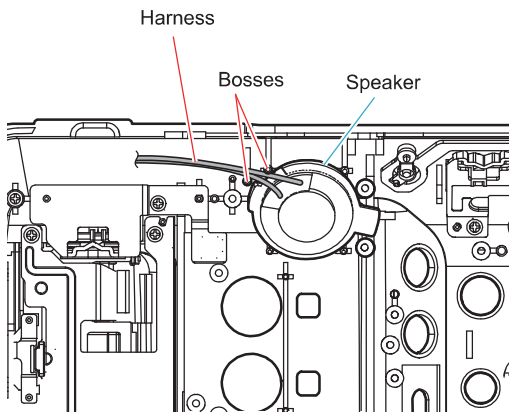

### 2-2-12. Inside Block Section 3

- Refer to “[Inside Block Section 3](#)” on exploded view for Ref. No.

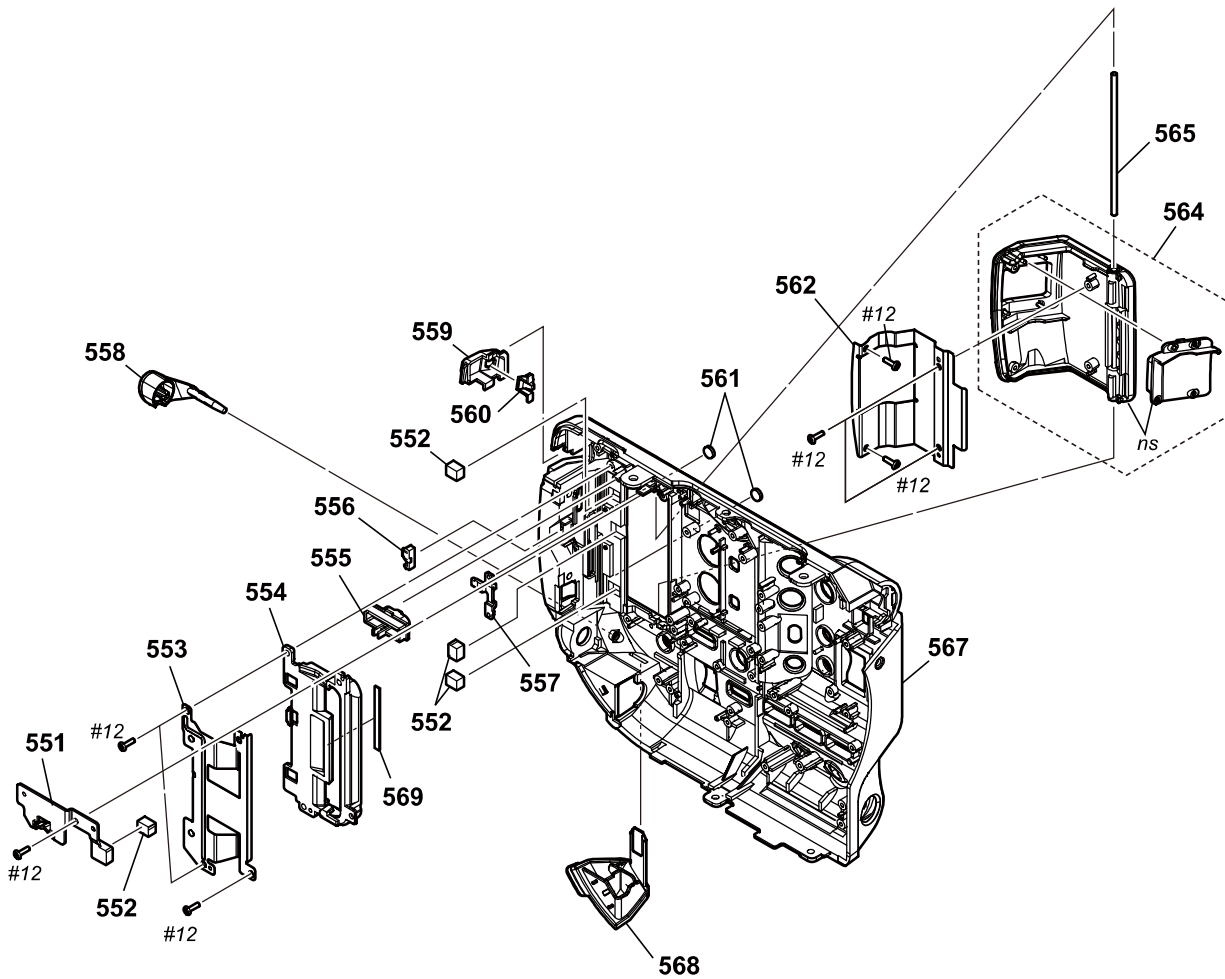



## 2-2-13. LCD Block Section

- Refer to “LCD Block Section” on exploded view for Ref. No.

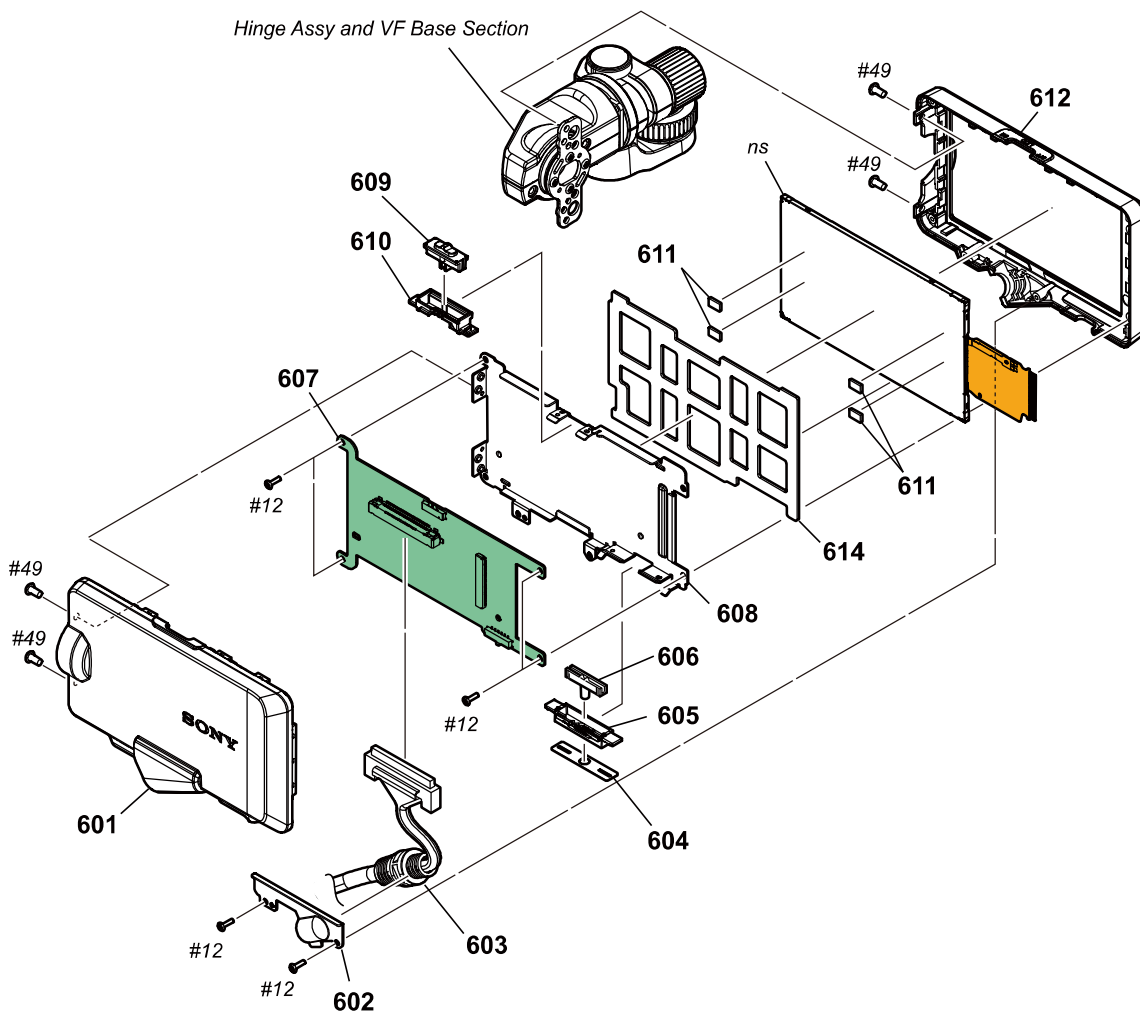

## 2-2-14. Hinge Assy and VF Base Section

- Refer to “Hinge Assy and VF Base Section” on exploded view for Ref. No.

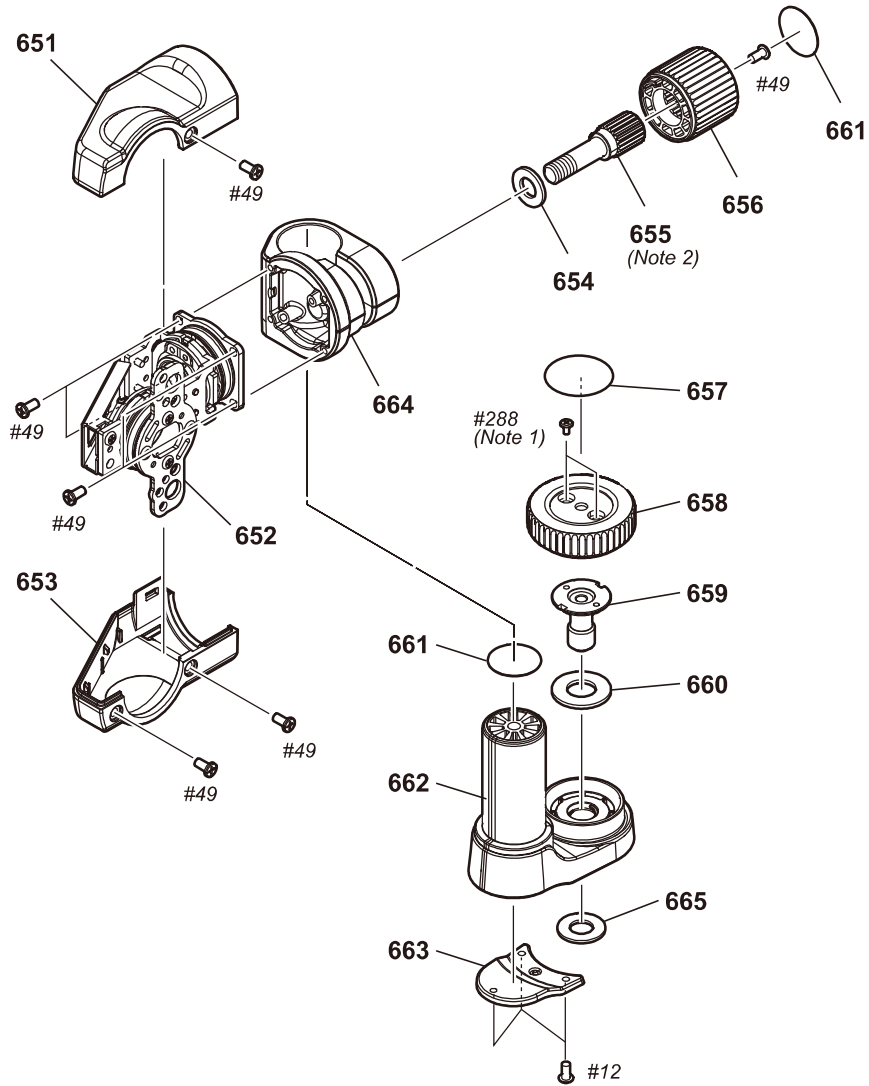

### Note 1

This screw can not be reused. Discard the screw removed once in servicing. Instead, use a new screw.

**Note 2**

When replacing this part, apply the grease.  
Apply grease (G-119) to the three turns of the thread so as not to protrude from the thread.

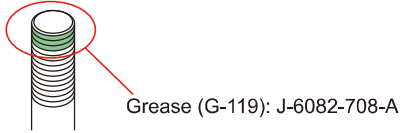

## 2-2-15. EVF Block Section

- Refer to “EVF Block Section” on exploded view for Ref. No.

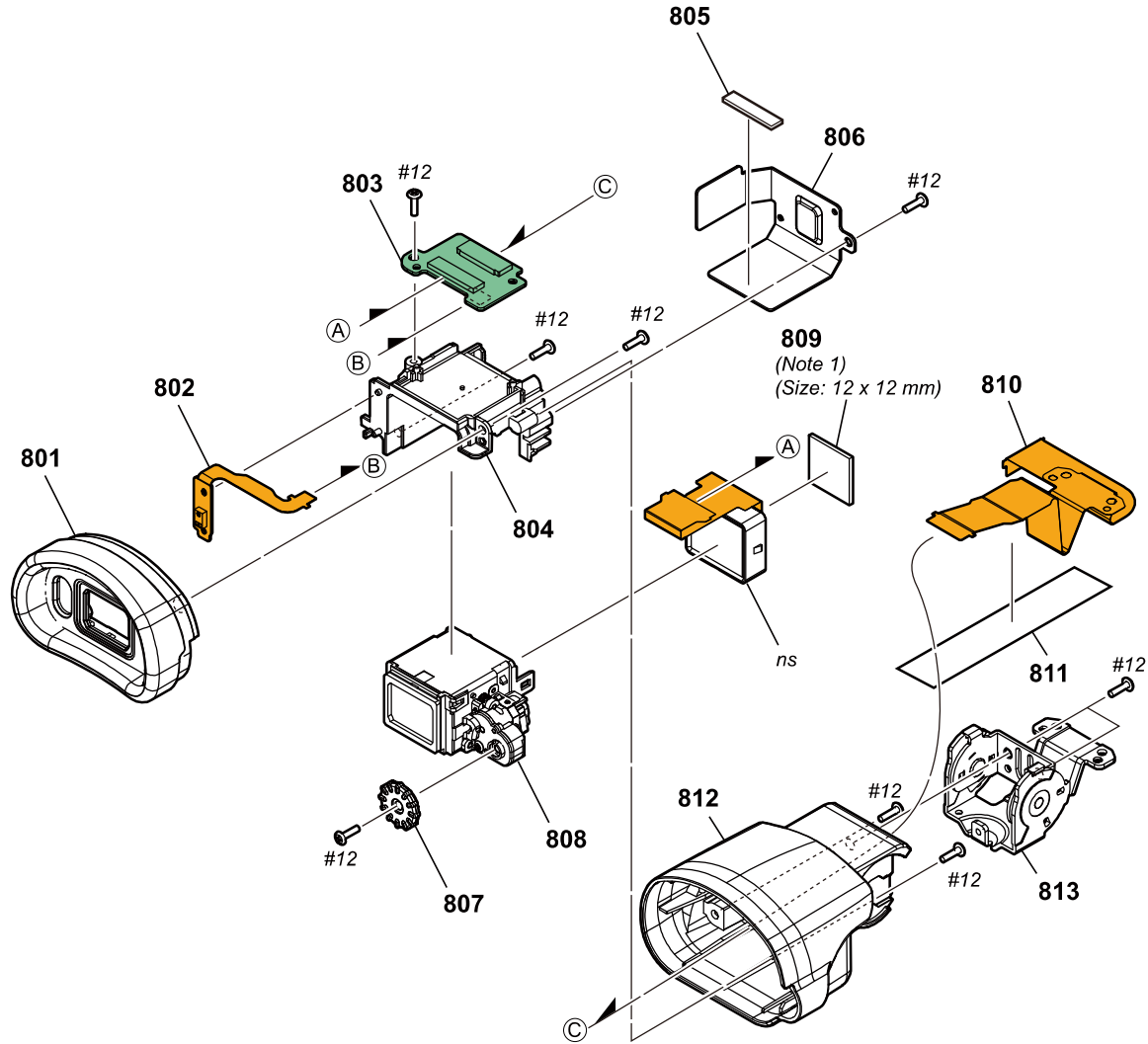

### Note 1

Use this to cut or splice so that it becomes the designated size.

## 2-2-16. Handle Block Section 1

- Refer to “Handle Block Section 1” on exploded view for Ref. No.

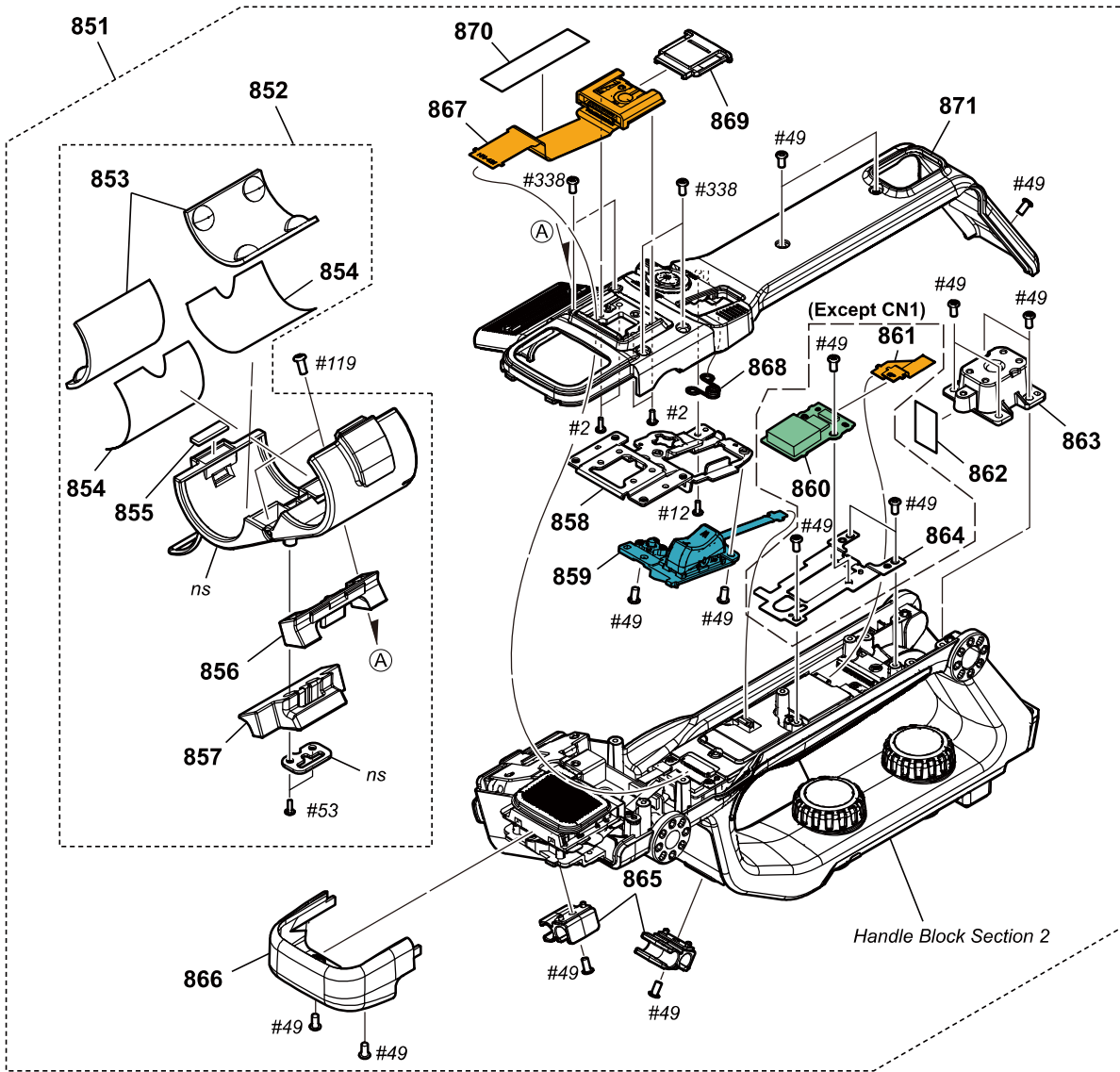

## Notes on Assembling the Handle Block Section 1

### Arranging the FP-2329 Flexible Board

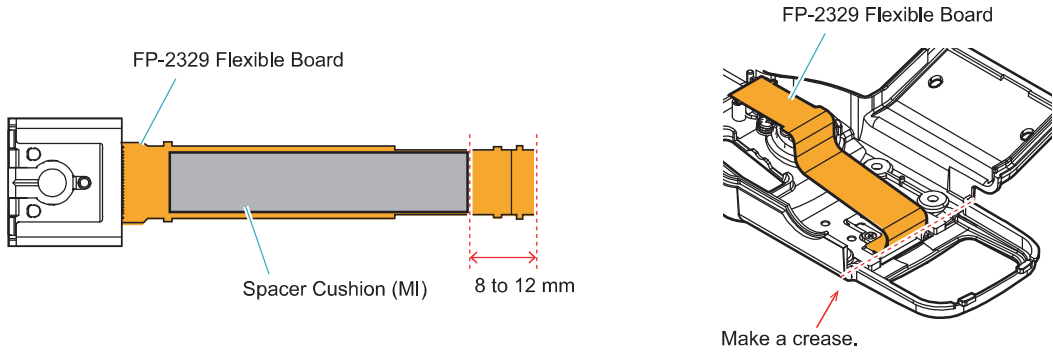

## 2-2-17. Handle Block Section 2

- Refer to “Handle Block Section 2” on exploded view for Ref. No.

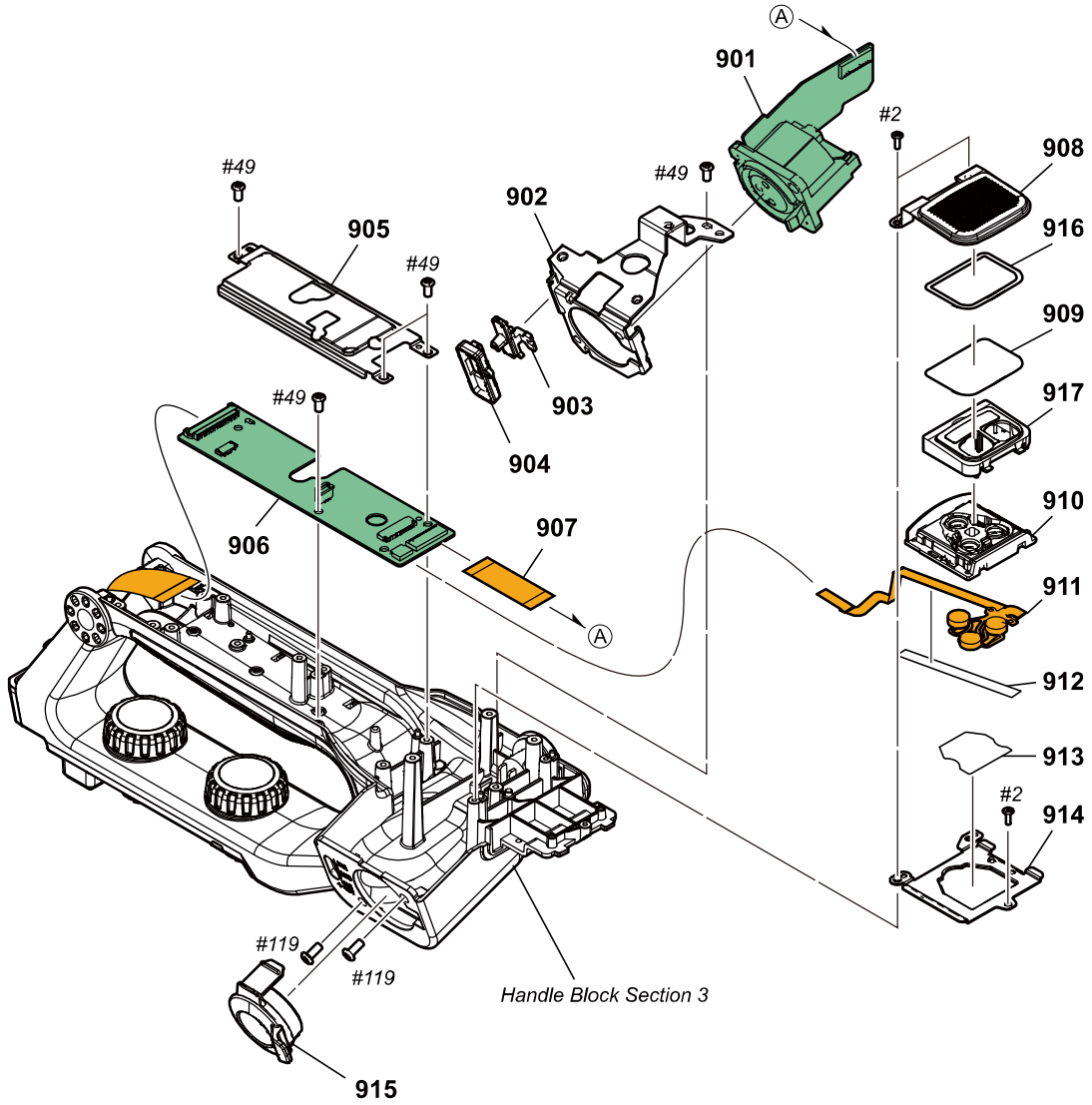

## Notes on Assembling the Handle Block Section 2

### Install the FP-2329 Flexible Board

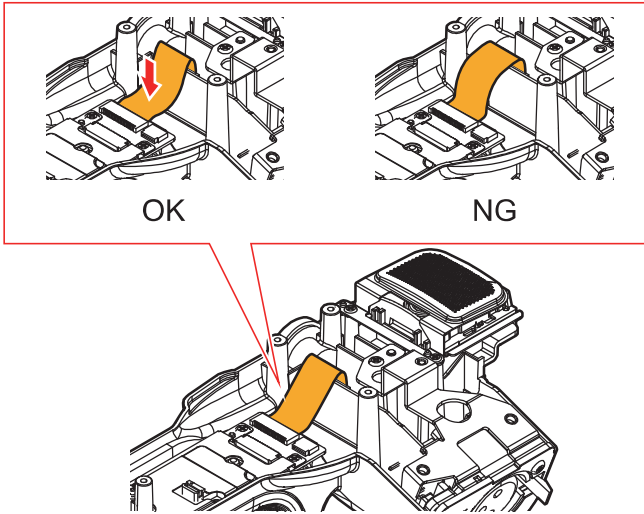

### Install the Microphone Unit

1. Paste the Microphone Flexible Cushion to the Microphone Unit.

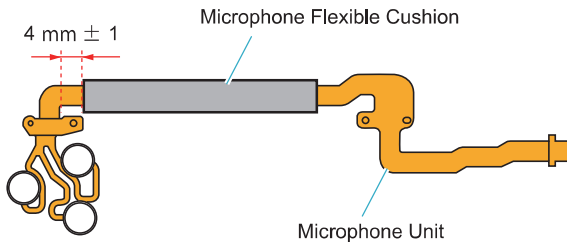

2. Install the Microphone Unit to the Microphone Insulator.

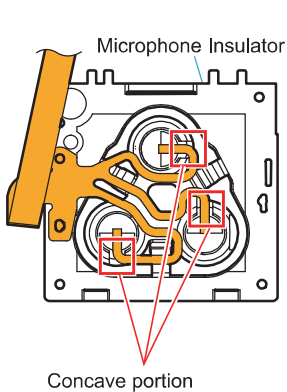

- Notes on the Microphone capsule:
- Do not protrude it from the insulator.
  - Do not install it in diagonally.
  - Do not shift it in the direction of rotation.

3. Align the six positioning bosses and install the Microphone Inner Mold.

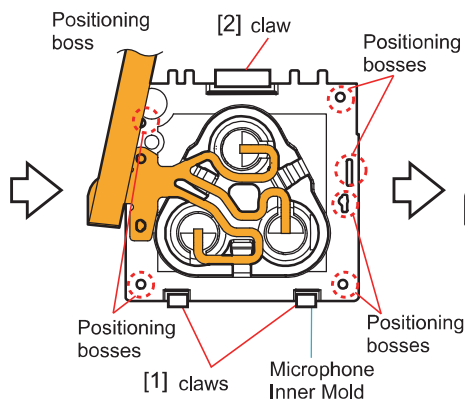

- Install the three claws in the order of [1] and [2].

4. Check that the three insulators of the microphone do not interfere with the peripheral.

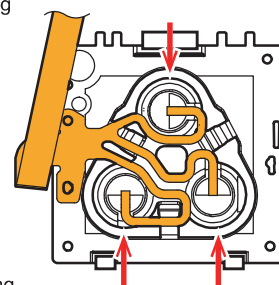



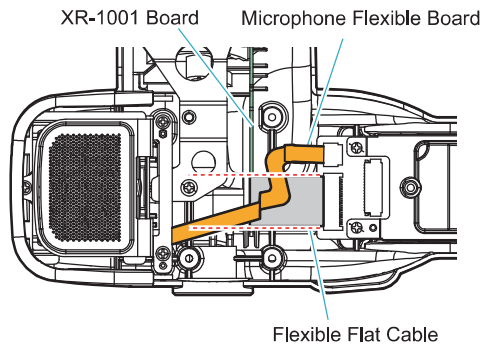

When passing through the microphone flexible Board on the XR-1001 board, place the Microphone Flexible Board so that it does not protrude from the width of the flexible flat cable.

Place the extra length portion of the Microphone Flexible Board in the downward direction along the rib.

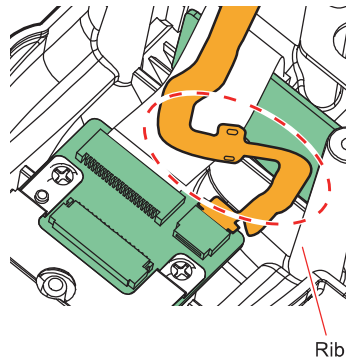

### 2-2-18. Handle Block Section 3

- Refer to "Handle Block Section 3" on exploded view for Ref. No.

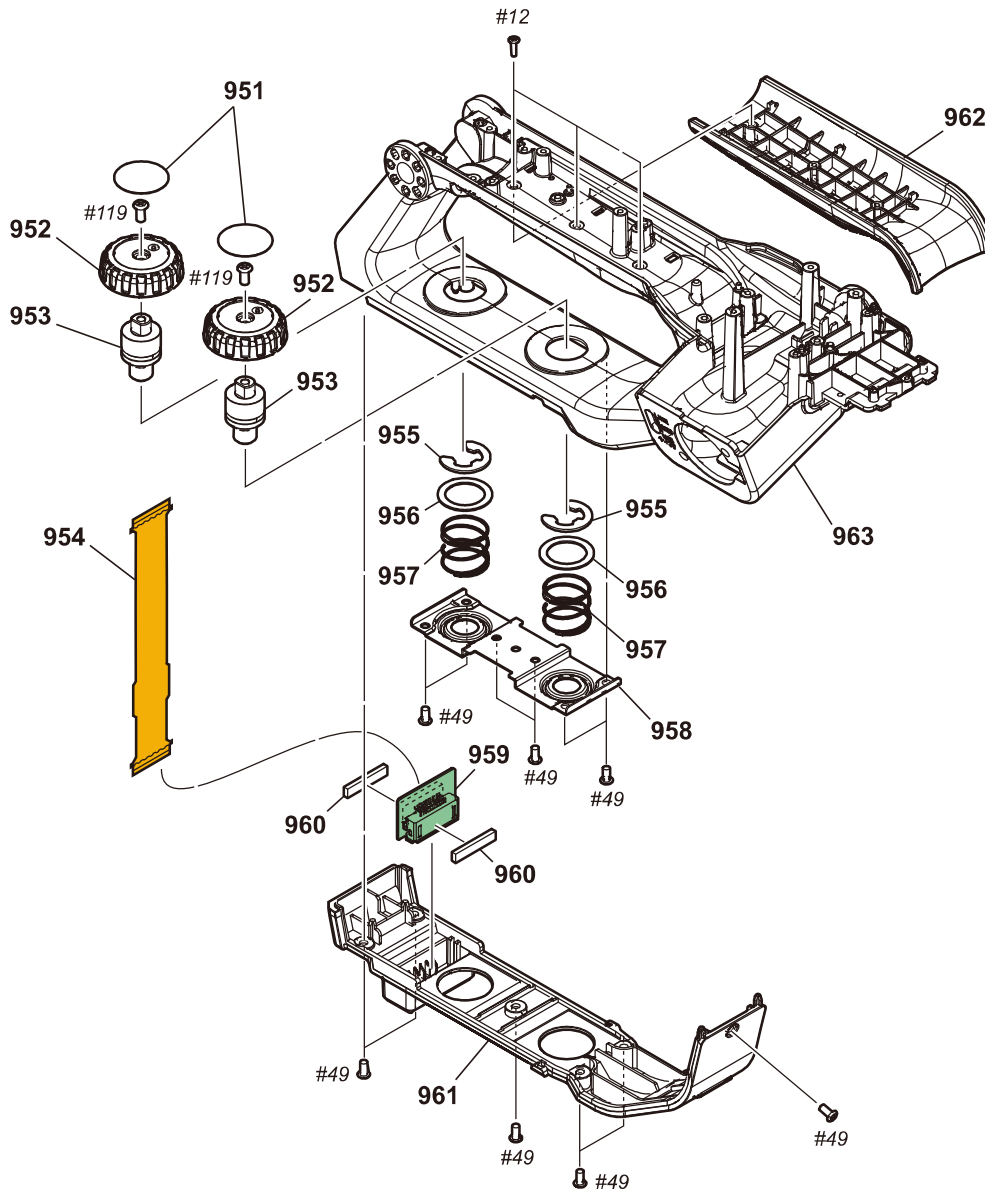

## Section 3

### Repair Parts List

#### 3-1. Note on Repair Parts

NOTE:

- -XX, -X mean standardized parts, so they may have some differences from the original one.
- Items marked "\*" are not stocked since they are seldom required for routine service. Some delay should be anticipated when ordering these items.
- The mechanical parts with no reference number in the exploded views are not supplied.
- Due to standardization, replacements in the parts list may be different from the parts specified in the diagrams or the components used on the set.
- ns: Not supplied part.

The components identified by mark  $\triangle$  or dotted line with mark  $\triangle$  are critical for safety.  
Replace **only** with part number specified.

Les composants identifiés par une marque  $\triangle$  sont critiques pour la sécurité.  
Ne les remplacer que par une pièce portant le numéro spécifié.

- Color Indication of Appearance Parts  
Example:  
(SILVER) : Cabinet's Color  
(Silver) : Parts Color

### 3-2. Exploded View

#### Overall Section 1

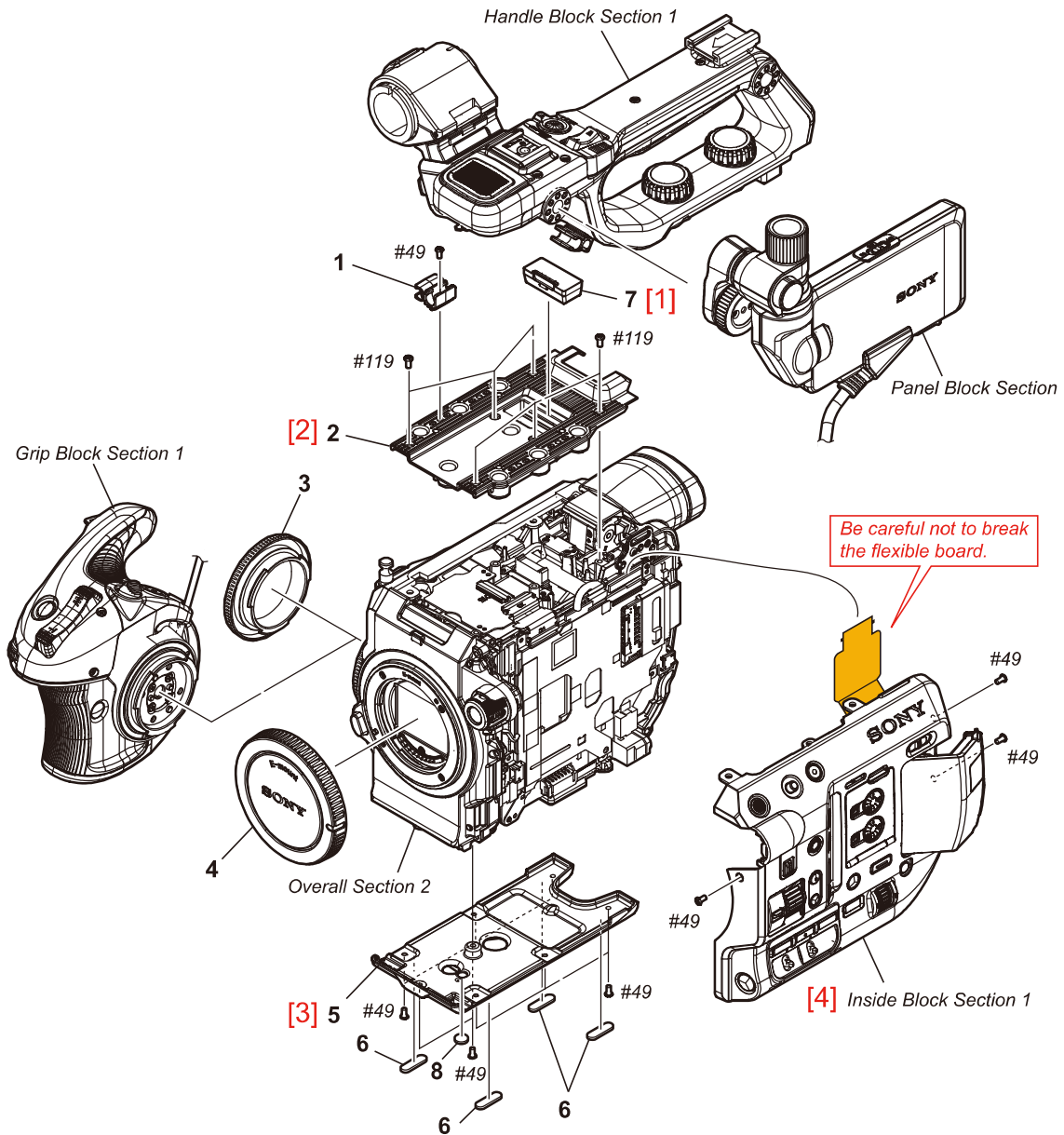

Ref. No. or Q'ty	Part No.	SP Description
1	4-579-745-01	CLAMP (964), CABLE
2	4-576-417-01	CABINET (TOP)
3	4-579-209-01	GRIP MOUNT COVER
4	4-188-536-01	CAP, BODY
5	4-576-419-01	CABINET (BM)
6	4-540-533-01	FOOT (941), RUBBER
7	4-579-210-01	HANDLE CONNECTOR COVER
8	4-587-420-01	LID, BM
#49	2-630-005-31	SCREW (M2), NEW TRUSTER, P2
#119	7-627-556-58	SCREW +P 2.6X5

## Overall Section 2

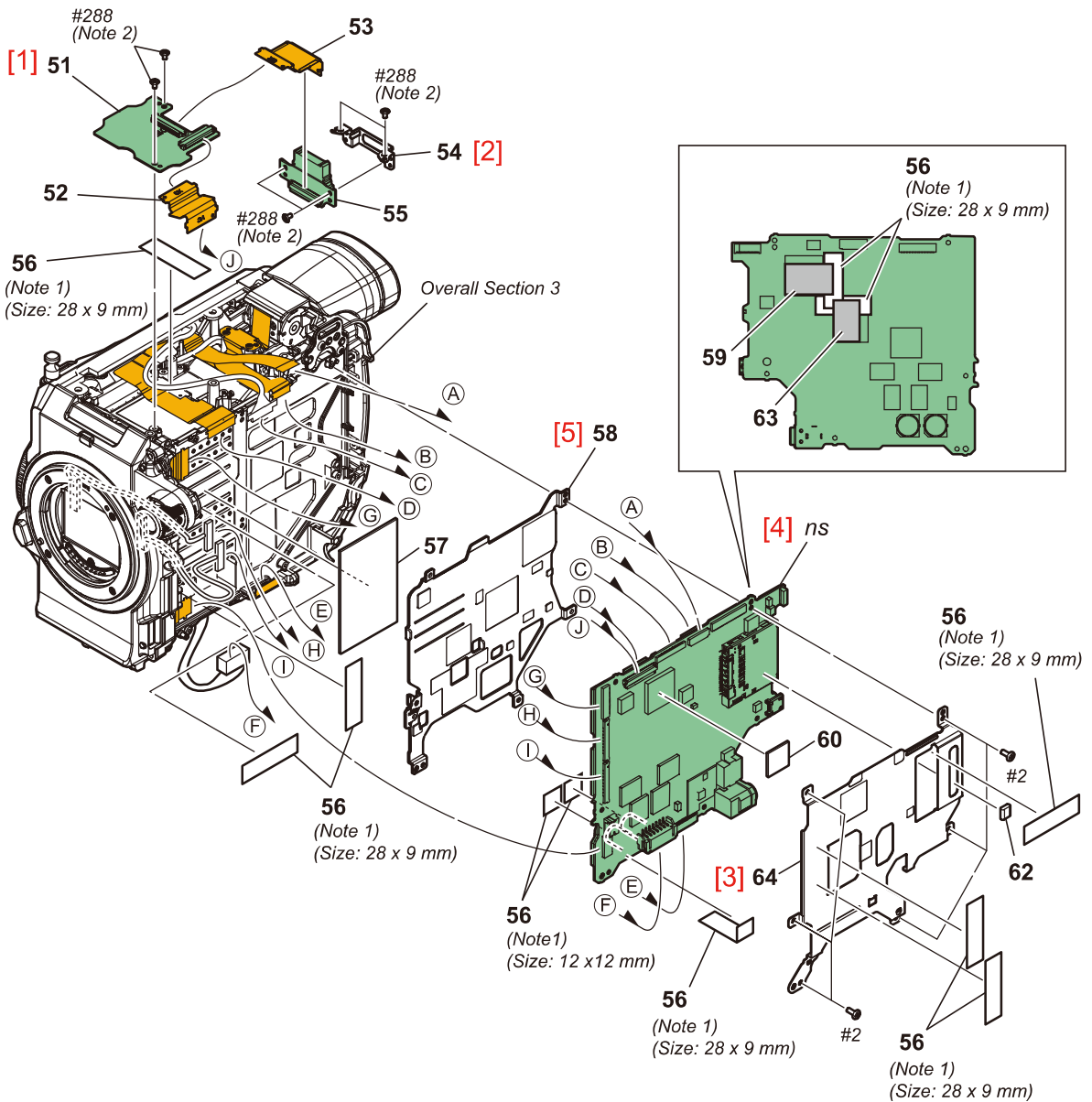

Ref. No. or Q'ty	Part No.	SP Description
51	A-2076-332-A	CK-1015 BOARD, COMPLETE
52	1-894-946-11	FP-2332 FLEXIBLE BOARD
53	1-894-947-11	FP-2333 FLEXIBLE BOARD
54	4-576-397-01	PLATE, HANDLE CONNECTOR
55	A-2076-340-A	HN-1017 BOARD, COMPLETE
56	4-446-014-01	TAPE AS (2040)
57	4-579-201-01	SHEET (MF), RADIATION
58	4-576-459-01	HEAT SINK (B), VC
59	4-579-202-01	SHEET (L), VC RADIATION
60	4-579-203-01	SHEET (M), VC RADIATION
62	4-534-480-01	BM, GASKET
63	4-587-491-01	SHEET (MT), VC RADIATION

Ref. No. or Q'ty	Part No.	SP Description
64	4-576-458-01	HEAT SINK (A), VC
#2	2-635-562-31	SCREW (M1.7)
#288	2-187-345-21	SCREW (M1.7), P2

### Overall Section 3

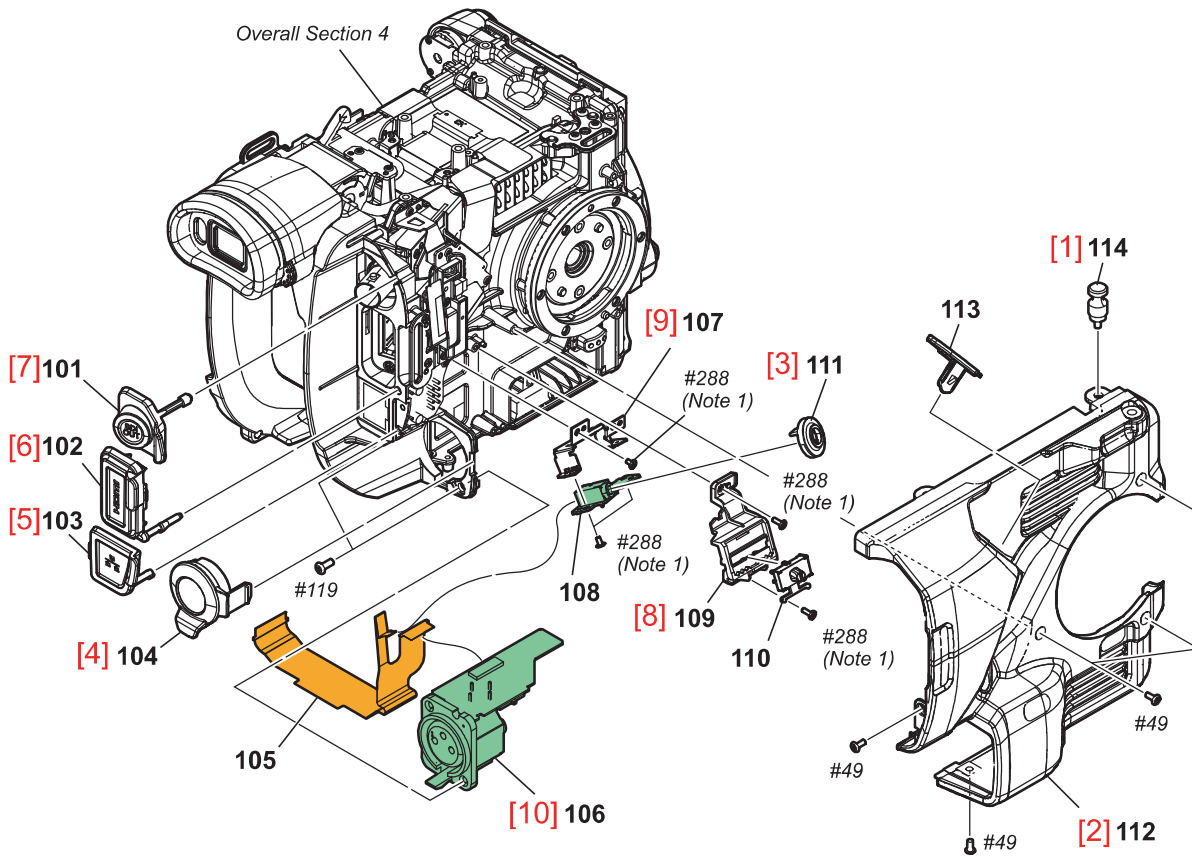

Ref. No. or Q'ty	Part No.	SP Description
101	4-576-203-01	COVER (S), TERMINAL
102	4-576-204-01	COVER (H), TERMINAL
103	4-576-205-01	COVER (L), TERMINAL
104	4-576-206-01	COVER (X), TERMINAL
105	1-894-953-11	FP-2339 FLEXIBLE BOARD
106	A-2076-337-A	XL-1006 BOARD, COMPLETE
107	4-576-222-01	PLATE, LANC
108	A-2076-345-A	LC-1032 BOARD, COMPLETE
109	4-576-214-01	BASE, XLR SWITCH
110	4-576-213-01	SWITCH, XLR
111	4-576-217-01	HOLDER (O), LANC
112	4-576-211-01	CABINET, OUT SIDE
113	4-576-216-01	COVER (V), TERMINAL
114	4-269-040-01	HOOK, MEGEYAR
#49	2-630-005-31	SCREW (M2), NEW TRUSTER, P2

Ref. No. or Q'ty	Part No.	SP Description
#119	7-627-556-58	SCREW +P 2.6X5
#288	2-187-345-21	SCREW (M1.7), P2

### Overall Section 4

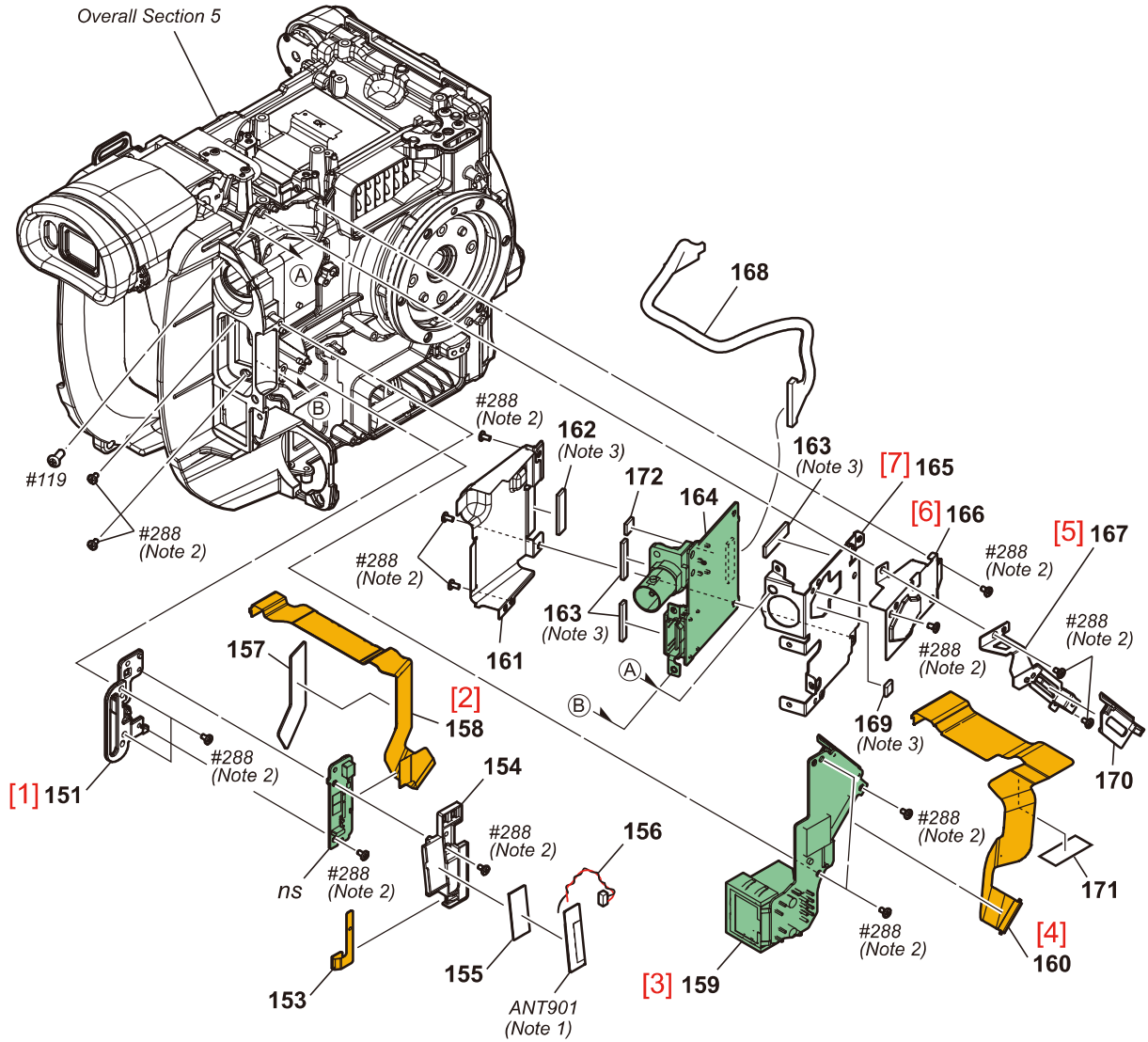

Ref. No. or Q'ty	Part No.	SP Description	Ref. No. or Q'ty	Part No.	SP Description
151	4-576-202-01	CLAMPER BT	167	4-576-221-01	PLATE, VF
153	1-889-592-11	AN-1006 FLEXIBLE BOARD	168	1-965-937-31	HARNESS (COAXIAL CABLE)
154	4-576-212-01	HOLDER WIFI	169	4-534-480-01	BM, GASKET
155	4-489-010-01	SHEET (ANT), ADHESIVE	170	4-579-196-01	COVER, VF CONNECTOR
156	1-846-787-31	CABLE	171	4-587-354-01	SPACER, VF FLEXIBLE
157	4-583-915-01	WF SPACER	172	4-587-355-01	SHEET (SD), RADIATION
158	1-894-948-11	FP-2334 FLEXIBLE BOARD	ANT901	A-2079-995-A	SERVICE, NFC INDIVIDUAL
159	A-2076-335-A	VF-1016 BOARD, COMPLETE			
160	1-894-949-11	FP-2335 FLEXIBLE BOARD			
161	4-576-219-01	PLATE (UPPER), HS	#119	7-627-556-58	SCREW +P 2.6X5
162	4-576-223-01	GASKET (L)	#288	2-187-345-21	SCREW (M1.7), P2
163	4-279-310-11	GASKET, USB BOTTOM			
164	A-2076-334-A	HS-1006 BOARD, COMPLETE			
165	4-576-218-01	PLATE (LOWER), HS			
166	4-576-220-01	CASE, HS SHIELD			

## Overall Section 5

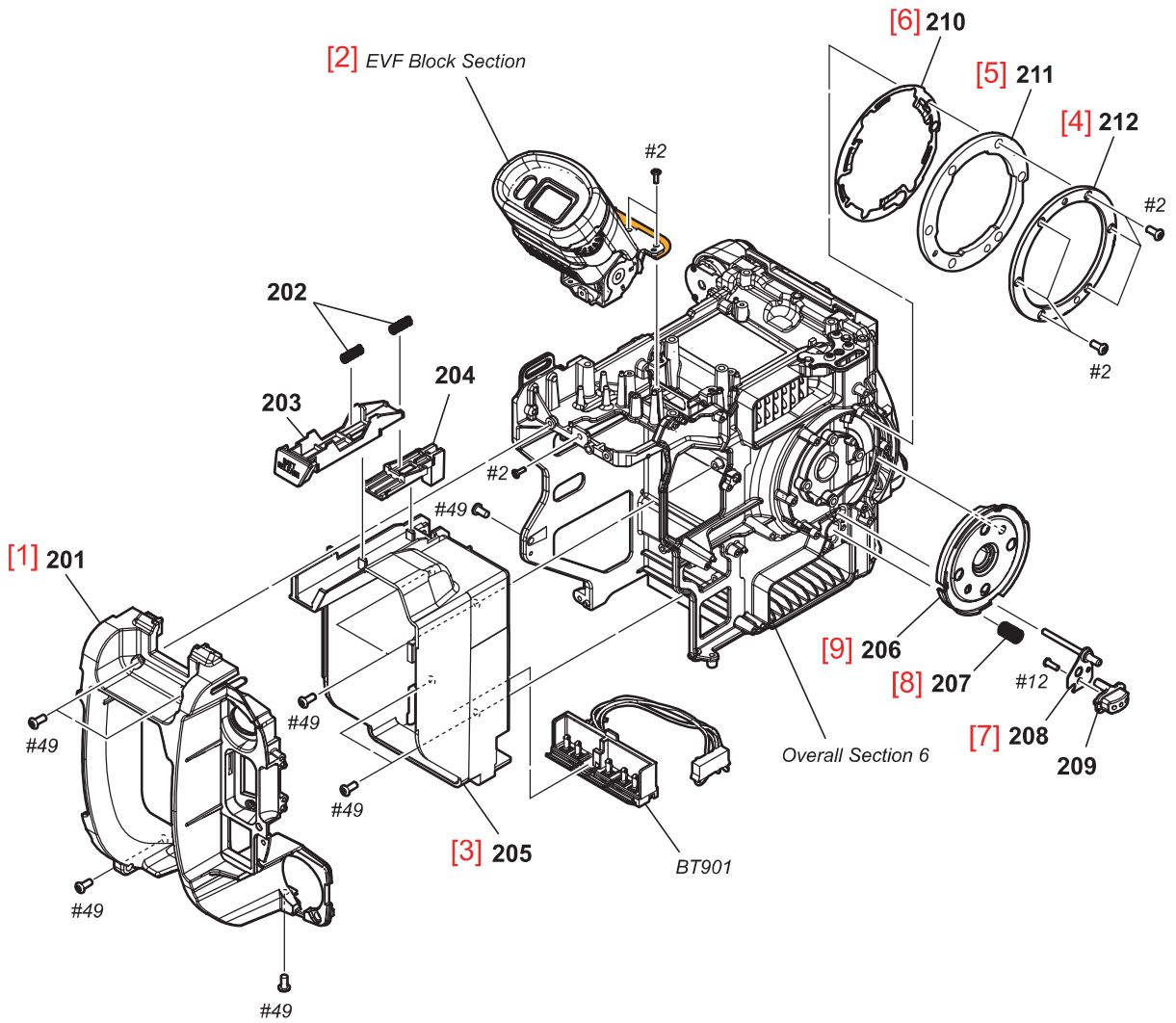

Ref. No. or Q'ty	Part No.	SP Description
201	4-576-198-01	CABINET REAR
202	4-165-273-01	SPRING, BT RELEASE
203	4-576-200-01	BT RELEASE BUTTON
204	4-576-201-01	LOCK, BT RELEASE
205	4-576-199-01	PANEL, BT
206	4-576-460-01	COVER, GRIP BASE
207	4-546-545-01	IM LENS LOCK SPRING
208	X-2591-961-1	PIN ASSY, GF MOUNT LOCK
209	4-576-423-01	BUTTON, GRIP RELEASE
210	4-576-421-01	SPRING, GRIP MOUNT
211	4-576-422-01	RETAINER, GRIP
212	4-576-420-02	RING, GRIP MOUNT
BT901	▲ 1-780-986-11	TERMINAL BOARD, BATTERY
#2	2-635-562-31	SCREW (M1.7)
#12	3-080-204-21	SCREW, TAPPING, P2
#49	2-630-005-31	SCREW (M2), NEW TRUSTER, P2



Overall Section 6

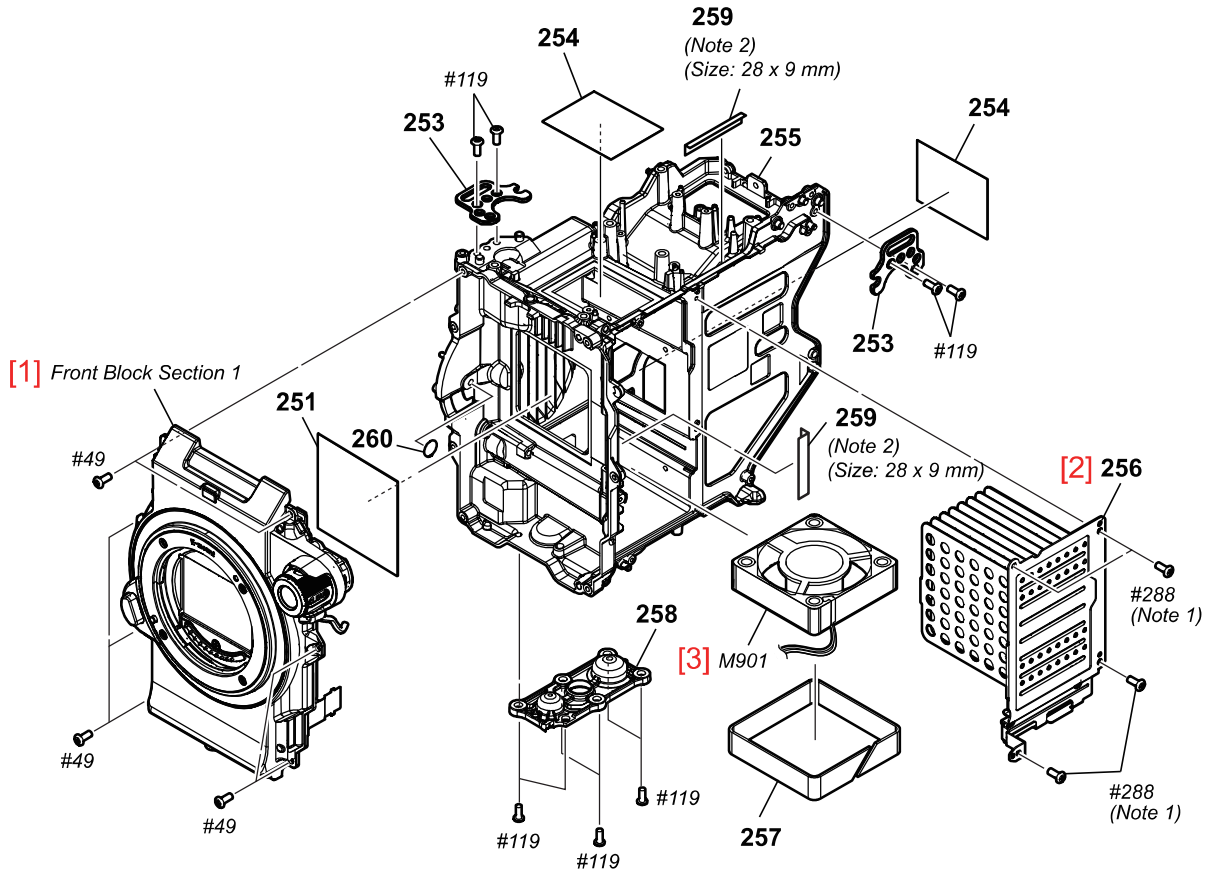

Ref. No. or Q'ty	Part No.	SP Description
251	4-579-207-01	SHEET (MF), L
253	4-576-415-01	BRACKET (IN), BELT
254	4-579-208-01	SHEET (MF), S
255	4-576-412-01	FRAME, MAIN
256	X-2591-960-1	FIN ASSY, VC RADIATION
257	4-576-416-01	HOLDER, FAN
258	4-576-418-11	SCREW, TRIPOD
259	4-446-014-01	TAPE AS (2040)
260	4-546-540-01	IM MOUNT TAPE
M901	⚠ 1-855-369-11	DC FAN
#49	2-630-005-31	SCREW (M2), NEW TRUSTER, P2
#119	7-627-556-58	SCREW +P 2.6X5
#288	2-187-345-21	SCREW (M1.7), P2

### Grip Block Section 1

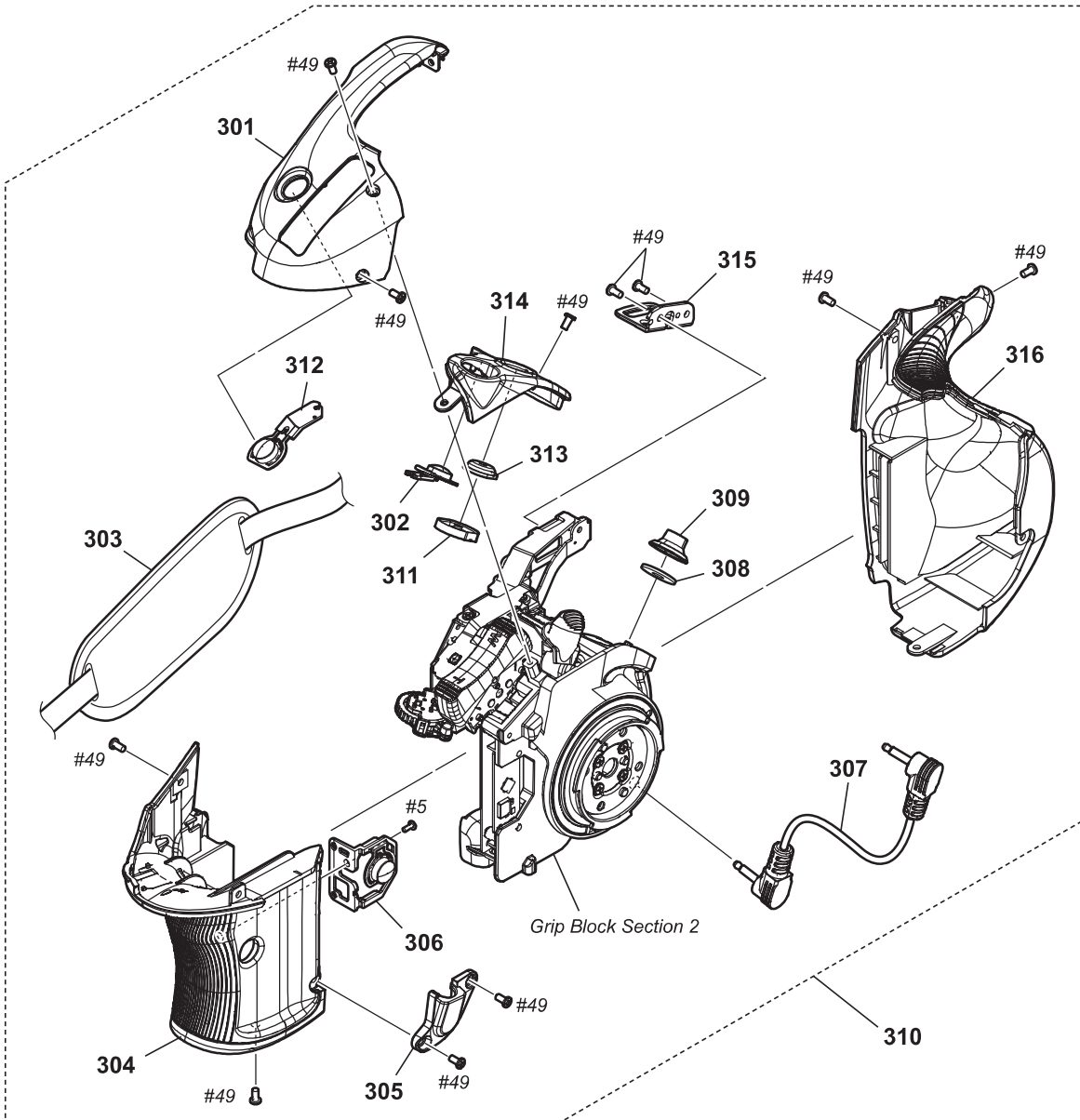

Ref. No. or Q'ty	Part No.	SP Description	Ref. No. or Q'ty	Part No.	SP Description
301	4-576-349-01	TOP COVER, GRIP	#5	3-080-204-01	SCREW, TAPPING, P2
302	4-576-358-01	BUTTON, ASSIGN 5	#49	2-630-005-31	SCREW (M2), NEW TRUSTER, P2
303	4-541-719-11	BELT (913), GRIP			
304	X-2591-958-1	COVER ASSY (FRONT), GRIP			
305	4-576-513-01	COVER (G), LANC			
306	4-576-359-01	BUTTON, ASSIGN 6			
307	1-849-162-11	CONNECTION CABLE (LANC)			
308	4-541-676-01	SHEET (G), MUFFLE			
309	4-544-480-01	JOYSTICK			
310	A-2081-877-A	G BLOCK ASSY			
311	4-269-121-01	RUBBER, SS BUTTON			
312	4-576-357-01	BUTTON, ASSIGN 4			
313	4-576-356-01	BUTTON (GRIP), REC			
314	4-576-351-01	COVER, GRIP BUTTON			
315	4-576-370-01	BRACKET (LOWER), GRIP BELT			
316	X-2591-957-1	COVER ASSY (REAR), GRIP			

## Grip Block Section 2

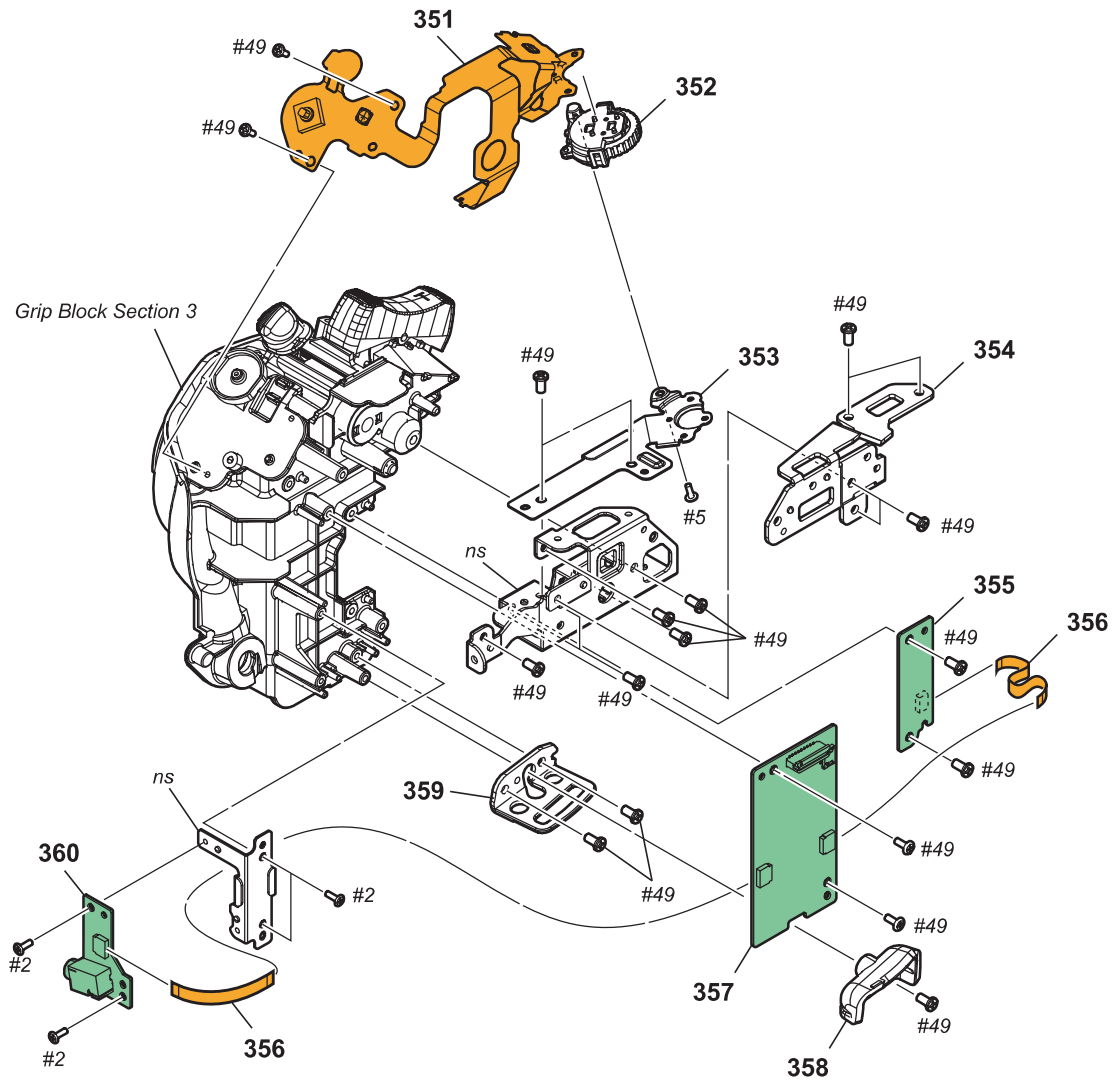

Ref. No. or Q'ty	Part No.	SP Description
351	A-2076-368-A	FP-2328 FLEXIBLE BOARD, COMPLETE
352	X-2590-703-3	DIAL ASSY (786), CONT
353	4-576-365-01	RETAINER, SS
354	4-576-369-01	BRACKET (UPPER), GRIP BELT
355	A-2076-349-A	SW-1022 BOARD, COMPLETE
356	1-836-006-11	FLEXIBLE FLAT CABLE (FFC-172)
357	A-2076-343-A	CT-1001 BOARD, COMPLETE
358	4-576-350-01	COVER (BOTTOM), GRIP
359	4-576-370-01	BRACKET (LOWER), GRIP BELT
360	A-2087-121-A	CN-1044 BOARD, COMPLETE
#2	2-635-562-31	SCREW (M1.7)
#5	3-080-204-01	SCREW, TAPPING, P2
#49	2-630-005-31	SCREW (M2), NEW TRUSTER, P2

### Grip Block Section 3

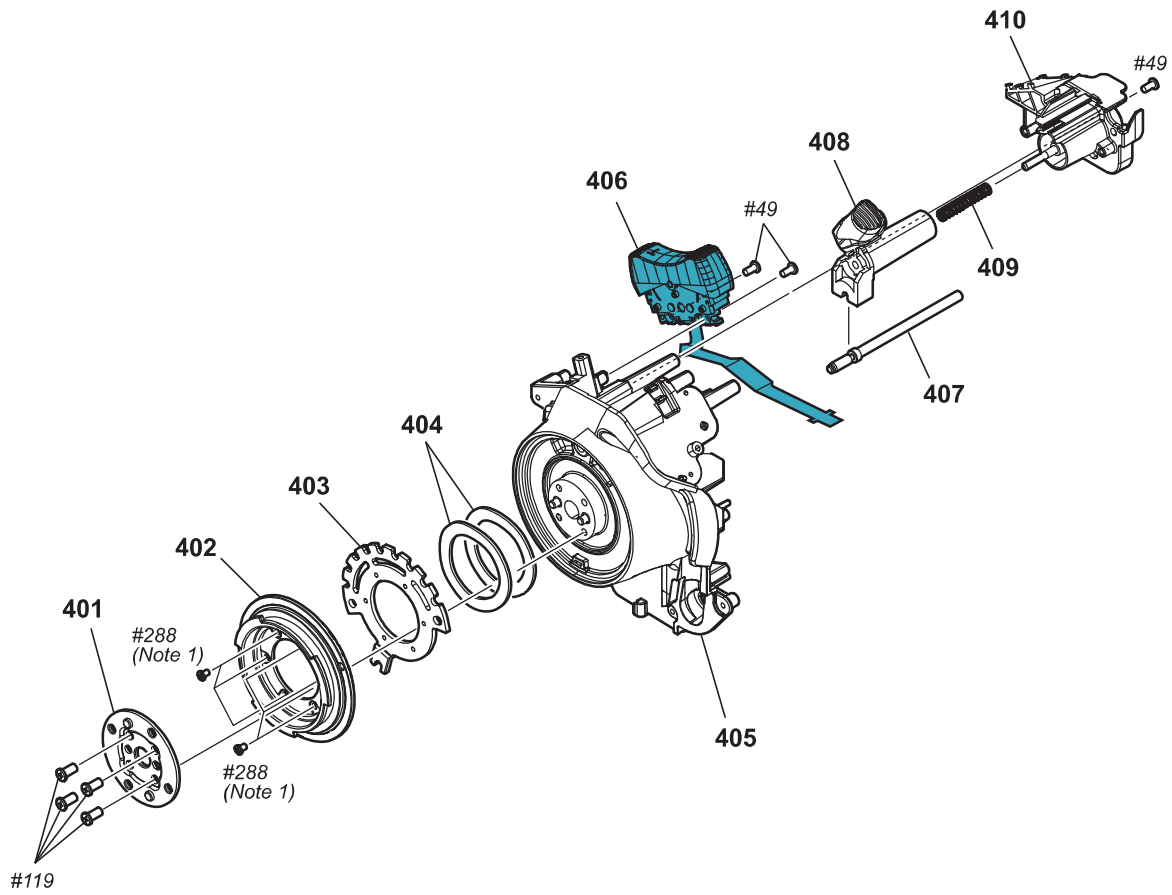

Ref. No. or Q'ty	Part No.	SP Description
401	4-576-362-01	RETAINER, DISK
402	4-576-363-01	MOUNT, GRIP
403	4-576-361-01	DISK, ROTARY
404	7-623-711-07	WASHER 20, WAVE
405	4-576-340-01	CHASSIS, GRIP
406	1-490-411-11	SWITCH BLOCK, CONTROL (PZ96000)
407	4-576-360-01	PIN, ROTARY LOCK
408	4-576-354-01	LEVER, ROTARY LOCK
409	4-478-009-01	SPRING, PAD LOCK
410	4-576-353-01	CASE, LOCK PIN
#49	2-630-005-31	SCREW (M2), NEW TRUSTER, P2
#119	7-627-556-58	SCREW +P 2.6X5
#288	2-187-345-21	SCREW (M1.7), P2

### Inside Block Section 1

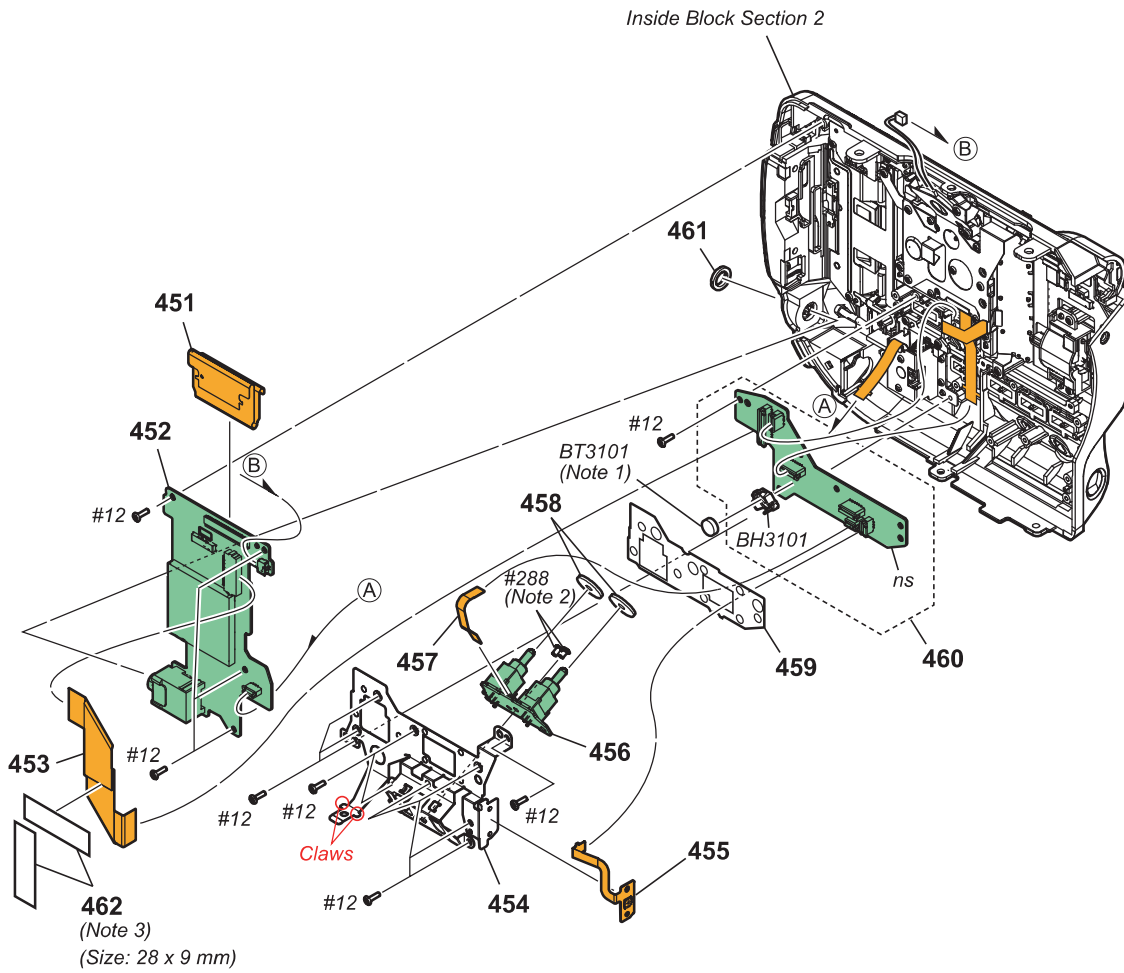

Ref. No. or Q'ty	Part No.	SP Description
451	1-894-951-11	FP-2337 FLEXIBLE BOARD
452	A-2076-341-A	SD-1006 BOARD, COMPLETE
453	1-849-143-11	FLEXIBLE FLAT CABLE (FFC-1074)
454	4-576-334-01	BRACKET, TG
455	A-2076-369-A	FP-2330 FLEXIBLE BOARD, COMPLETE
456	A-2076-346-A	TG-1004 BOARD, COMPLETE
457	1-836-006-11	FLEXIBLE FLAT CABLE (FFC-172)
458	4-547-022-11	CUSHION (SW), WATERPROOF
459	4-584-012-01	SHEET (KY), INSULATING
460	A-2076-344-A	KY-1012 BOARD, COMPLETE
461	3-061-234-01	NUT (M6X0.5)
462	4-446-014-01	TAPE AS (2040)
BH3101	1-251-928-21	SOCKET, BATTERY
BT3101	1-756-135-32	BATTERY LITHIUM SECONDARY
#12	3-080-204-21	SCREW, TAPPING, P2
#288	2-187-345-21	SCREW (M1.7), P2

### Inside Block Section 2

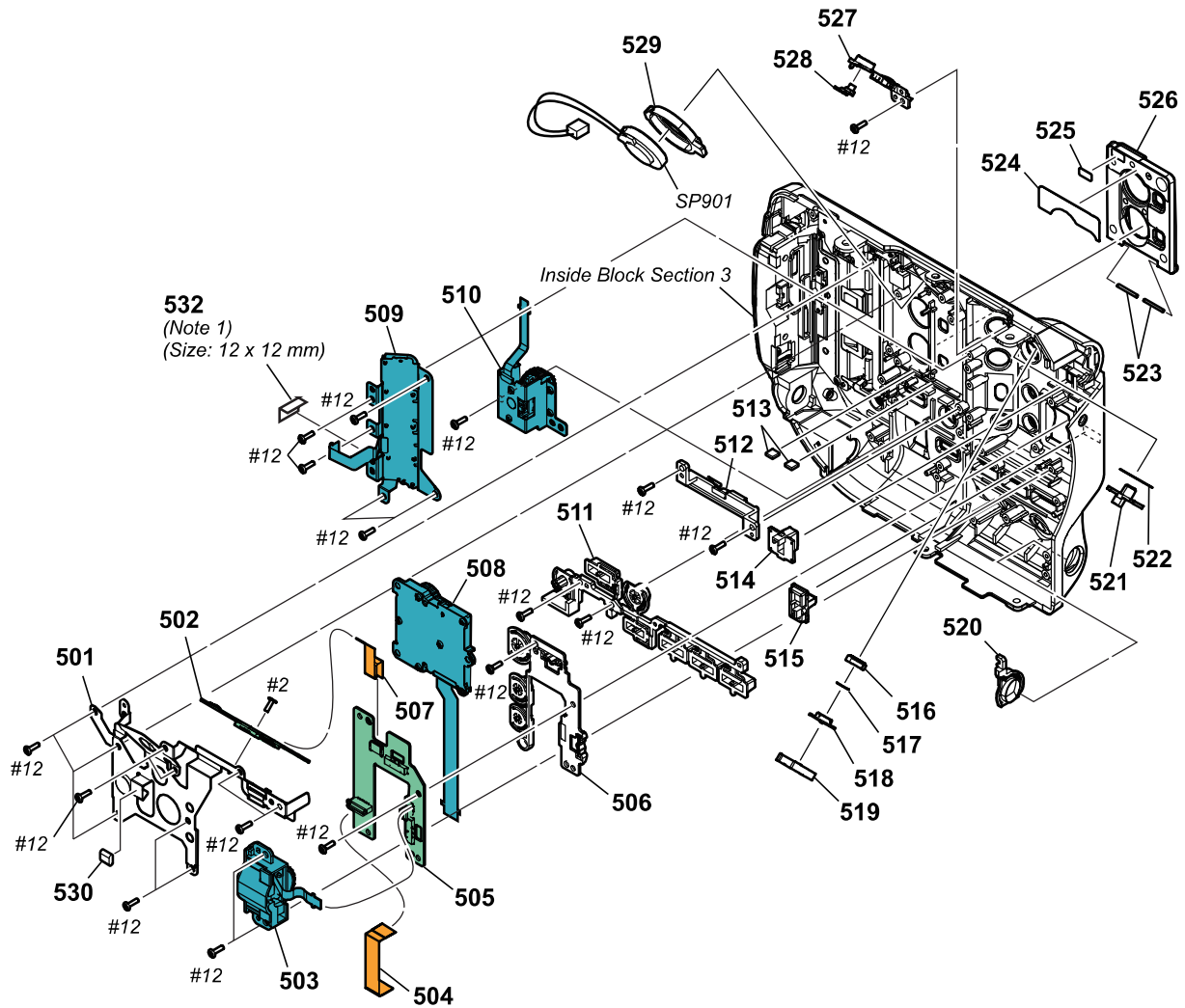

Ref. No. or Q'ty	Part No.	SP Description	Ref. No. or Q'ty	Part No.	SP Description
501	4-576-331-01	BRACKET, XS	520	4-576-316-01	BUTTON, WB
502	A-2076-348-A	XS-1001 BOARD, COMPLETE	521	4-576-310-01	SWITCH, HOLD
503	1-492-897-11	SWITCH BLOCK CONTROL (ID94100)	522	4-579-198-01	SHEET, HOLD
504	1-839-086-11	CABLE, FLEXIBLE FLAT (FFC-256)	523	4-165-324-01	SHAFT, AL
505	A-2076-347-A	NI-1001 BOARD, COMPLETE	524	4-579-199-01	SHEET, AU MAGNET
506	4-576-314-01	BUTTON, ASSIGN	525	4-576-332-01	PLATE, MAGNET
507	1-838-558-11	CABLE, FLEXIBLE FLAT (FFC-254)	526	4-576-327-01	LID, AU
508	1-493-063-11	SWITCH BLOCK, CONTROL (AU96400)	527	4-576-311-01	BUTTON, FULL AUTO
509	1-493-064-11	SWITCH BLOCK, CONTROL (ICS96400)	528	4-576-324-01	LIGHT, FULL AUTO GUIDE
510	1-492-342-21	SWITCH BLOCK, CONTROL (KP50080)	529	2-178-550-01	HOLDER, SPEAKER
511	4-576-317-01	BUTTON, MENU	530	4-534-480-01	BM, GASKET
512	4-576-328-01	BASE, AU	532	4-446-014-01	TAPE AS (2040)
513	4-547-150-01	SHEET (941), RUBBER	SP901	1-858-706-21	LOUDSPEAKER (1.8CM)
514	4-576-312-01	KNOB, PRESET	#2	2-635-562-31	SCREW (M1.7)
515	4-576-313-01	KNOB, ND	#12	3-080-204-21	SCREW, TAPPING, P2
516	4-576-335-01	BUTTON, REC			
517	4-576-339-01	SHEET, REC BUTTON ADHESIVE			
518	4-576-309-01	BASE, REC BUTTON			
519	4-269-121-01	RUBBER, SS BUTTON			

**Inside Block Section 3**

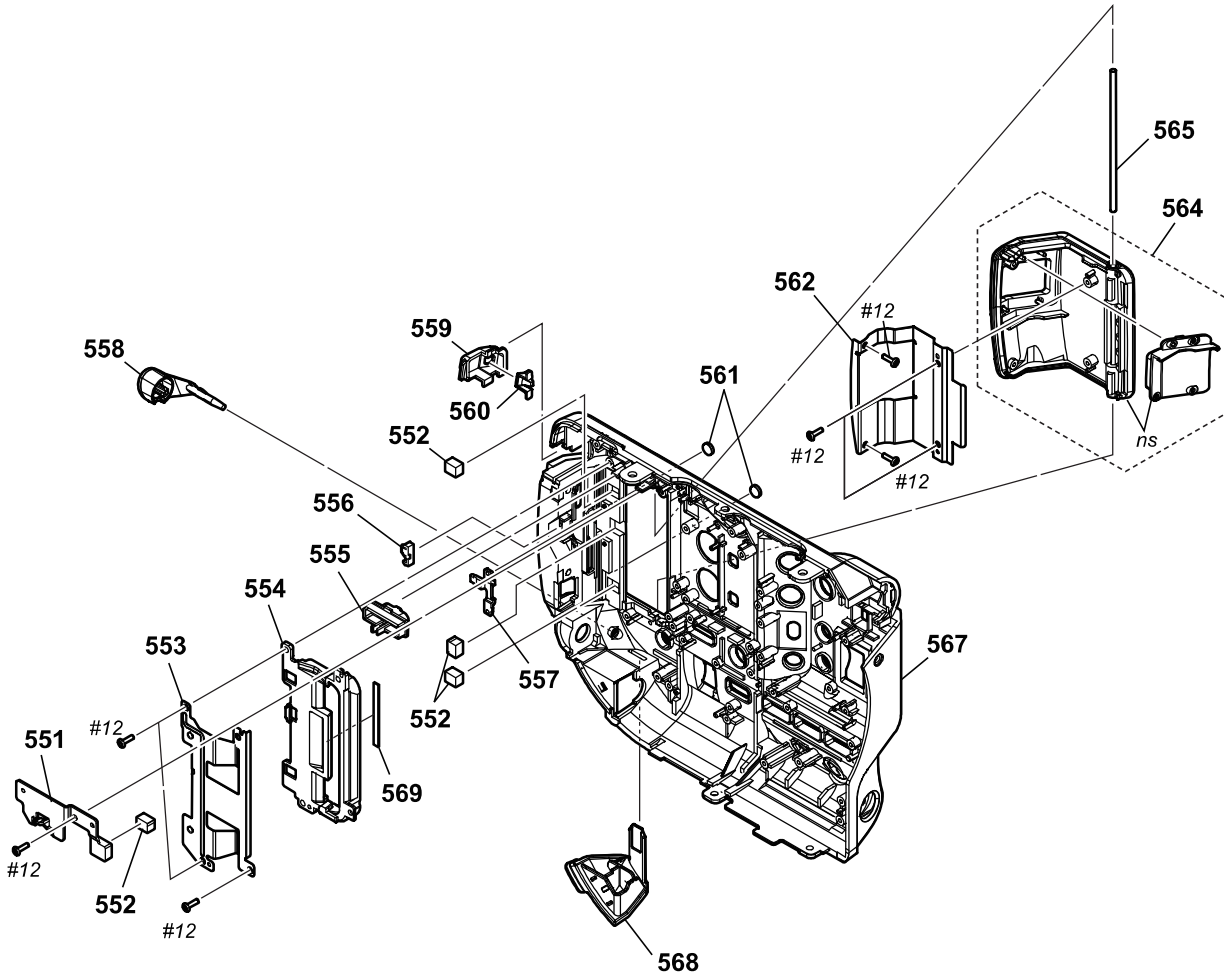

Ref. No. or Q'ty	Part No.	SP Description
551	4-576-511-01	GUIDE, POWER SWITCH
552	1-471-573-11	MAGNET
553	4-576-330-01	SPRING, MEDIA LID CLICK
554	4-576-308-01	RETAINER, MEDIA LID
555	4-576-318-01	SWITCH, POWER
556	4-576-323-01	LIGHT, VC GUIDE
557	4-576-322-01	LIGHT, SD GUIDE
558	4-576-319-01	LID, HP
559	4-576-325-01	WINDOW, IR
560	4-576-321-01	LIGHT, TALLY GUIDE
561	4-579-200-01	CUSHION, MD
562	4-577-102-01	PLATE (MD), MAGNET
564	A-2179-168-A	SERVICE, MD LID ASSY (PXW-FS5/ F55K)
	A-2224-298-A	SERVICE, MD LID ASSY (PXW-FS5M2/ F55M2K)
565	4-576-338-01	SHAFT, LID HINGE
567	4-576-306-01	CABINET, IN SIDE
568	4-576-320-01	LID, DC
569	4-587-356-01	CUSHION, MEDIA LID RETAINER
#12	3-080-204-21	SCREW, TAPPING, P2

### LCD Block Section

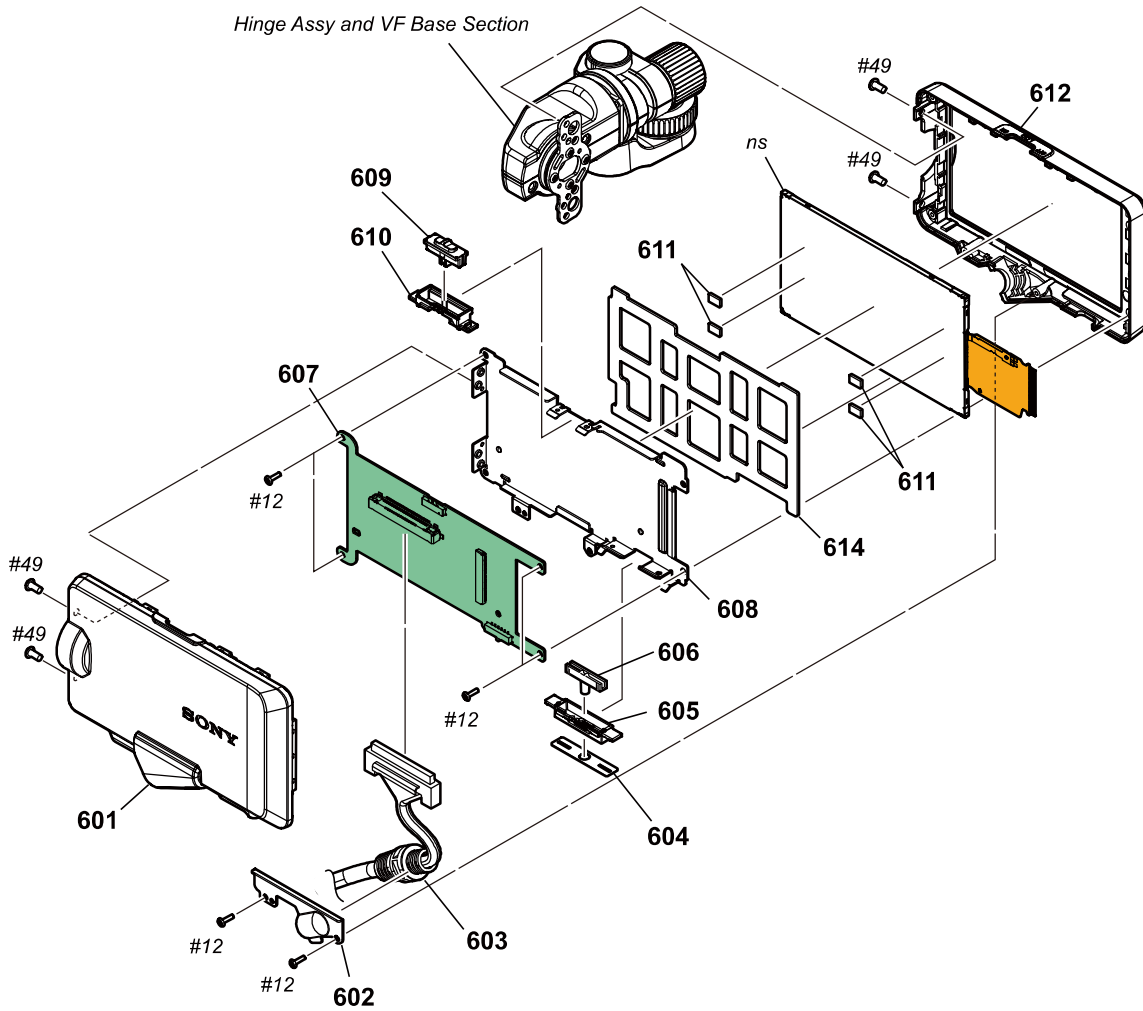

Ref. No. or Q'ty	Part No.	SP Description	Ref. No. or Q'ty	Part No.	SP Description
601	4-576-373-01	CABINET (C), P	#49	2-630-005-31	SCREW (M2), NEW TRUSTER, P2
602	4-577-103-01	BRACKET, VF CABLE			
603	1-848-672-13	CABLE, CONNECTION			
604	4-579-432-01	SHEET, SELECTION (SW)			
605	4-576-382-01	BASE, SELECTION (SW)			
606	4-576-381-01	SELECTION (SW)			
607	A-2087-120-A	PD-1046 BOARD, COMPLETE			
608	4-576-371-01	FRAME, PD			
609	4-583-117-01	LCD SW KNOB			
610	4-583-118-01	LCD SW BASE			
611	4-535-706-01	ESD GASKET			
612	4-576-372-01	CABINET (M), P			
614	4-583-883-02	CUSHION (964), LCD			
#12	3-080-204-21	SCREW, TAPPING, P2			



### Hinge Assy and VF Base Section

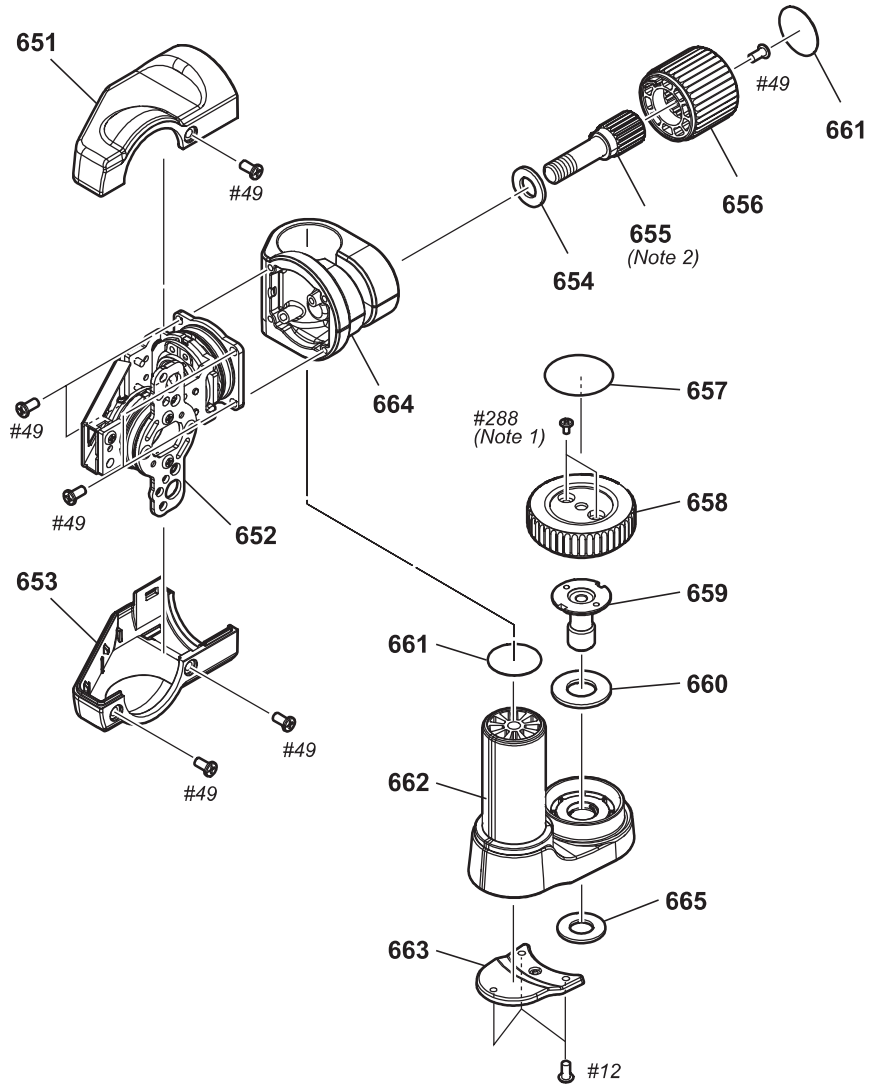

Ref. No. or Q'ty	Part No.	SP Description
651	4-576-375-01	COVER (O), HINGE
652	X-2591-959-1	HINGE (964) ASSY
653	4-576-374-01	COVER (U), HINGE
654	7-688-005-11 *	W 5, MIDDLE
655	4-576-380-01	SHAFT, HANDLE CLAMP
656	4-576-379-01	KNOB, HANDLE CLAMP
657	4-587-493-01	SHEET (964), HANDLE SHAFT
658	4-583-369-01	KNOB, VF FIXED
659	4-576-378-01	SCREW, VF BASE FIXED
660	7-688-006-11 *	W 6, MIDDLE
661	4-583-371-01	SHEET, VF BASE
662	4-576-376-01	BASE, VF
663	4-583-370-01	COVER, VF BASE

Ref. No. or Q'ty	Part No.	SP Description
664	4-576-377-01	HOLDER, CLAMP
665	4-587-495-01	POLY-SLIDER (964)
#12	3-080-204-21	SCREW, TAPPING, P2
#49	2-630-005-31	SCREW (M2), NEW TRUSTER, P2
#288	2-187-345-21	SCREW (M1.7), P2

**EVF Block Section**

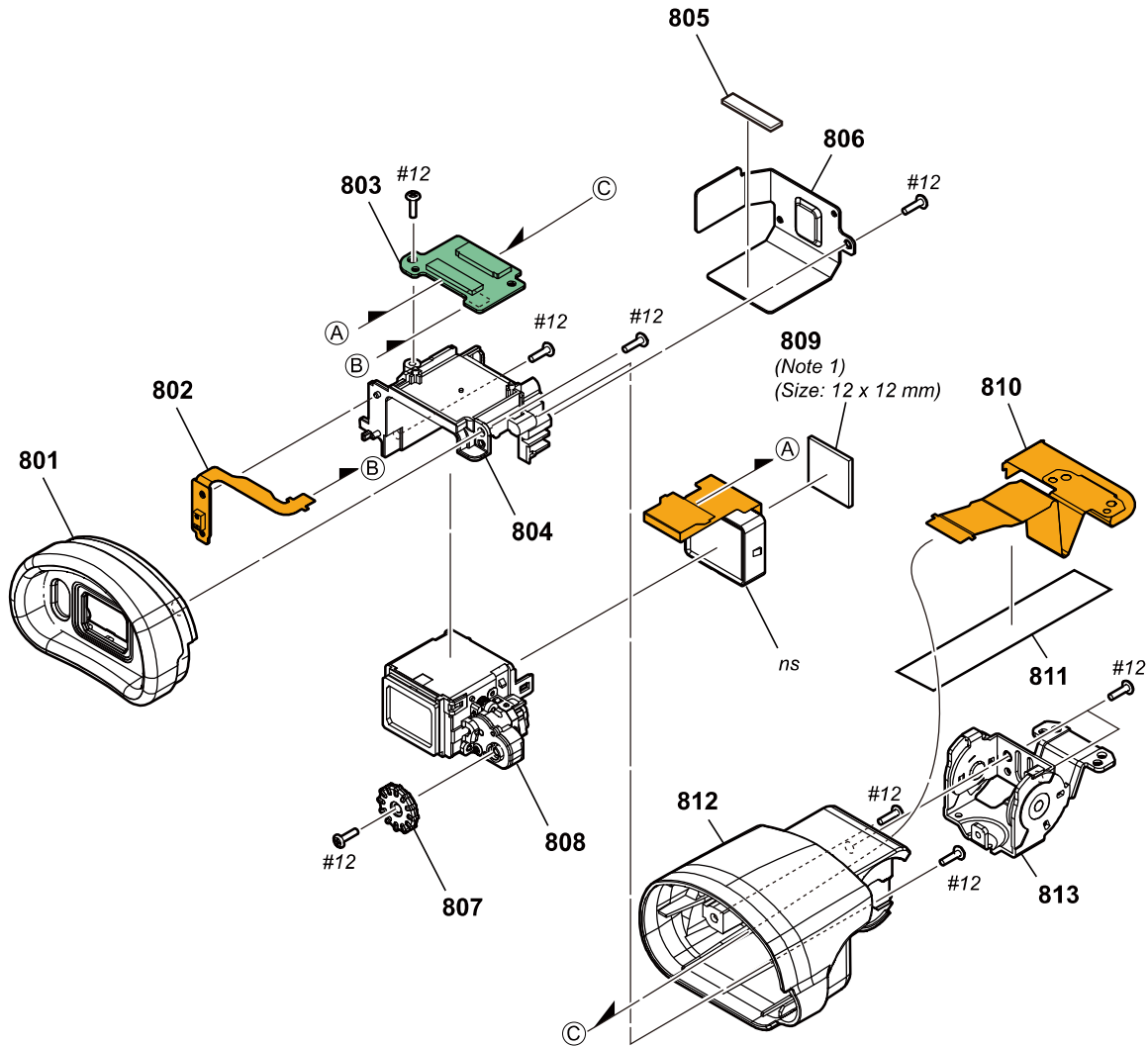

Ref. No. or Q'ty	Part No.	SP Description
801	4-533-013-01	EYE CUP
802	A-2076-370-A	FP-2347 FLEXIBLE BOARD, COMPLETE
803	A-2076-336-A	EV-1014 BOARD, COMPLETE
804	4-576-207-01	HOLDER, VF
805	4-578-351-01	CUSHION, HANDLE CONNECTOR
806	4-576-209-01	HEAT SINK, VF
807	4-533-011-01	DIAL, DIOPTER
808	X-2588-236-1	VF UNIT ASSY
809	4-533-041-01	SHEET (L), VC RADIATION
810	1-894-950-11	FP-2336 FLEXIBLE BOARD
811	4-576-210-01	TAPE (VF)
812	4-576-208-01	CABINET, VF
813	X-2549-590-1	HINGE ASSY, VF
#12	3-080-204-21	SCREW, TAPPING, P2



## Handle Block Section 2

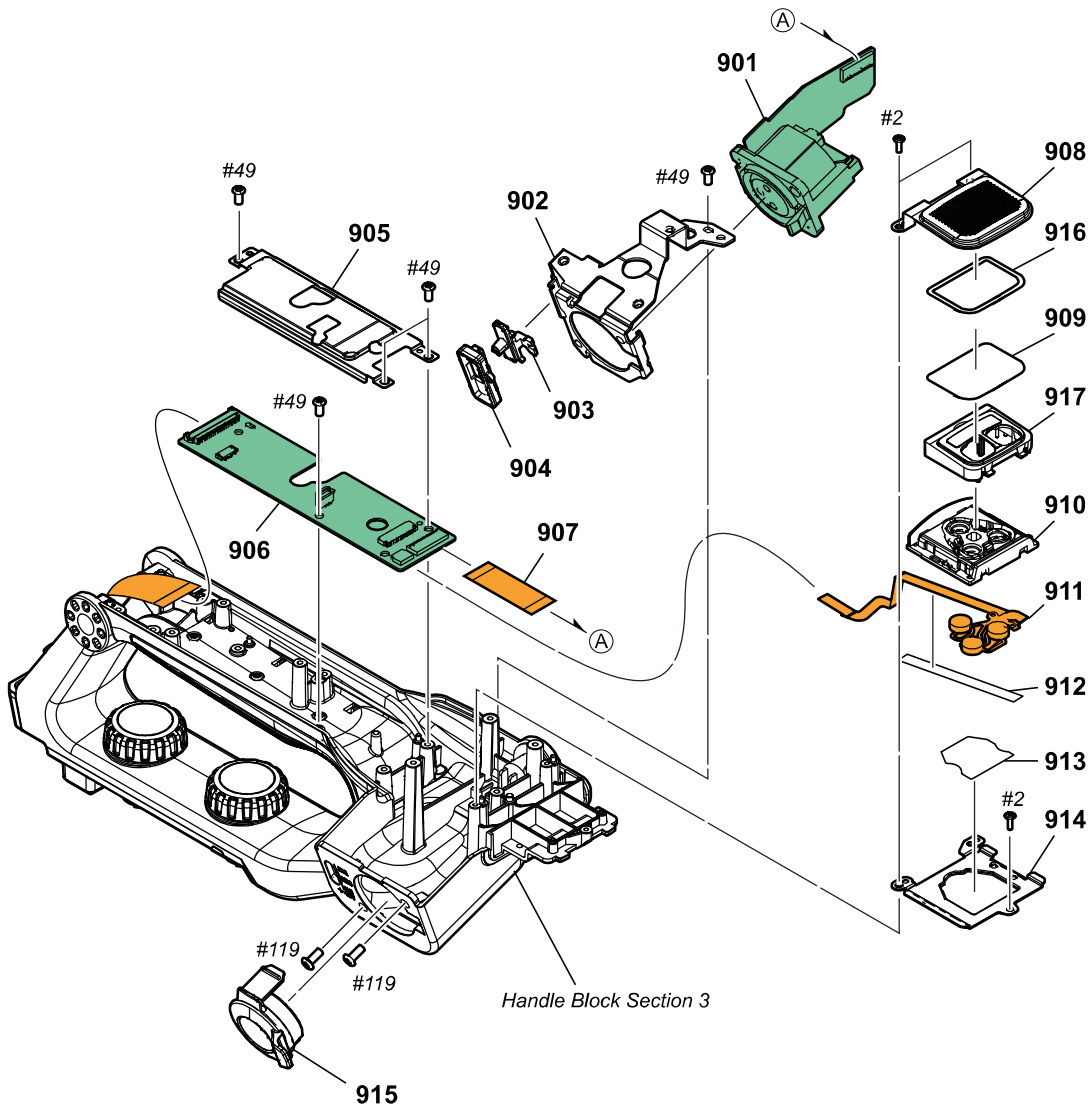

Ref. No. or Q'ty	Part No.	SP Description	Ref. No. or Q'ty	Part No.	SP Description
901	A-2076-339-A	XR-1001 BOARD, COMPLETE	917	4-576-394-01	MOLD, MICROPHONE INNER
902	4-576-399-01	BRACKET, HANDLE (XLR)	#2	2-635-562-31	SCREW (M1.7)
903	4-576-392-01	SWITCH, XLR SLIDE	#49	2-630-005-31	SCREW (M2), NEW TRUSTER, P2
904	4-576-393-01	BASE, XLR SLIDE	#119	7-627-556-58	SCREW +P 2.6X5
905	4-576-401-01	PLATE, HK SHIELD			
906	A-2076-338-A	HK-1001 BOARD, COMPLETE			
907	1-834-809-11	CABLE, FLEXIBLE FLAT (FFC-338)			
908	4-576-404-01	GRILLE, MICROPHONE			
909	4-576-405-01	SCREEN, WIND			
910	4-534-920-01	INSULATOR (470), MICROPHONE			
911	1-542-950-21	MICROPHONE UNIT			
912	4-583-917-01	CUSHION, MICROPHONE FLEXIBLE			
913	4-451-056-01	CUSHION, MICROPHONE			
914	4-576-406-01	FRAME, MICROPHONE			
915	4-576-206-01	COVER (X), TERMINAL			
916	4-578-348-01	SHEET, MICROPHONE			

### Handle Block Section 3

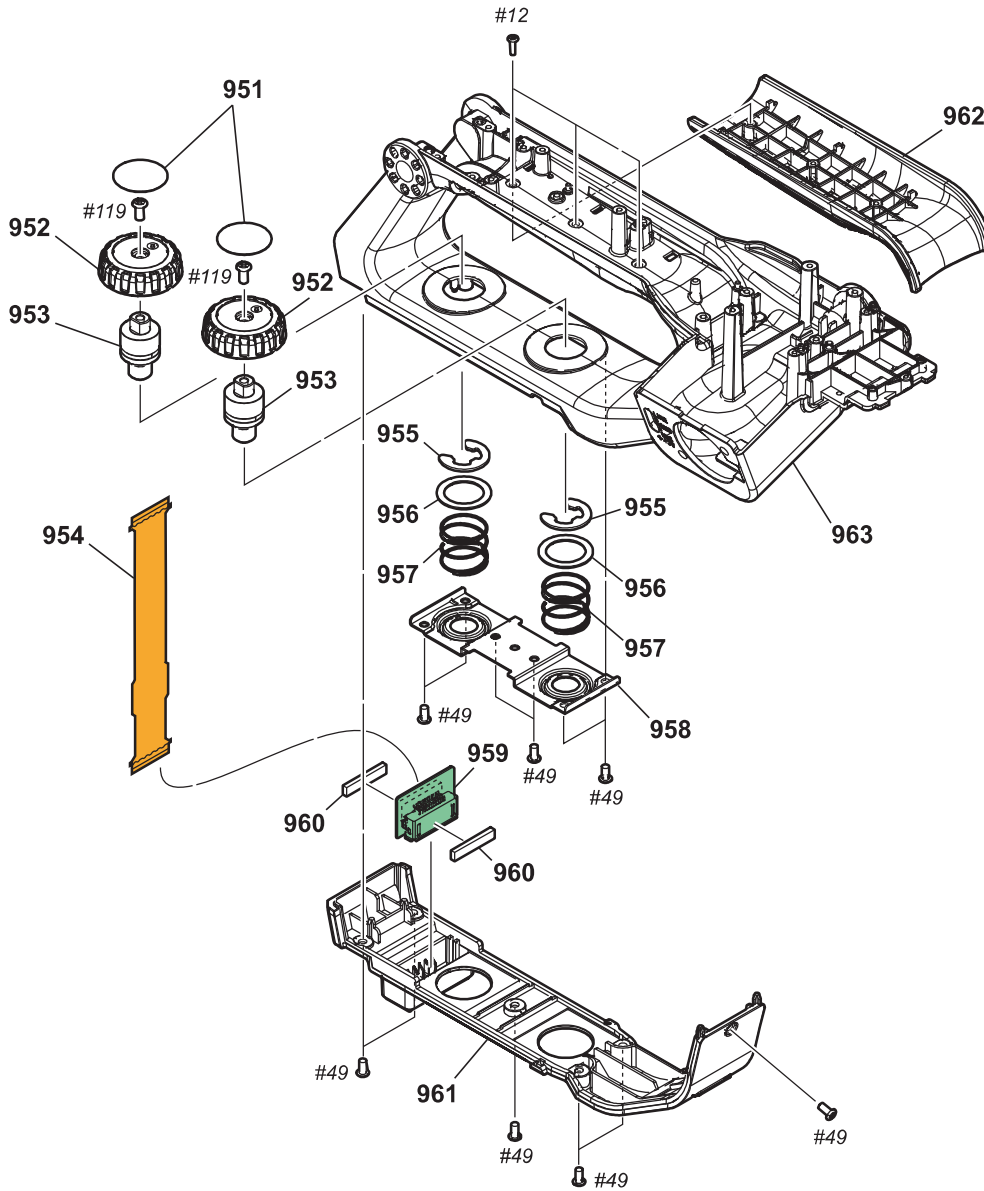

Ref. No. or Q'ty	Part No.	SP Description	Ref. No. or Q'ty	Part No.	SP Description
951	4-587-493-01	SHEET (964), HANDLE SHAFT	#49	2-630-005-31	SCREW (M2), NEW TRUSTER, P2
952	4-576-439-01	KNOB, HANDLE SHAFT	#119	7-627-556-58	SCREW +P 2.6X5
953	4-544-464-01	SHAFT, HANDLE			
954	1-894-954-11	FP-2340 FLEXIBLE BOARD			
955	7-624-111-04	STOP RING 7.0, TYPE -E			
956	4-544-461-01	PLATE, HANDLE SHAFT FIXED			
957	4-544-462-01	SPRING, HANDLE SHAFT			
958	4-576-403-01	PLATE, HANDLE (BOTTOM)			
959	A-2076-342-A	HC-1001 BOARD, COMPLETE			
960	4-578-351-01	CUSHION, HANDLE CONNECTOR			
961	4-576-390-01	COVER (LOWER), HANDLE			
962	4-576-395-01	GRIP, HANDLE			
963	4-576-388-01	HANDLE			
#12	3-080-204-21	SCREW, TAPPING, P2			

### 3-3. Accessories

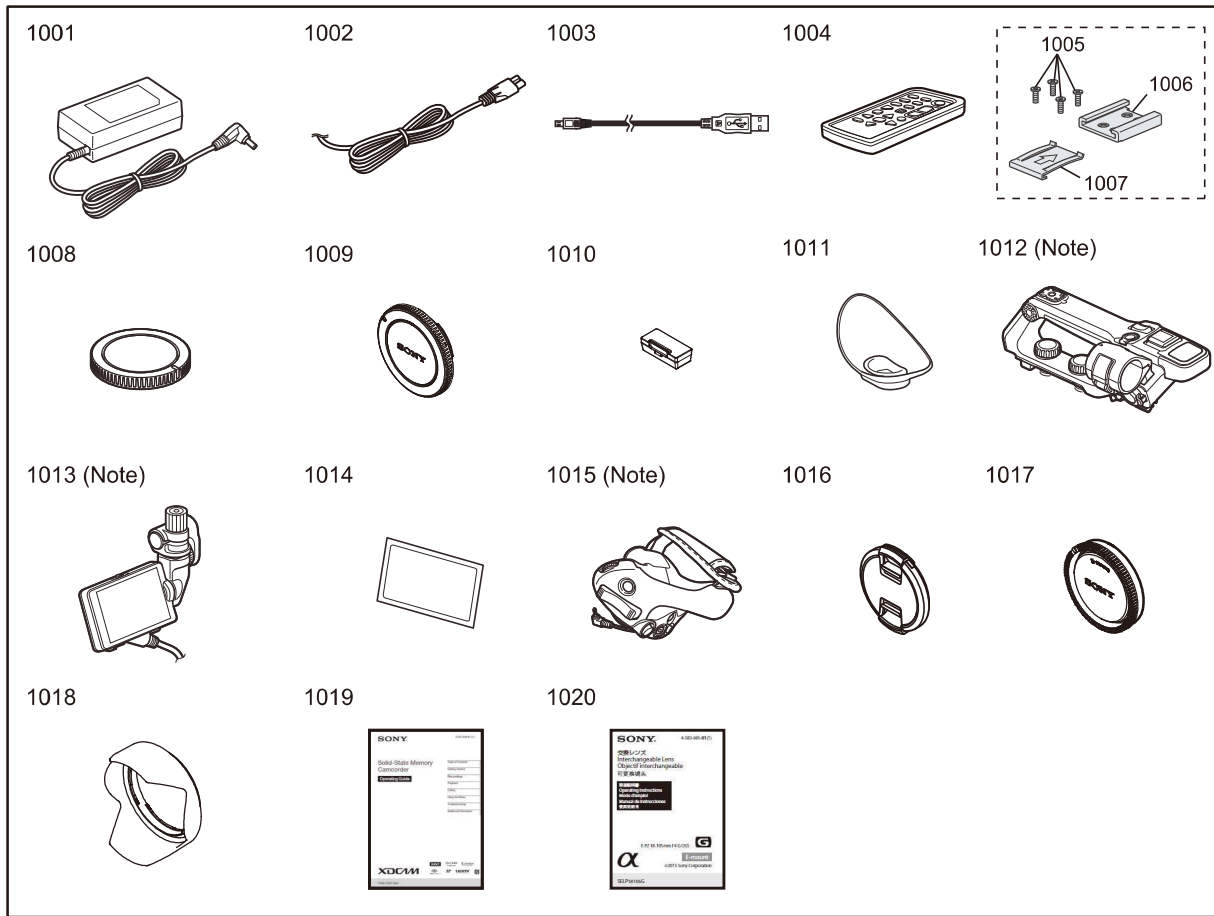

Ref. No. or Q'ty	Part No.	SP Description	Ref. No. or Q'ty	Part No.	SP Description
1001	⚠ 1-493-042-33	AC Adaptor (AC-UES1230)	1019	4-581-849-31 *	Operating Guide (FRENCH)
1002	⚠ 1-846-101-51	Power cord (mains lead) (UC)	1019	4-581-849-41 *	Operating Guide (GERMAN)
1002	⚠ 1-846-428-33	Power cord (mains lead) (CEE)	1019	4-581-849-51 *	Operating Guide (ITALIAN)
1002	⚠ 1-846-433-33	Power cord (mains lead) (CN1)	1019	4-581-849-61 *	Operating Guide (SPANISH)
1002	⚠ 1-848-066-31	Power cord (mains lead) (CEE)	1020	4-583-985-01 *	Operating Guide (JAPANESE, ENGLISH, FRENCH, SPANISH, SIMPLIFIED CHINESE) (PXW-FS5K/FS5M2K)
1003	1-846-615-12	USB cable	1020	4-583-985-11 *	Operating Guide (GERMAN, DUTCH, SWEDISH, ITALIAN, PORTUGUESE) (PXW-FS5K/FS5M2K)
1004	1-487-540-13	Wireless Remote Commander (RMT-845)			
1005	2-630-005-31	screws			
1006	3-069-286-03	Accessory shoe			
1007	3-288-615-02	Accessory shoe plate			
1008	4-188-536-01	Body cap			
1009	4-579-209-01	Grip attachment point cover			
1010	4-579-210-01	Handle connector protective cap			
1011	X-2590-187-1	Large eyecup			
1012	(Note)	XLR handle			
1013	(Note)	LCD screen			
1014	4-587-497-01	LCD screen protective sheet			
1015	(Note)	Grip			
1016	X-2582-127-1	Front lens cap (PXW-FS5K/FS5M2K)			
1017	4-159-701-03	Rear lens cap (PXW-FS5K/FS5M2K)			
1018	4-475-055-01	Lens hood (PXW-FS5K/FS5M2K)			
1019	4-581-849-11 *	Operating Guide (ENGLISH)			
1019	4-581-849-21 *	Operating Guide (SIMPLIFIED CHINESE)			

#### Note

- Refer to [“Handle Block Section 1”](#) for the XLR handle.
- Refer to [“LCD Block Section”](#) for the LCD screen.
- Refer to [“Grip Block Section 1”](#) for the Grip.

# Section 4 Frame Schematic Diagrams

## Frame Wiring (1/3)

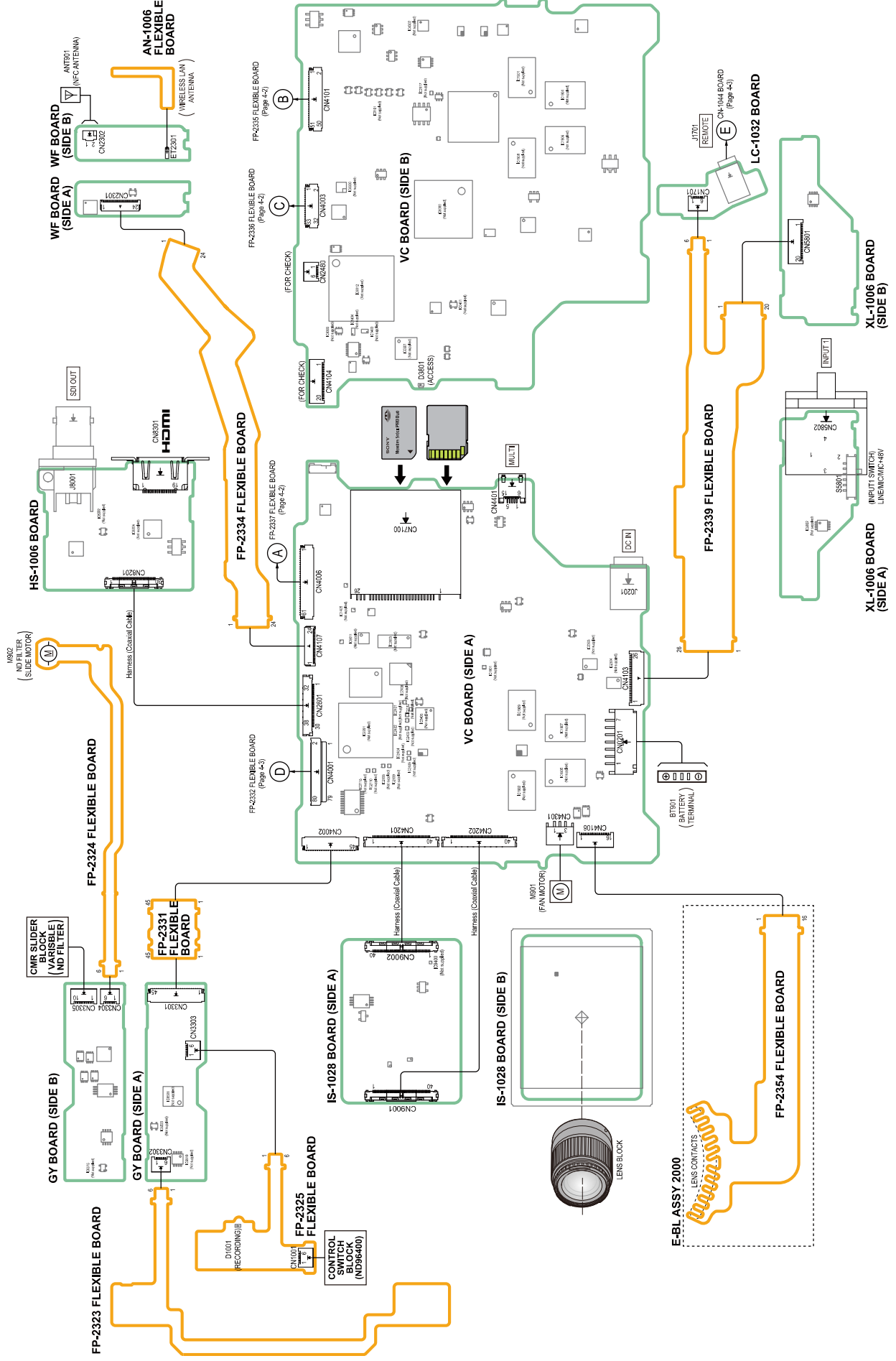





### Frame Wiring (3/3)

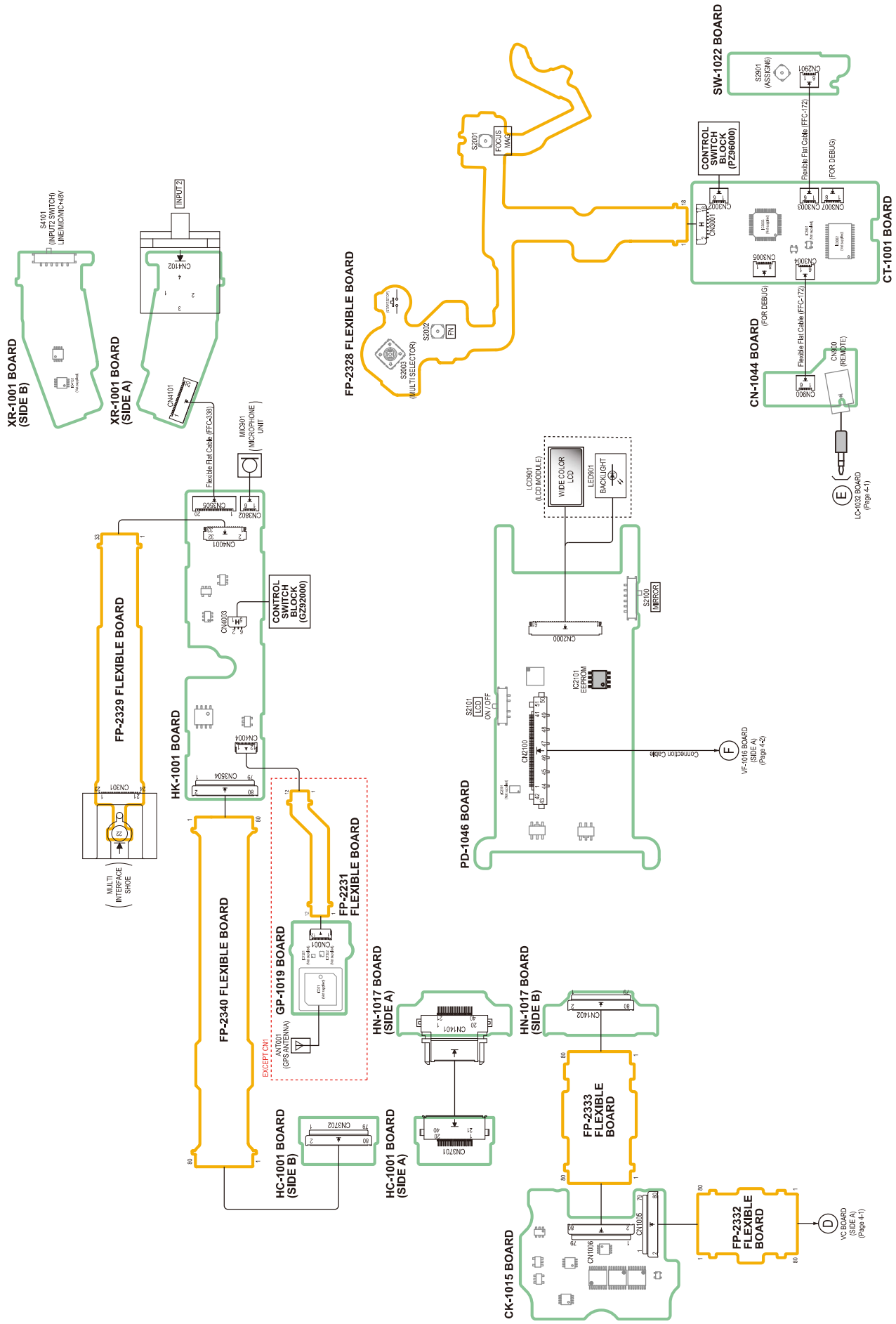

## Revision History

Date	History	Contents
2024. 5	1st Edition 9-932-900-01	—

PXW-FS5  
PXW-FS5K  
PXW-FS5M2  
PXW-FS5M2K E  
9-932-900-01

Sony Corporation

Printed in Japan  
2024. 5 08  
© 2024